

输出转速 output speed na r/min	输出转矩 output torque Ma N.m	传动比 Ratio i	径向载荷 Permissible overhung load outside Fa N	使用系数 service factor fb	机型号 Type	极数 Pole	重量 weight kg	输出转速 output speed na r/min	输出转矩 output torque Ma N.m	传动比 Ratio i	径向载荷 Permissible overhung load outside Fa N	使用系数 service factor fb	机型号 Type	极数 Pole	重量 weight kg
0.12kW								0.12kW							
0.08	11800	17550	79800	1.10	YK127R77	4	470	0.99	920	1388	18600	1.70	YK77R37	4	69
0.09	10700	16006	80400	1.20	YKF127R77	4	510	1.1	810	1218	19000	1.90	YKF77R37	4	77
0.11	8010	12440	81500	1.60	YKA127R77	4	440	1.3	710	1053	19200	2.2	YKA77R37	4	62
0.13	6920	10915	81800	1.90	YKAF127R77	4	480	1.5	620	924	19500	2.5	YKAF77R37	4	70
0.14	6320	9819	82000	2.1	YKAZ127R77			1.7	550	815	19600	2.8	YKAZ77R37		
0.16	5220	8443	82300	2.5				2.0	440	709	19800	3.5			
0.18	4820	7482	82300	2.7				2.2	385	622	19900	4.0			
0.10	9590	14311	65000	0.85	YK107R77	4	310	1.0	930	1351	9230	0.90	YK67R37	4	45
0.11	8060	12211	65000	1.00	YKF107R77	4	320	1.2	795	1171	10500	1.05	YKF67R37	4	51
0.13	6930	10677	65000	1.15	YKA107R77	4	280	1.3	695	1034	11300	1.20	YKA67R37	4	42
0.14	6280	9524	65000	1.25	YKAF107R77	4	305	1.5	585	903	12000	1.40	YKAF67R37	4	48
0.17	5410	8328	65000	1.50	YKAZ107R77			1.7	545	793	12200	1.50	YKAZ67R37		
0.19	4720	7270	65000	1.70				2.0	440	697	12700	1.85			
0.22	3760	6184	65000	2.1				2.2	390	613	12900	2.1			
0.24	3320	5662	65000	2.4				2.5	340	542	13000	2.4			
0.27	3020	5138	65000	2.7				2.9	315	471	13000	2.6			
0.32	2700	4359	65000	3.0				3.3	265	420	13000	3.1			
								3.8	235	361	13000	3.5			
0.17	5310	8054	39500	0.80	YK97R57	4	180	4.3	210	323	13000	3.9			
0.20	4350	6970	40000	1.00	YKF97R57	4	200	4.9	176	279	13000	4.7			
0.23	3890	6027	40000	1.10	YKA97R57	4	160	5.6	155	246	13000	5.3			
0.26	3560	5391	40000	1.20	YKAF97R57	4	185	6.3	134	217	13000	6.1			
0.30	2950	4669	40000	1.45	YKAZ97R57										
0.34	2640	4082	40000	1.65				1.5	585	906	7750	1.05	YK57R37	4	39
0.39	2320	3583	40000	1.85				1.7	525	806	8220	1.15	YKF57R37	4	44
0.44	2040	3108	40000	2.1				2.0	445	699	8690	1.35	YKA57R37	4	37
0.50	1720	2757	40000	2.5				2.2	390	615	8930	1.55	YKAF57R37	4	43
0.57	1580	2419	40000	2.7				2.5	340	544	9120	1.75	YKAZ57R37		
0.65	1370	2123	40000	3.2				2.9	310	473	9250	1.95			
0.74	1220	1856	40000	3.5				3.3	265	421	9420	2.3			
0.85	1000	1625	40000	4.3				3.8	235	362	9510	2.5			
0.96	860	1430	40000	5.0				4.3	210	319	9610	2.9			
1.1	830	1261	40000	5.2				4.9	176	280	9710	3.4			
1.2	725	1102	40000	5.9				5.6	155	246	9770	3.9			
								6.4	135	215	9830	4.4			
								7.2	122	192	9860	4.9			
0.26	3380	5240	26300	0.80	YK87R57	4	120	2.2	430	639	2520	0.95	YK47R37	4	33
0.30	2850	4562	27100	0.95	YKF87R57	4	130	2.5	370	552	6350	1.10	YKF47R37	4	36
0.34	2610	4037	27400	1.05	YKA87R57	4	105	2.8	315	495	6930	1.25	YKA47R37	4	32
0.38	2330	3609	27700	1.15	YKAF87R57	4	120	3.2	280	426	7240	1.45	YKAF47R37	4	35
0.44	1990	3107	28100	1.35	YKAZ87R57			3.7	235	375	7560	1.70	YKAZ47R37		
0.51	1700	2728	28300	1.60				4.2	215	327	7670	1.85			
0.58	1500	2371	28500	1.80				4.8	189	289	7830	2.1			
0.66	1380	2088	28600	1.95											
0.74	1220	1854	28700	2.2				4.0	235	346	4840	0.85	YK37R17	4	19
0.83	1090	1657	28700	2.5				4.5	200	304	5640	1.00	YKF37R17	4	21
0.97	930	1415	28800	2.9				5.2	182	267	5830	1.10	YKA37R17	4	19
1.1	800	1229	28900	3.4				5.9	157	234	6060	1.25	YKAF37R17	4	20
1.3	695	1078	28900	3.9				6.7	138	205	6220	1.45	YKAZ37R17		
1.5	585	951	29000	4.6				7.6	120	181	6330	1.65			
1.6	505	837	29000	5.4				8.6	105	160	6420	1.90			
1.9	435	726	29000	6.2				10	88	136	6500	2.3			
0.51	1790	2717	13400	0.85	YK77R37	4	69	6.2	184	144.79	13000	4.4	YK67	6	34
0.58	1510	2370	15700	1.05	YKF77R37	4	78						YKF67	6	40
0.67	1380	2050	16500	1.10	YKA77R37	4	62						YKA67	6	31
0.78	1180	1772	17500	1.30	YKAF77R37	4	70						YKAF67	6	31
0.91	1010	1514	18300	1.55	YKAZ77R37								YKAZ67	6	37

YYK系列 | 选型参数表
Selection table

输出转速 output speed na r/min	输出转矩 output torque Ma N.m	传动比 Ratio i	径向载荷 Permissible overhung load outpside Fa N	使用系数 service factor fb	机型号 Type	极数 Pole	重量 weight kg	输出转速 output speed na r/min	输出转矩 output torque Ma N.m	传动比 Ratio i	径向载荷 Permissible overhung load outpside Fa N	使用系数 service factor fb	机型号 Type	极数 Pole	重量 weight kg
0.12kW								0.18kW							
6.2	185	145.14	9680	3.2	YYK57	6	28	0.28	4960	4669	39900	0.85	YK97R57	4	180
7.3	158	123.85	9760	3.8	YK97R57	6	33	0.32	4390	4082	40000	1.00	YK97R57	4	200
8.3	138	108.29	9820	4.3	YYK457	6	26	0.37	3860	3583	40000	1.10	YK97R57	4	160
8.8	131	102.88	9840	4.6	YKAF57	6	32	0.42	3370	3108	40000	1.25	YKAF97R57	4	185
10	115	90.26	9880	5.2	YYKAZ57			0.48	2910	2757	40000	1.50	YKAZ97R57		
12	98	76.56	9930	6.2				0.55	2640	2419	40000	1.65			
								0.62	2290	2123	40000	1.90			
9.5	121	145.14	9870	5.0	YK57	4	28	0.71	2030	1856	40000	2.1			
11	103	123.85	9920	5.8	YK97R57	4	33	0.81	1710	1625	40000	2.5			
13	85	102.88	9960	7.0	YK457	4	26	0.92	1490	1430	40000	2.9			
15	75	90.26	9990	8.0	YKAF57	4	32	1.0	1380	1261	40000	3.1			
					YKAZ57	4	32	1.2	1210	1102	40000	3.6			
6.8	168	131.87	7930	2.4	YK47	6	22	1.4	1040	957	40000	4.1			
7.4	155	121.48	7990	2.6	YK97R47	6	26	1.5	930	855	40000	4.6			
8.6	133	104.37	8070	3.0	YK47	6	22	1.8	755	743	40000	5.7			
					YKAF47	6	24	2.0	675	652	40000	6.4			
					YKAZ47	6	24								
10	110	131.87	8140	3.7	YK47	4	22	0.42	3330	3107	26400	0.80	YK87R57	4	120
11	101	121.48	8170	4.0	YK97R47	4	26	0.48	2880	2728	27100	0.95	YK87R57	4	130
					YKAF47	4	22	0.56	2520	2371	27500	1.05	YKAF87R57	4	105
					YKAZ47	4	24						YKAZ87R57	4	120
8.5	136	106.38	6230	1.50	YK37	6	16	0.63	2290	2088	27800	1.20	YK87R57	4	120
9.2	125	97.81	6300	1.60	YK97R37	6	18	0.71	2030	1854	28000	1.35	YK87R57	4	125
11	107	83.69	6410	1.90	YK47	6	16	0.80	1820	1657	28200	1.50	YK87R57	4	105
12	92	72.54	6480	2.2	YKAF37	6	17	0.93	1540	1415	28400	1.75	YKAF87R57	4	120
					YKAZ37	6	17	1.1	1340	1229	28600	2.0	YKAZ87R57		
13	88	106.38	6500	2.3	YK37	4	16	1.2	1160	1078	28700	2.3			
14	81	97.81	6530	2.5	YK97R37	4	18	1.4	1000	951	28800	2.7			
16	70	83.69	6570	2.9	YK47	4	16	1.6	870	837	28800	3.1			
19	60	72.54	6600	3.3	YKAF37	4	17	1.8	755	726	28900	3.6			
20	56	67.80	6610	3.5	YKAZ37										
24	49	58.60	6430	4.1				0.87	1670	1514	14500	0.95	YK77R37	4	69
28	41	49.79	6130	4.8				0.95	1530	1388	15500	1.00	YK77R37	4	77
31	37	44.46	5930	5.4				1.1	1340	1218	16700	1.15	YKAF77R37	4	62
36	32	37.97	5660	6.3				1.2	1170	1053	17600	1.35	YKAF77R37	4	70
39	30	35.57	5550	6.8				1.4	1030	924	18200	1.50	YKAZ77R37		
46	25	29.96	5270	8.0				1.6	910	815	18700	1.70			
48	24	28.83	5210	8.4				1.9	750	709	19100	2.1			
55	21	24.99	4980	9.6				2.1	655	622	19400	2.4			
59	19	23.36	4880	10				2.4	590	552	19500	2.6			
68	17	20.19	4660	11				2.7	515	485	19700	3.0			
80	14	17.15	4430	13				3.1	455	428	19800	3.4			
90	13	15.31	4280	14				3.6	400	367	19900	3.9			
105	11	13.08	4070	15											
114	10	12.14	3970	16				1.5	980	903	5660	0.85	YK67R37	4	45
0.09	16300	14975	73200	0.80	YK127R77	4	470	1.7	890	793	9620	0.90	YK67R37	4	51
0.11	13400	12440	79000	0.95	YK97R77	4	510	1.9	745	697	10900	1.10	YKAF67R37	4	42
0.12	11600	10915	79900	1.10	YK47R77	4	440	2.2	655	613	11600	1.25	YKAF67R37	4	48
0.13	10500	9819	80400	1.25	YKAF127R77	4	480	2.4	580	542	12000	1.40	YKAZ67R37		
0.16	8850	8443	81100	1.45	YKAZ127R77			2.8	520	471	12300	1.60			
0.18	8040	7482	81400	1.60				3.2	445	420	12600	1.85			
0.20	6990	6565	81800	1.85				3.7	395	361	12800	2.1			
0.23	5940	5804	82100	2.2				4.1	350	323	13000	2.3			
0.26	5220	5027	82300	2.5				4.7	295	279	13000	2.8			
0.30	4530	4423	82400	2.9											
0.34	3960	3889	82500	3.3				2.2	660	615	5580	0.90	YK57R37	4	39
0.40	3310	3311	82600	3.9				2.4	580	544	7800	1.05	YK57R37	4	44
								2.8	515	473	8300	1.15	YKAF57R37	4	37
0.16	8990	8328	65000	0.90	YK107R77	4	310	3.1	450	421	8670	1.35	YKAF57R37	4	43
0.18	7850	7270	65000	1.00	YK97R77	4	320	3.6	395	362	8900	1.50	YKAZ57R37		
0.21	6420	6184	65000	1.25	YK47R77	4	280	4.1	350	319	9100	1.75			
0.23	5760	5662	65000	1.40	YKAF107R77	4	305	4.7	300	280	9290	2.0			
0.26	5230	5138	65000	1.55	YKAZ107R77			5.4	260	246	9420	2.3			
0.30	4570	4359	65000	1.75				6.1	230	215	9540	2.6			
0.35	4000	3810	65000	2.0				6.9	205	192	9610	2.9			
0.39	3440	3358	65000	2.3				7.9	178	166	9700	3.4			
0.44	3090	2977	65000	2.6											
0.51	2700	2599	65000	3.0											
0.58	2340	2286	65000	3.4											

输出转速 output speed n _a r/min	输出转矩 output torque Ma N·m	传动比 Ratio i	径向载荷 Permissible overhung load outputside F _a N	使用系数 service factor fb	机型号 Type	极数 Pole	重量 weight kg	输出转速 output speed n _a r/min	输出转矩 output torque Ma N·m	传动比 Ratio i	径向载荷 Permissible overhung load outputside F _a N	使用系数 service factor fb	机型号 Type	极数 Pole	重量 weight kg
0.18kW								0.18kW							
3.5	400	375	5930	1.00	YYK47R37	4	33	77	22	17.15	4430	8.1	YYK37	4	16
4.0	360	327	6440	1.10	YYKF47R37	4	36	86	20	15.31	4280	8.8	YYKF37	4	18
4.6	315	289	6920	1.25	YYKA47R37	4	32	101	17	13.08	4080	9.7	YYKA37	4	16
5.2	275	256	7290	1.45	YYKAF47R37	4	35	109	16	12.14	3980	10	YYKAF37	4	17
5.9	245	225	7500	1.65	YYKAZ47R37			126	14	10.49	3810	12	YYKAZ37		
6.7	210	198	7710	1.90				148	12	8.91	3620	14			
7.7	183	171	7860	2.2				166	10	7.96	3490	15			
8.6	164	153	7950	2.4				0.25kW							
10	142	131	8040	2.8				0.13	15300	9819	75300	0.85	YYK127R77	4	470
								0.15	13000	8443	79200	1.00	YYKF127R77	4	510
6.4	225	205	5300	0.90	YYK37R17	4	19	0.17	11700	7482	79900	1.10	YYKA127R77	4	440
7.3	199	181	5650	1.00	YYKF37R17	4	21	0.20	10200	6565	80600	1.30	YYKAF127R77	4	480
8.2	175	160	5900	1.15	YYKA37R17	4	19	0.22	8770	5804	81200	1.50	YYKAZ127R77		
9.7	148	136	6140	1.35	YYKAF37R17	4	20	0.26	7670	5027	81600	1.70			
10	140	127	6200	1.45	YYKAZ37R17			0.29	6680	4423	81900	1.95			
								0.33	5850	3889	82100	2.2			
6.0	285	144.79	13000	2.9	YYK67	6	35	0.39	4930	3311	82300	2.6			
7.0	245	123.54	13000	3.4	YYKP67	6	40								
8.1	215	108.03	13000	3.8	YYKA67	6	32	0.21	9440	6184	65000	0.85	YYK107R77	4	310
8.5	205	102.62	13000	4.0	YYKAZ67	6	38	0.23	8520	5662	65000	0.95	YYKF107R77	4	320
								0.25	7730	5138	65000	1.05	YYKA107R77	4	285
9.1	189	144.79	13000	4.3	YYK67	4	34	0.30	6700	4359	65000	1.20	YYKAF107R77	4	305
11	161	123.54	13000	5.1	YYKP67	4	40	0.34	5850	3810	65000	1.35	YYKAZ107R77		
12	141	108.03	13000	5.8	YYKA67	4	31	0.39	5070	3358	65000	1.60			
								0.44	4540	2977	65000	1.75			
								0.50	3970	2599	65000	2.0			
6.0	285	145.14	9340	2.1	YYK57	6	29	0.57	3450	2286	65000	2.3			
7.0	245	123.85	9480	2.5	YYKF57	6	34	0.67	2930	1939	65000	2.7			
8.0	215	108.29	9590	2.8	YYKA57	6	27	0.76	2640	1713	65000	3.0			
8.5	205	102.88	9620	3.0	YYKAF57	6	32	0.84	2390	1554	65000	3.3			
9.6	178	90.26	9700	3.4	YYKAZ57			0.97	2060	1336	65000	3.9			
9.1	189	145.14	9670	3.2	YYK57	4	28	0.42	4890	3108	40000	0.90	YYK97R77	4	180
11	161	123.85	9750	3.7	YYKF57	4	33	0.47	4250	2757	40000	1.00	YYKF97R77	4	200
12	141	108.29	9810	4.3	YYKA57	4	26	0.54	3840	2419	40000	1.10	YYKA97R77	4	160
13	134	102.88	9830	4.5	YYKAF57	4	32	0.61	3340	2123	40000	1.30	YYKAF97R77	4	185
15	118	90.26	9880	5.1	YYKAZ57			0.70	2950	1856	40000	1.45	YYKAZ97R77		
17	100	76.56	9920	6.0				0.80	2520	1625	40000	1.70			
								0.91	2190	1430	40000	1.95			
6.6	260	131.87	7380	1.55	YYK47	6	23	1.0	2010	1261	40000	2.1			
7.2	240	121.48	7530	1.65	YYKF47	6	26	1.2	1750	1102	40000	2.5			
8.3	205	104.37	7740	1.95	YYKA47	6	22	1.4	1520	957	40000	2.8			
9.6	180	90.86	7880	2.2	YYKAF47	6	25	1.5	1360	855	40000	3.2			
10	168	85.12	7930	2.4	YYKAZ47										
10	172	131.87	7910	2.3	YYK47	4	22	0.62	3320	2088	26400	0.80	YYK87R57	4	120
11	158	121.48	7970	2.5	YYKF47	4	26	0.70	2950	1854	27000	0.90	YYKF87R57	4	125
13	136	104.37	8060	2.9	YYKA47	4	22	0.78	2640	1657	27400	1.00	YYKA87R57	4	105
15	118	90.86	8120	3.4	YYKAF47	4	24	0.92	2250	1415	27800	1.20	YYKAF87R57	4	120
16	111	85.12	8140	3.6	YYKAZ47			1.1	1950	1229	28100	1.40	YYKAZ87R57		
								1.2	1700	1078	28300	1.60			
								1.4	1470	951	28500	1.85			
8.2	210	106.38	5520	0.95	YYK37	6	17	1.5	1280	837	28600	2.1			
8.9	193	97.81	5710	1.05	YYKF37	6	19	1.8	1110	726	28700	2.4			
10	165	83.69	5900	1.20	YYKA37	6	16	2.0	990	638	28800	2.7			
12	143	72.54	6170	1.40	YYKAF37	6	18								
12	139	106.38	6210	1.45	YYK37	4	16	1.2	1690	1053	14300	0.90	YYK77R37	4	70
14	127	97.81	6280	1.55	YYKF37	4	18	1.4	1480	924	15800	1.05	YYKF77R37	4	78
16	109	83.69	6400	1.85	YYKA37	4	16	1.6	1310	815	16900	1.20	YYKA77R37	4	62
18	95	72.54	6470	2.1	YYKAF37	4	17	1.8	1100	709	17900	1.40	YYKAF77R37	4	70
19	88	67.80	6500	2.3	YYKAZ37			2.1	960	622	18400	1.60	YYKAZ77R37		
23	76	58.60	6280	2.6				2.3	860	552	18800	1.80			
27	65	49.79	6010	3.1				2.7	755	485	19100	2.0			
30	58	44.46	5830	3.5				3.0	665	428	19300	2.3			
35	49	37.97	5580	4.1				3.5	580	367	19500	2.7			
37	46	35.57	5480	4.3				4.0	515	328	19700	3.0			
44	39	29.96	5220	5.1				4.5	460	290	19800	3.4			
46	38	28.83	5160	5.3				5.2	395	252	19900	3.9			
53	33	24.99	4950	6.2				5.9	345	221	19900	4.5			
57	30	23.36	4850	6.4				6.7	305	195	20000	5.1			
65	26	20.19	4650	7.0				7.4	270	175	20000	5.7			

YYK系列 | 选型参数表
Selection table

输出转速 output speed na r/min	输出转矩 output torque Ma N.m	传动比 Ratio i	径向载荷 Permissible overhung load outside Fa N	使用系数 service factor fb	机型号 Type	极数 Pole	重量 weight kg	输出转速 output speed na r/min	输出转矩 output torque Ma N.m	传动比 Ratio i	径向载荷 Permissible overhung load outside Fa N	使用系数 service factor fb	机型号 Type	极数 Pole	重量 weight kg
0.25kW								0.25kW							
2.1	960	613	7350	0.85	YYK67R37	4	46	9.9	240	131.87	7510	1.65	YYK47	4	23
2.4	850	542	10100	0.95	YYKF67R37	4	51	11	225	121.48	7640	1.80	YYKF47	4	26
2.8	755	471	10900	1.10	YYK467R37	4	43	12	192	104.37	7820	2.1	YYKA47	4	22
3.1	655	420	11600	1.25	YYKAF67R37	4	49	14	167	90.86	7930	2.4	YYKAF47	4	25
3.6	575	361	12000	1.45	YYKAZ67R37			15	156	85.12	7980	2.6	YYKAZ47		
4.0	510	323	12400	1.60											
4.7	435	279	12700	1.90				11	225	83.69	5300	0.90	YYK37	6	18
5.3	385	246	12900	2.1				12	197	72.54	5680	1.00	YYKF37	6	20
6.0	335	217	13000	2.4				13	184	67.80	5810	1.10	YYKA37	6	17
								15	159	58.60	6050	1.25	YYKAF37	6	19
								18	135	49.79	6230	1.50	YYKAZ37		
3.1	655	421	5750	0.90	YYK57R37	4	40								
3.6	575	362	7840	1.05	YYKF57R37	4	45	12	195	106.38	5690	1.00	YYK37	4	17
4.1	505	319	8380	1.20	YYKA57R37	4	38	13	180	97.81	5860	1.10	YYKF37	4	19
4.7	435	280	8720	1.35	YYKAF57R37	4	43	16	154	83.69	6090	1.30	YYKA37	4	16
5.3	385	246	8950	1.55	YYKAZ57R37			18	133	72.54	6250	1.50	YYKAF37	4	18
6.1	335	215	9150	1.80				19	125	67.80	6230	1.60	YYKAZ37		
6.8	300	192	9280	2.0				22	108	58.60	6030	1.85			
7.8	260	166	9430	2.3				26	91	49.79	5810	2.2			
9.0	225	145	9550	2.7				29	82	44.46	5650	2.5			
10	205	129	9620	2.9				34	70	37.97	5430	2.9			
12	173	111	9720	3.5				37	65	35.57	5340	3.1			
13	152	97	9780	4.0				43	55	29.96	5100	3.6			
								45	53	28.83	5050	3.8			
4.4	540	154.02	19600	2.9	YYK77	8	65	52	46	24.99	4860	4.4			
5.0	475	135.28	19700	3.3	YYKF77	8	73	56	43	23.36	4770	4.6			
5.3	450	128.52	19800	3.4	YYKA77	8	58	64	37	20.19	4580	5.0			
6.0	400	113.56	19900	3.9	YYKAF77	8	65	76	32	17.15	4370	5.7			
								85	28	15.31	4230	6.2			
4.6	520	192.18	19700	2.8	YYK77	6	61	99	24	13.08	4030	6.9			
4.9	485	179.37	19700	3.0	YYKF77	6	69	107	22	12.14	3940	7.2			
5.7	420	154.02	19800	3.7	YYKA77	6	54	124	19	10.49	3780	8.3			
6.5	365	135.28	19900	4.2	YYKAF77	6	61	146	16	8.91	3590	9.8			
								163	15	7.96	3470	11			
5.5	435	123.54	12700	1.90	YYK67	8	39	191	13	6.80	3310	12			
6.3	380	108.03	12900	2.2	YYKF67	8	45	204	12	6.37	3240	12			
6.6	360	102.62	12900	2.3	YYKA67	8	37								
7.6	315	90.04	13000	2.6	YYKAF67	8	42								
6.1	395	144.79	12800	2.1	YYK67	6	36	0.18	16600	7482	72600	0.80	YYK127R77	4	470
7.1	335	123.54	13000	2.5	YYKF67	6	42	0.21	14500	6565	76900	0.90	YYKF127R77	4	510
8.1	295	108.03	13000	2.8	YYKA67	6	34	0.24	12600	5804	79400	1.05	YYKA127R77	4	445
8.6	280	102.62	13000	3.0	YYKAF67	6	39	0.27	11000	5027	80200	1.20	YYKAF127R77	4	480
								0.31	9610	4423	80800	1.35	YYKAZ127R77		
								0.35	8430	3889	81300	1.55			
9.0	265	144.79	13000	3.1	YYK67	4	35	0.42	7120	3311	81700	1.85			
11	225	123.54	13000	3.6	YYKF67	4	40	0.72	4230	1926	82500	3.1			
12	198	108.03	13000	4.1	YYKA67	4	32	0.79	3860	1757	82500	3.4			
13	189	102.62	13000	4.3	YYKAF67	4	38	0.90	3360	1541	82600	3.9			
6.1	395	145.14	8910	1.50	YYK57	6	30	0.36	8380	3810	65000	0.95	YYK107R77	4	310
7.1	335	123.85	9150	1.80	YYKF57	6	35	0.41	7300	3358	65000	1.10	YYKF107R77	4	325
8.1	295	108.29	9310	2.0	YYKA57	6	28	0.46	6510	2977	65000	1.25	YYKA107R77	4	285
8.6	280	102.88	9360	2.2	YYKAF57	6	34	0.53	5690	2599	65000	1.40	YYKAF107R77	4	305
9.8	245	90.26	9480	2.5	YYKAZ57			0.60	4970	2286	65000	1.60	YYKAZ107R77		
11	210	76.56	9610	2.9				0.71	4210	1939	65000	1.90			
								0.81	3790	1713	65000	2.1			
9.0	265	145.14	9410	2.2	YYK57	4	29	0.89	3440	1554	65000	2.3			
11	225	123.85	9540	2.6	YYKF57	4	34	1.0	2950	1336	65000	2.7			
12	199	108.29	9640	3.0	YYKA57	4	27	1.2	2580	1166	65000	3.1			
13	189	102.88	9670	3.2	YYKAF57	4	32								
14	166	90.26	9740	3.6	YYKAZ57			0.65	4770	2123	40000	0.90	YYK97R57	4	180
17	141	76.56	9810	4.3				0.74	4200	1856	40000	1.00	YYKF97R57	4	200
								0.85	3610	1625	40000	1.20	YYKA97R57	4	160
6.7	360	131.87	6470	1.10	YYK47	6	25	0.96	3160	1430	40000	1.35	YYKAF97R57	4	185
7.2	330	121.48	6780	1.20	YYKF47	6	28	1.1	2850	1261	40000	1.50	YYKAZ97R57		
8.4	285	104.37	7210	1.40	YYKA47	6	24	1.2	2490	1102	40000	1.70			
9.7	245	90.86	7480	1.60	YYKAF47	6	27	1.4	2160	957	40000	2.0			
10	230	85.12	7590	1.75	YYKAZ47			1.6	1930	855	40000	2.2			
								1.9	1620	743	40000	2.7			
								2.1	1430	652	40000	3.0			
								2.4	1280	573	40000	3.4			

输出转速 output speed n _a r/min	输出转矩 output torque M _a N.m	传动比 Ratio i	径向载荷 Permissible overhung load outputside F _a N	使用系数 service factor f _b	机型号 Type	极数 Pole	重量 weight kg	输出转速 output speed n _a r/min	输出转矩 output torque M _a N.m	传动比 Ratio i	径向载荷 Permissible overhung load outputside F _a N	使用系数 service factor f _b	机型号 Type	极数 Pole	重量 weight kg
0.37kW								0.37kW							
0.97	3200	1415	26600	0.85	YYK87R57	4	120	7.3	485	123.54	12500	1.70	YYK67	6	38
1.1	2770	1229	27200	0.95	YYKF87R57	4	130	8.3	425	108.03	12700	1.95	YYKF67	6	44
1.3	2420	1078	27600	1.10	YYKA87R57	4	110	8.8	405	102.62	12800	2.0	YYKAF67	6	36
1.5	2110	951	27900	1.30	YYKAF87R57	4	120	10	355	90.04	13000	2.3	YYKAZ67	6	41
1.6	1850	837	28200	1.45	YYKAZ87R57										
1.9	1600	726	28400	1.70				9.5	370	144.79	12900	2.2	YYK67	4	36
2.2	1420	638	28500	1.90				11	315	123.54	13000	2.6	YYKF67	4	42
2.5	1240	562	28600	2.2				13	275	108.03	13000	3.0	YYKA67	4	34
2.9	1040	474	28800	2.6				15	230	90.04	13000	3.6	YYKAF67	4	39
3.2	940	426	28800	2.9				18	196	76.37	13000	4.2	YYKAZ67		
3.7	810	373	28900	3.3											
1.7	1860	815	10600	0.85	YYK77R37	4	71	7.3	485	123.85	8490	1.25	YYK57	6	32
2.0	1580	709	15200	1.00	YYKF77R37	4	79	8.3	425	108.29	8770	1.40	YYKF57	6	37
2.2	1380	622	16500	1.10	YYKA77R37	4	63	8.8	405	102.88	8870	1.50	YYKA57	6	30
2.5	1230	552	17300	1.25	YYKAF77R37	4	71	10	355	90.26	9070	1.70	YYKAF57	6	36
2.8	1080	485	18000	1.45	YYKAZ77R37			12	300	76.56	9280	2.0	YYKAZ57		
3.2	950	428	18500	1.60				13	270	69.12	9390	2.2			
3.8	830	367	18900	1.85				9.5	370	145.14	9000	1.60	YYK57	4	30
4.2	735	328	19200	2.1				11	315	123.85	9220	1.90	YYKF57	4	35
4.8	655	290	19400	2.4				13	275	108.29	9370	2.2	YYKA57	4	28
5.5	565	252	19600	2.8				15	230	90.26	9530	2.6	YYKAF57	4	34
6.2	495	221	19700	3.1				18	196	76.56	9650	3.1	YYKAZ57		
7.1	435	195	19800	3.5				20	177	69.12	9700	3.4			
7.9	390	175	19900	4.0											
9.0	340	154	19900	4.5				8.6	410	104.37	5490	1.00	YYK47	6	27
								9.9	355	90.86	6480	1.10	YYKF47	6	30
3.3	940	420	9000	0.90	YYK67R37	4	47	11	335	85.12	6730	1.20	YYKA47	6	26
3.8	820	361	10300	1.00	YYKF67R37	4	52	12	295	75.20	7100	1.35	YYKAZ47	6	29
4.3	725	323	11100	1.15	YYKA67R37	4	44								
4.9	625	279	11800	1.30	YYKAF67R37	4	50	10	340	131.87	6690	1.20	YYK47	4	25
5.6	550	246	12200	1.50	YYKAZ67R37			11	310	121.48	6960	1.30	YYKF47	4	28
6.3	485	217	12500	1.70				13	265	104.37	7330	1.50	YYKA47	4	24
7.2	430	191	12700	1.90				15	235	90.86	7580	1.70	YYKAF47	4	27
8.3	370	166	12900	2.2				16	220	85.12	7670	1.85	YYKAZ47		
9.6	320	144	13000	2.5				18	193	75.20	7810	2.1			
11	275	122	13000	3.0				20	179	69.84	7880	2.2			
								22	162	63.30	7960	2.5			
4.9	625	280	7430	0.95	YYK57R37	4	41	14	250	97.81	2520	0.80	YYK37	4	18
5.6	550	246	8040	1.10	YYKF57R37	4	45	16	215	83.69	5470	0.95	YYKF37	4	20
6.4	480	215	8520	1.25	YYKA57R37	4	39	19	186	72.54	5690	1.10	YYKA37	4	17
7.2	430	192	8750	1.40	YYKAF57R37	4	44	20	174	67.80	5630	1.15	YYKAF37	4	19
8.3	370	166	9000	1.60	YYKAZ57R37			24	150	58.60	5510	1.35	YYKAZ37		
9.6	325	145	9200	1.85				28	128	49.79	5350	1.55			
11	290	129	9320	2.1				31	114	44.46	5230	1.75			
12	245	111	9480	2.4				36	97	37.97	5060	2.1			
14	215	97	9580	2.8				39	91	35.57	4990	2.2			
								46	77	29.96	4800	2.6			
3.9	910	174.19	28800	3.0	YYK87	8	105	48	74	28.83	4750	2.7			
4.1	850	164.34	28900	3.2	YYKF87	8	115	55	64	24.99	4590	3.1			
4.6	765	147.32	28900	3.5	YYKA87	8	93	59	60	23.36	4510	3.3			
					YYKAF87	8	105	68	52	20.19	4350	3.6			
4.6	775	197.37	28900	3.5	YYKAZ87	6	99	80	44	17.15	4160	4.1			
5.2	685	174.19	28900	4.0	YYK87	6	110	90	39	15.31	4040	4.5			
					YYKF87	6	86	105	34	13.08	3860	4.9			
					YYKA87	6	100	114	31	12.14	3780	5.1			
5.0	705	135.28	19300	2.2	YYKAZ87	6	70	132	27	10.49	3630	5.9			
5.3	670	128.52	19300	2.3	YYK77	8	78	155	23	8.91	3460	7.0			
6.0	590	113.56	19500	2.6	YYKF77	8	63	173	20	7.96	3350	7.6			
7.0	505	97.05	19700	3.1	YYKA77	8	70	203	17	6.80	3190	8.6			
					YYKAF77	8	70	217	16	6.37	3130	8.9			
					YYKAZ77	8	70	257	14	5.36	2970	10			
5.8	605	154.02	19500	2.6	YYK77	6	63	0.55kW							
6.7	530	135.28	19600	2.9	YYKF77	6	71	0.08	55900	16978	179800	0.90	YYK187R97	4	1760
7.0	505	128.52	19700	3.1	YYKA77	6	56	0.10	46500	14272	190000	1.10			
7.9	445	113.56	19800	3.5	YYKAF77	6	63	0.12	37400	11647	190000	1.35	YYKA187R97	4	1760
					YYKAZ77	6	63	0.19	23900	7343	190000	2.1			
7.2	490	192.18	19700	3.0	YYK77	4	61	0.12	38400	11573	150000	0.85	YYK167R97	4	1180
7.7	460	179.37	19800	3.2	YYKF77	4	69	0.13	33800	10264	150000	0.95			
9.0	395	154.02	19900	3.9	YYKA77	4	54	0.16	28100	8628	150000	1.15	YYKA167R97	4	1180
					YYKAF77	4	61	0.21	21400	6562	150000	1.50			
6.3	560	108.03	12100	1.45	YYKAZ77	4	44	0.25	17200	5355	150000	1.85			
6.6	535	102.62	12300	1.55	YYK87	8	44	0.33	13200	4079	150 000	2.4			
7.6	470	90.04	12600	1.75	YYKF87	8	50								
					YYKA87	8	42								
					YYKAF87	8	47								
					YYKAZ87	8	47								

YYK系列 | 选型参数表
Selection table

105

输出转速 output speed na r/min	输出转矩 output torque Ma N.m	传动比 Ratio i	径向载荷 Permissible overhung load outpside Fa N	使用系数 service factor fb	机型号 Type	极数 Pole	重量 weight kg	输出转速 output speed na r/min	输出转矩 output torque Ma N.m	传动比 Ratio i	径向载荷 Permissible overhung load outpside Fa N	使用系数 service factor fb	机型号 Type	极数 Pole	重量 weight kg
0.55kW								0.55kW							
0.20	22400	6881	109700	0.80	YK157R97	4	790	4.9	960	279	7360	0.85	YK67R37	4	49
0.23	19300	5931	111500	0.95	YKF157R97	4	870	5.5	840	246	10100	0.95	YKF67R37	4	54
0.34	13000	3979	114400	1.40	YKAF157R97	4	750	6.2	745	217	10900	1.10	YKA67R37	4	46
0.45	9940	3051	115300	1.80	YKAZ157R97	4	810	7.1	660	191	11500	1.25	YKAF67R37	4	52
								8.2	570	166	12100	1.45	YKAZ67R37		
0.31	14900	4423	76200	0.85	YK127R77	4	475	9.4	495	144	12400	1.65			
0.35	13000	3889	79200	1.00	YKF127R77	4	520	11	420	122	12700	1.95			
0.41	11100	3311	80200	1.20	YKA127R77	4	445								
0.45	10000	3009	80700	1.30	YKAF127R77	4	480	7.1	660	192	5180	0.90	YK57R37	4	43
0.52	8630	2607	81200	1.50	YKAZ127R77			8.2	575	166	7850	1.05	YKF57R37	4	47
0.71	6560	1926	81900	2.0				9.4	495	145	8430	1.20	YKA57R37	4	41
0.77	5980	1757	82100	2.2				11	445	129	8680	1.35	YKAF57R37	4	46
0.88	5220	1541	82300	2.5				12	380	111	8970	1.60	YKAZ57R37		
1.0	4570	1342	82400	2.8				14	335	97	9150	1.80			
1.2	3990	1177	82500	3.3				3.9	1350	174.19	28600	2.0	YK87	8	105
1.3	3490	1025	82600	3.7				4.1	1270	164.34	28600	2.1	YKF87	8	115
								4.6	1140	147.32	28700	2.4	YKA87	8	94
0.46	10100	2977	65000	0.80	YK107R77	4	315						YKAF87	8	110
0.52	8770	2599	65000	0.90	YKF107R77	4	325	4.6	1150	197.37	28700	2.3	YKAZ87	8	100
0.59	7690	2286	65000	1.05	YKA107R77	4	285	5.2	1020	174.19	28800	2.7	YK87	6	100
0.70	6520	1939	65000	1.25	YKAF107R77	4	310	5.5	960	164.34	28800	2.8	YKF87	6	110
0.79	5850	1713	65000	1.35	YKAZ107R77			6.1	860	147.32	28900	3.1	YKA87	6	88
0.87	5310	1554	65000	1.50									YKAF87	6	100
1.0	4570	1336	65000	1.75				5.0	1040	135.28	18100	1.50	YKAZ87	6	100
1.2	3990	1166	65000	2.0				5.3	990	128.52	18300	1.55	YK77	8	71
1.3	3450	1030	65000	2.3				6.0	880	113.56	18700	1.75	YKF77	8	79
1.5	3000	904	65000	2.7				7.0	750	97.05	19100	2.1	YKA77	8	64
1.7	2700	793	65000	3.0									YKAF77	8	71
2.0	2360	696	65000	3.4				5.8	900	154.02	18700	1.70	YK77	6	65
2.2	2050	615	65000	3.9				6.7	790	135.28	19000	1.95	YKF77	6	73
								7.0	750	128.52	19100	2.1	YKA77	6	58
0.95	4880	1430	40000	0.90	YK97R57	4	180	7.9	665	113.56	19400	2.3	YKAF77	6	65
1.1	4380	1261	40000	1.00	YKF97R57	4	205						YKAZ77	6	65
1.2	3820	1102	40000	1.15	YKA97R57	4	165	8.8	595	154.02	19500	2.6	YK77	4	63
1.4	3320	957	40000	1.30	YKAF97R57	4	190	10	520	135.28	19700	3.0	YKF77	4	71
1.6	2960	855	40000	1.45	YKAZ97R57			11	495	128.52	19700	3.1	YKA77	4	56
1.8	2520	743	40000	1.70				12	440	113.56	19800	3.5	YKAF77	4	63
2.1	2220	652	40000	1.95				14	375	97.05	19900	4.1	YKAZ77	4	63
2.4	1970	573	40000	2.2											
2.7	1700	504	40000	2.5				7.3	720	123.54	11100	1.15	YK77	6	39
3.1	1470	437	40000	2.9				8.3	630	108.03	11700	1.30	YKF77	6	45
3.6	1300	382	40000	3.3				8.8	600	102.62	11900	1.35	YKA77	6	36
4.5	1040	305	40000	4.1				10	525	90.04	12300	1.55	YKAF77	6	41
								12	445	76.37	12600	1.85	YKAZ77	6	41
1.4	3260	951	26500	0.85	YK87R57	4	120	11	475	123.54	12500	1.70	YK67	4	39
1.6	2860	837	27100	0.95	YKF87R57	4	130	13	415	108.03	12800	1.95	YKF67	4	44
1.9	2480	726	27600	1.10	YKA87R57	4	110	15	350	90.04	13000	2.4	YKA67	4	36
2.1	2190	638	27900	1.25	YKAF87R57	4	125	18	295	76.37	13000	2.8	YKAF67	4	41
2.4	1920	562	28100	1.40	YKAZ87R57								YKAZ67	4	41
2.9	1620	474	28400	1.65				8.3	630	108.29	7360	0.95	YK57	6	33
3.2	1450	426	28500	1.85				8.8	600	102.88	7630	1.00	YKF57	6	38
3.7	1260	373	28600	2.1				10	525	90.26	8220	1.15	YKA57	6	31
4.1	1110	330	28700	2.4				12	445	76.56	8670	1.35	YKAF57	6	37
4.6	990	294	28800	2.7				13	405	69.12	8870	1.50	YKAZ57		
5.4	850	250	28900	3.2				15	355	60.81	9070	1.70			
5.8	800	236	28900	3.4				16	335	57.42	9150	1.80			
6.8	680	201	28900	4.0											
								11	480	123.85	8520	1.25	YK57	4	32
2.5	1900	552	5780	0.80	YK77R37	4	73	13	420	108.29	8800	1.45	YKF57	4	37
2.8	1670	485	14500	0.95	YKF77R37	4	81	15	350	90.26	9100	1.70	YKA57	4	30
3.2	1470	428	15900	1.05	YKA77R37	4	65	18	295	76.56	9300	2.0	YKAF57	4	36
3.7	1270	367	17100	1.20	YKAF77R37	4	73	20	265	69.12	9410	2.2	YKAZ57		
4.2	1130	328	17800	1.35	YKAZ77R37			22	235	60.81	9520	2.6			
4.7	1000	290	18300	1.55				24	220	57.42	9560	2.7			
5.4	870	252	18800	1.80											
6.2	760	221	19100	2.0				13	405	104.37	5880	1.00	YK47	4	27
7.0	670	195	19300	2.3				15	350	90.86	6550	1.15	YKF47	4	30
7.8	600	175	19500	2.6				16	330	85.12	6790	1.20	YKA47	4	26
8.2	530	154	19600	2.9				18	290	75.20	7150	1.40	YKAF47	4	29
								19	270	69.84	7310	1.50	YKAZ47		

输出转速 output speed na r/min	输出转矩 output torque Ma N.m	传动比 Ratio i	径向载荷 Permissible overhung load outputside Fa N	使用系数 service factor fb	机型号 Type	极数 Pole	重量 weight kg	输出转速 output speed na r/min	输出转矩 output torque Ma N.m	传动比 Ratio i	径向载荷 Permissible overhung load outputside Fa N	使用系数 service factor fb	机型号 Type	极数 Pole	重量 weight kg
0.55kW								0.75kW							
21	245	63.30	7500	1.65	YYK47	4	27	1.2	5180	1102	39700	0.85	YYK97R57	4	185
24	220	56.83	7660	1.80	YYKF47	4	30	1.4	4490	957	40000	0.95	YYKF97R57	4	205
28	189	48.95	7830	2.1	YYKA47	4	26	1.6	4020	855	40000	1.05	YYKA97R57	4	165
30	178	46.03	7880	2.2	YYKAZ47	4	29	1.9	3430	743	40000	1.25	YYKAF97R57	4	190
23	225	58.60	4850	0.90	YYK37	4	20	2.1	3020	652	40000	1.40	YYKAZ97R57		
27	192	49.79	4790	1.05	YYKF37	4	22	2.4	2680	573	40000	1.60			
31	172	44.46	4740	1.15	YYKA37	4	19	2.7	2320	504	40000	1.85			
36	147	37.97	4640	1.35	YYKAF37	4	21	3.2	2010	437	40000	2.1			
38	137	35.57	4600	1.45	YYKAZ37			3.6	1770	382	40000	2.4			
45	116	29.96	4470	1.75				4.5	1420	305	40000	3.0			
47	111	28.83	4440	1.80				5.4	1190	258	40000	3.6			
54	97	24.99	4320	2.1				5.9	1080	232	40000	4.0			
58	90	23.36	4260	2.2				6.9	920	199	40000	4.7			
67	78	20.19	4130	2.4				1.9	3370	726	26300	0.80	YYK97R57	4	125
79	66	17.15	3980	2.7				2.2	2970	638	26900	0.90	YYKF97R57	4	130
89	59	15.31	3880	3.0				2.5	2610	562	27400	1.05	YYKA97R57	4	110
104	51	13.08	3730	3.3				2.9	2200	474	27900	1.25	YYKAF97R57	4	125
112	47	12.14	3660	3.4				3.2	1980	426	28100	1.35	YYKAZ97R57		
130	41	10.49	3520	4.0				3.7	1720	373	28300	1.55			
153	34	8.91	3370	4.7				4.2	1520	330	28500	1.80			
171	31	7.96	3270	5.1				4.7	1350	294	28600	2.0			
200	26	6.80	3130	5.7				5.5	1160	250	28700	2.3			
214	25	6.37	3070	5.9				5.8	1100	236	28700	2.5			
254	21	5.36	2920	6.8				6.9	930	201	28800	2.9			
0.11	58400	13116	175300	0.85	YYK187R97	4	1770	3.8	1720	367	14000	0.90	YYK77R37	4	74
0.12	51500	11647	187300	0.95	YYKA187R97	4	1770	4.2	1540	328	15500	1.00	YYKF77R37	4	82
0.19	32800	7343	190000	1.50				4.8	1360	290	16600	1.15	YYKA77R37	4	66
0.20	30000	6747	190000	1.65				5.5	1180	252	17500	1.30	YYKAF77R37	4	74
0.23	26500	5991	190000	1.90				6.2	1030	221	18200	1.50	YYKAZ77R37		
0.16	38600	8628	150000	0.85	YYK167R97	4	1180	3.9	1830	176.05	40000	2.3	YYK97	8	175
0.21	29300	6562	150000	1.10	YYKA167R97	4	1180	4.5	1590	153.21	40000	2.7	YYKF97	8	195
0.26	23700	5355	150000	1.35				4.9	1460	140.28	40000	3.0	YYKA97	8	155
0.34	18200	4079	150000	1.75				4.7	1530	147.32	28500	1.75	YYKAF97	8	180
0.41	15100	3376	150000	2.1				5.4	1320	126.91	28600	2.0	YYKAZ97	8	180
0.35	17800	3979	112300	1.00	YYK157R97	4	790	5.4	1320	126.91	28600	2.0	YYK87	8	115
0.45	13600	3051	114100	1.30	YYKF157R97	4	870	6.0	1200	115.82	28700	2.2	YYKF87	8	125
0.83	7440	1659	115900	2.4	YYKA157R97	4	750	6.7	1070	102.71	28700	2.5	YYKA87	8	100
1.0	6040	1365	116200	3.0	YYKAZ157R97	4	810	7.1	1010	126.91	28800	2.7	YYKAF87	8	100
0.42	15100	3311	75800	0.85	YYK127R77	4	475	7.0	1020	197.37	28800	2.6	YYKAZ87	8	115
0.46	13700	3009	78600	0.95	YYKF127R77	4	520	7.9	900	174.19	28800	3.0	YYK87	4	100
0.53	11800	2607	79800	1.10	YYKA127R77	4	445	8.4	850	164.34	28900	3.2	YYKF87	4	110
0.72	8930	1926	81100	1.45	YYKAF127R77	4	485	9.4	765	147.32	28900	3.5	YYKA87	4	88
0.79	8150	1757	81400	1.60	YYKAZ127R77			6.7	1080	135.28	18000	1.45	YYKAF87	4	100
0.90	7120	1541	81700	1.85				7.0	1020	128.52	18200	1.50	YYK77	6	70
1.0	6220	1342	82000	2.1				7.9	900	113.56	18700	1.70	YYKF77	6	78
1.2	5440	1177	82200	2.4				9.3	770	97.05	19100	2.0	YYKA77	6	63
1.4	4750	1025	82400	2.7				10	710	88.97	19200	2.2	YYKAF77	6	70
1.5	4150	899	82500	3.1				9.0	800	154.02	19000	1.95	YYKAZ77		
0.81	7960	1713	65000	1.00	YYK107R77	4	315	10	700	135.28	19300	2.2	YYK77	4	65
0.89	7230	1554	65000	1.10	YYKF107R77	4	325	11	665	128.52	19300	2.3	YYKF77	4	73
1.0	6210	1336	65000	1.30	YYKA107R77	4	285	12	590	113.56	19500	2.6	YYKA77	4	58
1.2	5420	1166	65000	1.50	YYKAF107R77	4	310	14	505	97.05	19700	3.1	YYKAF77	4	65
1.3	4710	1030	65000	1.70	YYKAZ107R77			11	640	123.54	11700	1.30	YYK67	4	39
1.5	4120	904	65000	1.95				13	560	108.03	12100	1.45	YYKF67	4	45
1.7	3680	793	65000	2.2				15	465	90.04	12600	1.75	YYKA67	4	37
2.0	3210	696	65000	2.5				18	395	76.37	12800	2.1	YYKAF67	4	42
2.2	2800	615	65000	2.8				20	360	68.95	13000	2.3	YYKAZ67		
								23	315	60.66	13000	2.6			
								24	295	57.28	13000	2.8			

YYK系列 | 选型参数表
Selection table

输出转速 output speed na r/min	输出转矩 output torque Ma N.m	传动比 Ratio i	径向载荷 Permissible overhung load outside Fa N	使用系数 service factor fb	机型号 Type	极数 Pole	重量 weight kg	输出转速 output speed na r/min	输出转矩 output torque Ma N.m	传动比 Ratio i	径向载荷 Permissible overhung load outside Fa N	使用系数 service factor fb	机型号 Type	极数 Pole	重量 weight kg	
0.75kW								1.1kW								
11	645	123.85	7130	0.95	YYK57	4	33	0.73	13100	1926	79100	1.00	YYK127R77	4	480	
13	560	108.29	7940	1.05	YYKF57	4	38	0.80	11900	1757	79800	1.10	YYKF127R77	4	520	
15	470	90.26	8570	1.30	YYKA57	4	31	0.91	10400	1541	80500	1.25	YYKA127R77	4	450	
18	395	76.56	8890	1.50	YYKAF57	4	37	1.0	9100	1342	81100	1.45	YYKAF127R77	4	490	
20	360	69.12	9060	1.65	YYKAZ57			1.2	7960	1177	81500	1.65	YYKAZ127R77			
23	315	60.81	9230	1.90				1.4	6950	1025	81800	1.85				
24	300	57.42	9290	2.0				1.6	6080	899	82000	2.1				
28	255	48.89	9450	2.4				1.8	5270	790	82200	2.5				
31	230	44.43	9530	2.6				2.0	4740	704	82400	2.7				
								2.3	4090	610	82500	3.2				
18	390	75.20	6060	1.00	YYK47	4	28	2.5	3690	549	82500	3.5				
20	365	69.84	6410	1.10	YYKF47	4	31	2.9	3180	477	82600	4.1				
22	330	63.30	6790	1.20	YYKA47	4	29									
24	295	56.83	7110	1.35	YYKAF47	4	30	1.2	7920	1166	65000	1.00	YYK107R77	4	320	
28	255	48.95	7430	1.55	YYKAZ47			1.4	6920	1030	65000	1.15	YYKF107R77	4	330	
30	240	46.03	7540	1.65				1.5	6050	904	65000	1.30	YYKA107R77	4	290	
35	205	39.61	7740	1.95				1.8	5380	793	65000	1.50	YYKAF107R77	4	315	
39	184	35.39	7760	2.2				2.0	4700	696	65000	1.70	YYKAZ107R77			
44	162	31.30	7550	2.5				2.3	4120	615	65000	1.95				
								2.7	3500	522	65000	2.3				
31	230	44.46	4170	0.85	YYK37	4	21	3.0	3080	461	65000	2.6				
36	197	37.97	4150	1.00	YYKF37	4	23	3.4	2720	408	65000	2.9				
39	185	35.57	4140	1.10	YYKA37	4	20	3.8	2450	364	65000	3.3				
46	156	29.96	4080	1.30	YYKAF37	4	22	4.4	2140	318	65000	3.7				
48	150	28.83	4060	1.35	YYKAFZ7											
55	130	24.99	3990	1.55				1.9	5030	743	39900	0.85	YYK97R57	4	190	
59	121	23.36	3950	1.60				2.2	4420	652	40000	0.95	YYKF97R57	4	210	
68	105	20.19	3860	1.75				2.4	3910	573	40000	1.10	YYKA97R57	4	170	
80	89	17.15	3750	2.0				2.8	3400	504	40000	1.25	YYKAF97R57	4	195	
90	80	15.31	3670	2.2				3.2	2940	437	40000	1.45	YYKAZ97R57			
105	68	13.08	3550	2.4				3.7	2590	382	40000	1.65				
114	63	12.14	3500	2.5				4.1	2300	342	40000	1.85				
132	54	10.49	3380	2.9												
155	46	8.91	3250	3.5				3.0	3220	474	26600	0.85	YYK87R57	4	130	
173	41	7.96	3160	3.8				3.3	2890	426	27000	0.95	YYKF87R57	4	135	
203	35	6.80	3030	4.2				3.8	2520	373	27500	1.05	YYKA87R57	4	115	
217	33	6.37	2980	4.4				4.2	2230	330	27800	1.20	YYKAF87R57	4	130	
257	28	5.36	2840	5.0				4.8	1980	294	28100	1.35	YYKAZ87R57			
								5.6	1700	250	28300	1.60				
								5.9	1600	236	28400	1.70				
								7.0	1360	201	28600	2.0				
1.1kW																
0.15	60700	9363	171000	0.80	YYK187R97	4	1770	3.9	2720	176.05	40000	1.60	YYK97	8	175	
0.17	52400	8126	185900	0.95				4.4	2370	153.21	40000	1.80	YYKF97	8	200	
0.19	48300	7343	190000	1.05	YYKA187R97	4	1770	4.8	2170	140.28	40000	2.0	YYKAF97	8	160	
0.21	44300	6747	190000	1.15				5.5	1910	123.93	40000	2.2	YYKAZ97	8	185	
0.23	39200	5991	190000	1.30												
0.26	34900	5358	190000	1.45				5.2	2010	176.05	40000	2.1	YYK97	6	165	
0.29	31200	4817	190000	1.60				6.0	1750	153.21	40000	2.5	YYKF97	6	185	
0.32	28300	4370	190000	1.75				6.6	1600	140.28	40000	2.7	YYKA97	6	145	
								7.4	1420	123.93	40000	3.0	YYKAF97	6	170	
0.26	35000	5355	150000	0.90	YYK167R97	4	1190	7.9	1320	176.05	40000	3.3	YYK97	4	165	
0.29	31200	4788	150000	1.05				9.1	1150	153.21	40000	3.7	YYKF97	4	185	
0.34	26800	4079	150000	1.20	YYKA167R97	4	1190	10	1050	140.28	40000	4.1	YYKA97	4	145	
0.41	22200	3376	150000	1.45												
0.51	18000	2755	150000	1.80				5.3	1990	174.19	28100	1.35	YYK87	6	105	
0.64	14600	2182	150000	2.2				5.6	1880	164.34	28200	1.45	YYKF87	6	115	
0.82	11300	1704	150000	2.8				6.2	1680	147.32	28300	1.60	YYKA87	6	94	
0.99	9330	1408	150000	3.4				7.2	1450	126.91	28500	1.85	YYKAZ87	6	110	
1.1	8560	1296	150000	3.7												
0.40	22900	3516	109300	0.80	YYK157R97	4	800	8.0	1310	174.19	28600	2.1	YYK87	4	105	
0.46	20100	3051	111100	0.90	YYKF157R97	4	870	8.5	1230	164.34	28700	2.2	YYKAF87	4	115	
0.54	16900	2610	112700	1.05	YYKA157R97	4	760	9.5	1110	147.32	28700	2.4	YYKA87	4	93	
0.60	15100	2322	113500	1.20	YYKAF157R97	4	820	11	950	126.91	28800	2.8	YYKAF87	4	105	
0.84	11000	1659	115000	1.65	YYKAZ157R97			12	870	115.82	28800	3.1	YYKAZ87			
1.0	8970	1365	115600	2.0												
1.1	8030	1229	115800	2.2												
1.3	7150	1093	116000	2.5				6.8	1540	135.28	15400	1.00	YYK77	6	71	
1.5	6160	942	116100	2.9				7.2	1470	128.52	15900	1.05	YYKF77	6	79	
1.6	5550	854	116200	3.2				8.1	1300	113.56	17000	1.20	YYKA77	6	64	
								9.5	1110	97.05	17900	1.40	YYKAF77	6	71	

输出转速 output speed n _a r/min	输出转矩 output torque Ma N.m	传动比 Ratio i	径向载荷 Permissible overhung load outputside F _a N	使用系数 service factor fb	机型号 Type	极数 Pole	重量 weight kg	输出转速 output speed n _a r/min	输出转矩 output torque Ma N.m	传动比 Ratio i	径向载荷 Permissible overhung load outputside F _a N	使用系数 service factor fb	机型号 Type	极数 Pole	重量 weight kg
1.1kW								1.5kW							
10	1020	135.28	18300	1.55	YYK77	4	70	0.21	60700	6747	171100	0.80	YYK187R97	4	1770
11	960	128.52	18400	1.60	YYKF77	4	78	0.24	53700	5991	183600	0.95			
12	850	113.56	18800	1.80	YYKA77	4	63	0.26	47900	5358	190000	1.05	YYKA187R97	4	1770
14	730	97.05	19200	2.1	YYKAF77	4	70	0.29	42900	4817	190000	1.15			
16	670	88.97	19300	2.3	YYKAZ77			0.32	38900	4370	190000	1.30			
48	585	78.07	19500	2.7				0.39	33000	3609	190000	1.50			
19	555	73.99	19600	2.8				0.46	27800	3062	190000	1.80			
								0.56	22800	2519	190000	2.2			
13	810	108.03	10400	1.00	YYK67	4	44	0.62	20400	2268	190000	2.5			
14	770	102.62	10700	1.05	YYKF67	4	50								
16	675	90.04	11400	1.20	YYKA67	4	42								
18	575	76.37	12000	1.45	YYKAF67	4	47	0.35	36700	4079	150000	0.85	YYK167R97	4	1190
20	515	68.95	12300	1.60	YYKAZ67			0.42	30400	3376	150000	1.05			
23	455	60.66	12600	1.80				0.51	24700	2755	150000	1.30	YYKA167R97	4	1190
24	430	57.28	12700	1.90				0.65	19900	2182	150000	1.60			
29	365	48.77	12900	2.2				0.83	15500	1704	150000	2.1			
32	335	44.32	13000	2.5				1.0	12800	1408	150000	2.5			
36	290	38.39	13000	2.8				1.1	11800	1296	150000	2.7			
16	675	90.26	2410	0.90	YYK57	4	38	0.61	20700	2322	110700	0.85	YYK157R97	4	800
18	575	76.56	7840	1.05	YYKF57	4	43	0.85	15100	1659	113500	1.20	YYKF157R97	4	880
20	520	69.12	8280	1.15	YYKA57	4	36	1.0	12300	1365	114600	1.45	YYKA157R97	4	760
23	455	60.81	8630	1.30	YYKAF57	4	42	1.1	11100	1229	115000	1.65	YYKAF157R97	4	820
24	430	57.42	8750	1.40	YYKAZ57			1.3	9840	1093	115300	1.85	YYKAZ157R97		
29	365	48.89	9020	1.65				1.5	8480	942	115700	2.1			
32	335	44.43	9160	1.80				1.6	7650	854	115900	2.3			
36	290	38.49	9330	2.1				2.5	5050	567	116300	3.6			
39	270	35.70	9400	2.2				2.8	4490	504	116400	4.0			
46	2250	30.28	9540	2.6											
51	205	27.34	9510	2.9				2.6	4820	536	82300	2.7	YYK127R87	4	500
58	181	24.05	9220	3.3				3.4	3770	418	82500	3.5	YYKF127R87	4	540
62	170	22.71	9090	3.5				3.8	3330	367	82600	3.9	YYKA127R87	4	470
72	145	19.34	8720	4.0									YYKAF127R87	4	470
80	132	17.57	8510	4.2									YYKAZ127R87	4	510
92	114	15.22	8180	4.7				0.80	16200	1757	73400	0.80	YYK127R77	4	480
106	99	13.25	7880	5.1				0.91	14200	1541	77500	0.90	YYKF127R77	4	520
117	90	11.92	7570	4.6				1.0	12400	1342	79500	1.05	YYKA127R77	4	450
124	85	11.26	7450	4.9				1.2	10900	1177	80300	1.20	YYKAF127R77	4	450
146	72	9.59	7120	5.6				1.4	9470	1025	80900	1.35	YYKAZ127R77	4	490
161	65	8.71	6930	6.0				1.6	8300	899	81400	1.55			
186	57	7.55	6650	6.4				1.8	7210	790	81700	1.80			
213	49	6.57	6380	7.0				2.0	6480	704	81900	2.0			
								2.3	5590	610	82200	2.3			
25	425	56.83	3310	0.95	YYK47	4	33	2.6	5040	549	82300	2.6			
29	365	48.95	6360	1.10	YYKF47	4	36	3.0	4360	477	82400	3.0			
30	345	46.03	6610	1.15	YYKA47	4	32	3.4	3840	418	82500	3.4			
35	295	39.61	7090	1.35	YYKAF47	4	35								
40	265	35.39	7090	1.50	YYKAZ47			1.4	9460	1030	65000	0.85	YYK107R77	4	320
45	235	31.30	6960	1.70				1.6	8280	904	65000	0.95	YYKF107R77	4	330
48	220	29.32	6890	1.80				1.8	7330	793	65000	1.10	YYKA107R77	4	290
54	194	25.91	6730	2.1				2.0	6420	696	65000	1.25	YYKAF107R77	4	315
64	164	21.81	6510	2.4				2.3	5640	615	65000	1.40	YYKAZ107R77		
72	147	19.58	6360	2.7				2.7	4780	522	65000	1.65			
								3.1	4210	461	65000	1.90			
47	225	29.96	3420	0.90	YYK37	4	26	3.5	3720	408	65000	2.2			
56	188	24.99	3440	1.05	YYKF37	4	28	3.9	3350	364	65000	2.4			
60	175	23.36	3440	1.10	YYKA37	4	26	4.4	2920	318	65000	2.7			
69	152	20.19	3420	1.20	YYKAF37	4	27								
82	129	17.15	3370	1.40	YYKAZ37			2.5	5320	573	39500	0.80	YYK97R57	4	190
91	115	15.31	3330	1.50				2.8	4650	504	40000	0.95	YYKF97R57	4	210
107	98	13.08	3260	1.70				3.2	4020	437	40000	1.05	YYKA97R57	4	170
115	91	12.14	3220	1.75				3.7	3540	382	40000	1.20	YYKAF97R57	4	195
133	79	10.49	3140	2.0				4.1	3140	342	40000	1.35	YYKAZ97R57		
157	67	8.91	3040	2.4				4.6	2820	305	40000	1.50			
176	60	7.96	2970	2.6				5.5	2380	258	40000	1.80			
206	51	6.80	2870	2.9				6.1	2140	232	40000	2.0			
220	48	6.37	2830	3.0				7.1	1840	199	40000	2.3			
261	40	5.36	2720	3.5											

YYK系列 | 选型参数表
Selection table

输出转速 output speed na r/min	输出转矩 output torque Ma N.m	传动比 Ratio i	径向载荷 Permissible overhung load outside Fa N	使用系数 service factor fb	机型号 Type	极数 Pole	重量 weight kg	输出转速 output speed na r/min	输出转矩 output torque Ma N.m	传动比 Ratio i	径向载荷 Permissible overhung load outside Fa N	使用系数 service factor fb	机型号 Type	极数 Pole	重量 weight kg
1.5kW								1.5kW							
4.3	3040	330	26800	0.90	YYK87R57	4	130	23	620	60.81	7480	0.95	YYK57	4	40
4.8	2700	294	27300	1.00	YYKF87R57	4	140	25	585	57.42	7770	1.05	YYKF57	4	45
5.6	2310	250	27700	1.15	YYKA87R57	4	120	29	495	48.89	8430	1.20	YYKA57	4	38
6.0	2180	236	27900	1.25	YYKAF87R57	4	130	32	450	44.43	8650	1.35	YYKAF57	4	44
7.0	1860	201	28200	1.45	YYKAZ87R57			37	390	38.49	8920	1.55	YYKAZ57		
7.7	1690	183	28300	1.60				39	365	35.70	9040	1.65			
								47	310	30.28	9190	1.95			
4.9	2940	143.47	65000	2.7	YYK107	8	300	52	280	27.34	9010	2.2			
5.8	2490	121.46	65000	3.2	YYKF107	8	310	59	245	24.05	8780	2.5			
6.2	2300	112.41	65000	3.5	YYKA107	8	270	62	230	22.71	8670	2.6			
								73	196	19.34	8360	2.9			
4.6	3140	153.21	40000	1.35	YYK97	8	185	36	400	39.61	5890	1.00	YYK47	4	35
5.0	2870	140.28	40000	1.50	YYKF97	8	205	40	360	35.39	6360	1.10	YYKF47	4	38
5.7	2540	123.93	40000	1.70	YYKA97	8	165	45	320	31.30	6310	1.25	YYKA47	4	34
								48	300	29.32	6270	1.35	YYKAF47	4	37
5.2	2740	176.05	40000	1.55	YYKAZ97	6	175	54	265	25.91	6190	1.50	YYKAZ47		
6.0	2390	153.21	40000	1.80	YYK97	6	195	65	220	21.81	6050	1.80			
6.6	2180	140.28	40000	1.95	YYKF97	6	155	72	199	19.58	5950	2.0			
7.4	1930	123.93	40000	2.2	YYKA97	6	180	84	171	16.86	5800	2.2			
								89	161	15.86	5730	2.4			
8.0	1790	176.05	40000	2.4	YYKAZ97	6	170	103	139	13.65	5560	2.6			
9.2	1560	153.21	40000	2.8	YYK97	4	165	116	124	12.19	5430	2.8			
10	1430	140.28	40000	3.0	YYKF97	4	185	120	120	11.77	5340	2.3			
11	1260	123.93	40000	3.4	YYKA97	4	145								
6.2	2290	147.32	27800	1.20	YYKAZ97	4	170	60	235	23.36	2860	0.80	YYK37	4	27
7.2	1980	126.91	28100	1.35	YYK87	6	115	70	205	20.19	2920	0.90	YYKF37	4	29
7.9	1800	115.82	28200	1.50	YYKF87	6	125	82	174	17.15	2940	1.05	YYKA37	4	27
9.0	1600	102.71	28400	1.70	YYKA87	6	100	92	156	15.31	2950	1.10	YYKAF37	4	29
								108	133	13.08	2930	1.25	YYKAZ37		
								116	123	12.14	2920	1.30			
8.1	1770	174.19	28300	1.55	YYKAZ87	6	115	134	107	10.49	2880	1.50			
8.6	1670	164.34	28300	1.60	YYK87	4	105	158	91	8.91	2820	1.75			
9.6	1500	147.32	28500	1.80	YYKF87	4	115	177	81	7.96	2770	1.90			
11	1290	126.91	28600	2.1	YYKA87	4	94	207	69	6.80	2700	2.2			
12	1180	115.82	28700	2.3	YYKAF87	4	110	221	65	6.37	2670	2.2			
14	1040	102.71	28800	2.6	YYKAZ87			263	55	5.36	2580	2.6			
16	880	86.34	28800	3.1											
8.1	1770	113.56	13600	0.90	YYK87	4	105	0.32	57900	4370	176200	0.85		4	1780
9.5	1510	97.05	15700	1.05	YYKF77	6	86	0.39	48800	3609	190000	1.00			
10	1390	88.97	16400	1.10	YYKA77	6	71	0.46	41300	3062	190000	1.20		4	1780
12	1220	78.07	17400	1.30	YYKAF77	6	71	0.50	37000	2818	190000	1.35			
								0.56	33800	2519	190000	1.50			
								0.62	30400	2268	190000	1.65			
								0.69	27400	2054	190000	1.80			
10	1370	135.28	16500	1.15	YYKAZ77	6	78	0.77	24200	1821	190000	2.1			
11	1310	128.52	16900	1.20	YYK77	4	71	0.88	21400	1605	190000	2.3			
12	1150	113.56	17700	1.35	YYKF77	4	79								
15	990	97.05	18400	1.55	YYKA77	4	64	0.51	36600	2755	150000	0.85	YYK167R97	4	1200
16	900	88.97	18700	1.70	YYKAF77	4	71	0.62	29800	2263	150000	1.05	YYKA167R97	4	1200
18	795	78.07	19000	1.95	YYKAZ77			0.65	29500	2182	150000	1.10		4	1200
19	750	73.99	19100	2.1	YYK77	4	71	0.83	22900	1704	150000	1.40			
22	660	64.75	19400	2.4	YYKF77	4	79	1.0	19000	1408	150000	1.70		4	1200
24	595	58.34	19500	2.6	YYKA77	4	64	1.1	17400	1296	150000	1.85			
28	520	51.18	19700	3.0	YYKAF77	4	71	1.3	14700	1101	150000	2.2			
31	460	45.16	19800	3.4	YYKAZ77			1.5	12600	944	150000	2.5			
35	405	40.04	19800	3.8											
16	910	90.04	9370	0.90	YYK77	4	71	0.85	22400	1659	109700	0.80	YYK157R97	4	800
18	775	76.37	10700	1.05	YYKF77	4	79	1.0	18300	1365	112000	1.00	YYKF157R97	4	880
20	700	68.95	11300	1.15	YYKA77	4	64	1.1	16500	1229	112900	1.10	YYKA157R97	4	760
23	615	60.66	11800	1.35	YYKAF77	4	49	1.3	14600	1093	113700	1.25	YYKAF157R97	4	820
25	580	57.28	12000	1.40	YYKAZ77			1.5	12600	942	114500	1.45	YYKAZ157R97		
29	495	48.77	12400	1.65				1.6	11400	854	114900	1.60			
32	450	44.32	12600	1.80	YYK67	4	46	1.9	9990	756	115300	1.80			
37	390	38.39	12800	2.0	YYKF67	4	52								
40	360	35.62	12900	2.3	YYKA67	4	44	2.6	7180	536	81700	1.80	YYK127R87	4	510
47	305	30.22	13000	2.7	YYKAF67	4	49	3.0	6310	473	82000	2.1	YYKF127R87	4	550
52	275	27.28	13000	3.0	YYKAZ67			3.4	5600	418	82200	2.3	YYKA127R87	4	480
59	245	24.00	13000	3.3				3.8	4950	367	82300	2.6	YYKAF127R87	4	520
								4.3	4440	330	82400	2.9	YYKAZ127R87		

输出转速 output speed na r/min	输出转矩 output torque Ma N.m	传动比 Ratio i	径向载荷 Permissible overhung load outputside Fa N	使用系数 service factor fb	机型号 Type	极数 Pole	重量 weight kg	输出转速 output speed na r/min	输出转矩 output torque Ma N.m	传动比 Ratio i	径向载荷 Permissible overhung load outputside Fa N	使用系数 service factor fb	机型号 Type	极数 Pole	重量 weight kg
2.2kW								2.2kW							
1.4	14000	1025	78000	0.95	YYK127R77	4	485	47	450	30.22	12600	1.80	YYK67	4	53
1.6	12200	899	79600	1.05	YYKF127R77	4	530	52	405	27.28	12800	2.0	YYKF67	4	59
1.8	10700	790	80400	1.20	YYKA127R77	4	460	59	360	24.00	13000	2.2	YYKA67	4	51
2.0	9580	704	80900	1.35	YYKAF127R77	4	495	62	340	22.66	13000	2.3	YYKAF67	4	56
2.3	8280	610	81400	1.55	YYKAZ127R77			73	285	19.30	13000	2.6	YYKAZ67		
2.6	7460	549	81600	1.75				80	260	17.54	13000	2.8			
3.0	6460	477	81900	2.0				93	225	15.19	13000	3.1			
3.4	5680	418	82100	2.3				107	197	13.22	13000	3.4			
								113	186	12.48	13000	2.8			
								133	158	10.63	13000	3.2			
2.3	8340	615	65000	0.95		4	325	146	144	9.66	13000	3.3			
2.7	7070	522	65000	1.15		4	340	169	125	8.37	13000	3.5			
3.1	6230	461	65000	1.30		4	300	194	109	7.28	12700	3.9			
3.5	5520	408	65000	1.45		4	325								
3.9	4940	364	65000	1.60				32	660	44.43	5100	0.90	YYK57	4	47
4.4	4320	318	65000	1.85				37	575	38.49	7850	1.05	YYKF57	4	52
4.9	3890	286	65000	2.1				39	530	35.70	8180	1.15	YYKA57	4	45
5.6	3410	251	65000	2.3				47	450	30.28	8250	1.35	YYKAF57	4	51
								52	405	27.34	8160	1.45	YYKAZ57		
								59	360	24.05	8030	1.65			
3.7	5210	382	39700	0.80	YYK97R57	4	195	62	340	22.71	7970	1.75			
4.1	4640	342	40000	0.95	YYKF97R57	4	220	73	290	19.34	7760	2.0			
4.6	4170	305	40000	1.05	YYKA97R57	4	180	80	260	17.57	7630	2.1			
5.5	3510	258	40000	1.20	YYKAF97R57	4	205	93	225	15.22	7430	2.4			
6.1	3160	232	40000	1.35	YYKAZ97R57			106	197	13.25	7220	2.6			
7.1	2710	199	40000	1.60				118	178	11.92	6890	2.3			
								125	168	11.26	6810	2.5			
4.9	4310	143.47	65000	1.85	YYK107	8	305								
5.8	3650	121.46	65000	2.2	YYKF107	8	315	54	385	25.91	5260	1.05	YYK47	4	42
6.2	3370	112.41	65000	2.4	YYKA107	8	275	65	325	21.81	5260	1.25	YYKF47	4	45
6.9	3020	100.75	65000	2.7	YYKAF107	8	300	72	290	19.58	5240	1.35	YYKA47	4	41
													YYKAF47	4	44
													YYKAZ47	4	44
6.1	3420	153.21	40000	1.25	YYK97	6	185	84	250	16.86	5190	1.50			
6.7	3140	140.28	40000	1.35	YYKF97	6	205	89	235	15.86	5160	1.60			
7.6	2770	123.93	40000	1.55	YYKA97	6	165	103	205	13.65	5070	1.75			
8.9	2350	105.13	40000	1.85	YYKAF97	6	190	116	182	12.19	4990	1.95			
								120	175	11.77	4890	1.60			
								133	157	10.56	4810	1.80			
8.0	2620	176.05	40000	1.65	YYK97	4	175	155	136	9.10	4690	2.1			
9.2	2280	153.21	40000	1.90	YYKF97	4	195								
10	2090	140.28	40000	2.1	YYKA97	4	155	108	195	13.08	2370	0.85	YYK37		33
11	1850	123.93	40000	2.3	YYKAF97	4	180	134	156	10.49	2430	1.00	YYKF37		36
13	1570	105.13	40000	2.8				158	133	8.91	2440	1.20	YYKA37		33
15	1440	96.80	40000	3.0				177	119	7.96	2430	1.30	YYKAF37		35
								207	101	6.80	2410	1.50	YYKAZ37		
9.6	2200	147.32	27900	1.25	YYK87	4	115	221	95	6.37	2400	1.55			
11	1890	126.91	28200	1.45	YYKF87	4	125	263	80	5.36	2350	1.75			
12	1730	115.82	28300	1.55	YYKA87	4	100	3kW							
14	1530	102.71	28500	1.75	YYKAF87	4	115	0.50	51300	2818	187700	0.95	YYK187R97	4	1780
16	1290	86.34	28600	2.1	YYKAZ87										
18	1180	79.34	28700	2.3											
20	1050	70.46	28800	2.6											
22	940	63.00	28800	2.9				0.46	57100	3062	177600	0.90	YYK187R97	4	1780
								0.56	46800	2519	190000	1.05			
12	1690	113.56	14300	0.90	YYK77	4	78	0.62	42100	2268	190000	1.20	YYKA187R97	4	1780
15	1450	97.05	16100	1.05	YYKF77	4	86	0.68	38000	2054	190000	1.30			
16	1330	88.97	16800	1.15	YYKA77	4	71	0.77	33600	1821	190000	1.50			
18	1160	78.07	17600	1.35	YYKAF77	4	78	0.87	29700	1605	190000	1.70			
19	1100	73.99	17900	1.40	YYKAZ77			1.0	25600	1395	190000	1.95			
22	960	64.75	18400	1.60				1.2	22100	1196	190000	2.3			
24	870	58.34	18800	1.80											
28	765	51.18	19100	2.0				0.82	31700	1704	150000	1.00	YYK167R97	4	1200
31	675	45.16	19300	2.3				0.99	26200	1408	150000	1.20			
35	595	40.04	19500	2.6				1.1	24100	1296	150000	1.35	YYKA167R97	4	1200
40	525	35.20	19700	3.0				1.3	20300	1101	150000	1.55			
46	460	30.89	19800	3.4				1.5	17500	944	150000	1.85			
48	435	29.27	19800	3.6				1.7	15500	843	150000	2.1			
55	380	25.62	19900	4.1				1.9	14000	757	150000	2.3			
23	900	60.66	9490	0.90	YYK67	4	53	1.1	22800	1229	109400	0.80	YYK157R97	4	810
25	850	57.28	10000	0.95	YYKF67	4	59	1.3	20300	1093	111000	0.90	YYKF157R97	4	880
29	725	48.77	11100	1.15	YYKA67	4	51	1.5	17500	942	112400	1.05	YYKA157R97	4	770
32	660	44.32	11500	1.25	YYKAF67	4	56	1.6	15800	854	113200	1.15	YYKAF157R97	4	830
37	570	38.39	12100	1.40	YYKAZ67			1.9	13900	756	114000	1.30	YYKAZ157R97		
40	530	35.62	12300	1.55				2.5	10500	567	115200	1.70			
								2.8	9310	504	115500	1.95			

YYK系列 | 选型参数表
Selection table

111

输出转速 output speed na r/min	输出转矩 output torque Ma N.m	传动比 Ratio i	径向载荷 Permissible overhung load outpside Fa N	使用系数 service factor fb	机型号 Type	极数 Pole	重量 weight kg	输出转速 output speed na r/min	输出转矩 output torque Ma N.m	传动比 Ratio i	径向载荷 Permissible overhung load outpside Fa N	使用系数 service factor fb	机型号 Type	极数 Pole	重量 weight kg
3kW								3kW							
2.6	9940	536	80700	1.30	YYK127R87	4	510	16	1820	88.97	13100	0.85	YYK77	4	82
3.0	8750	473	81200	1.50	YYKF127R7	4	550	18	1600	78.07	15000	0.95	YYKF77	4	90
3.3	7760	418	81500	1.70	YYKA127R87	4	485	19	1510	73.99	15600	1.00	YYKA77	4	75
3.8	6840	367	81800	1.90	YYKAF127R87	4	520	22	1330	64.75	16800	1.15	YYKAF77	4	82
4.2	6140	330	82000	2.1	YYKAZ127R87			24	1190	58.34	17500	1.30	YYKAZ77		
4.9	5300	287	82200	2.5				27	1050	51.18	18100	1.50			
								31	920	45.16	18600	1.70			
1.8	14800	790	76500	0.90	YYK127R77	4	490	35	820	40.04	18900	1.90			
2.0	13200	704	79100	1.00	YYKF127R77	4	530	40	720	35.20	19200	2.2			
2.3	11400	610	80000	1.15	YYKA127R77	4	465	45	630	30.89	19400	2.5			
2.5	10300	549	80600	1.25	YYKAF127R77	4	500								
2.9	8920	477	81100	1.45	YYKAZ127R77			32	910	44.32	9450	0.90	YYK67	4	57
3.3	7840	418	81500	1.65				36	785	38.39	10600	1.00	YYKF67	4	63
								39	730	35.62	11100	1.15	YYKA67	4	55
3.0	8610	461	65000	0.95	YYK107R77	4	330	46	620	30.22	11800	1.35	YYKAF67	4	60
3.4	7620	408	65000	1.05	YYKF107R77	4	340	51	560	27.28	12100	1.45	YYKAZ67		
3.8	6820	364	65000	1.15	YYKA107R77	4	305	58	490	24.00	12500	1.65			
4.4	5960	318	65000	1.35	YYKAF107R77	4	325	62	465	22.66	12600	1.70			
4.9	5370	286	65000	1.50	YYKAZ107R77			73	395	19.30	12800	1.95			
5.6	4700	251	65000	1.70				80	360	17.54	13000	2.1			
6.3	4150	222	65000	1.95				92	310	15.19	13000	2.2			
7.1	3670	196	65000	2.2				106	270	13.22	13000	2.5			
8.1	3250	174	65000	2.2				112	255	12.48	13000	2.1			
9.1	2880	154	65000	2.5				132	220	10.63	13000	2.3			
10	2610	140	65000	2.8				145	198	9.66	13000	2.4			
5.4	4840	258	40000	0.90	YYK97R57	4	200	46	620	30.28	7180	0.95	YYK57	4	51
6.0	4360	232	40000	1.00	YYKP97R57	4	220	51	560	27.34	7190	1.05	YYKF57	4	56
7.0	3740	199	40000	1.15	YYKA97R57	4	185	58	490	24.05	7180	1.20	YYKA57	4	49
								62	465	22.71	7160	1.30	YYKAF57	4	55
5.0	5710	143.47	65000	1.40	YYKAZ97R57	4	210	72	395	19.34	7080	1.45	YYKAZ57		
5.9	4830	121.46	65000	1.65	YYK107	8	325	80	360	17.57	7020	1.55			
6.4	4470	112.41	65000	1.80	YYKF107	8	335	92	310	15.22	6890	1.70			
7.2	4010	100.75	65000	2.0	YYKA107	8	295	106	270	13.25	6750	1.90			
7.9	3620	90.96	65000	2.2	YYKAF107	8	320	117	245	11.92	6420	1.70			
								124	230	11.26	6370	1.80			
6.6	4370	143.47	65000	1.85	YYKAZ107	6	305	146	196	9.59	6200	2.1			
7.7	3700	121.46	65000	2.2	YYK107	6	315	161	178	8.71	6090	2.2			
8.4	3430	112.41	65000	2.3	YYKF107	6	275	186	154	7.55	5920	2.4			
9.3	3070	100.75	65000	2.6	YYKA107	6	300	213	134	6.57	5750	2.6			
9.8	2940	143.47	65000	2.7	YYKAF107	4	295	72	400	19.58	4430	1.00	YYK47	4	46
12	2490	121.46	65000	3.2	YYKAZ107	4	305	83	345	16.86	4490	1.10	YYKF47	4	49
								88	325	15.86	4500	1.15	YYKA47	4	45
													YYKAF47	4	48
													YYKAZ47	4	48
7.6	3780	123.93	40000	1.15	YYK107	4	290	103	280	13.65	4510	1.30	YYK47	4	46
8.9	3200	105.13	40000	1.35	YYKF97	6	190	115	250	12.19	4490	1.40	YYKF47	4	49
9.7	2950	96.80	40000	1.45	YYKA97	6	210	119	240	11.77	4370	1.15	YYKA47	4	45
11	2640	86.52	40000	1.65	YYKAF97	6	170	133	215	10.56	4350	1.30	YYKAF47	4	48
								154	186	9.10	4290	1.50	YYKAZ47		
7.9	3600	176.05	40000	1.20	YYKAZ97	6	195	164	175	8.56	4270	1.55			
9.1	3140	153.21	40000	1.35	YYK97	4	175	190	151	7.36	4190	1.65			
10	2870	140.28	40000	1.50	YYKF97	4	200	213	135	6.58	4120	1.80			
11	2540	123.93	40000	1.70	YYKA97	4	160	241	119	5.81	4030	1.95			
13	2150	105.13	40000	2.0	YYKAF97	4	185								
14	1980	96.80	40000	2.2	YYKAZ97			157	182	8.91	2000	0.90	YYK37	4	37
16	1770	86.52	40000	2.4				176	163	7.96	2040	0.95	YYKF37	4	40
18	1590	77.89	40000	2.7				206	139	6.80	2080	1.10	YYKA37	4	37
20	1440	70.54	40000	3.0				220	130	6.37	2080	1.10	YYKAF37	4	39
22	1280	62.55	40000	3.4				261	110	5.36	2090	1.30	YYKAZ37		
25	1160	56.55	40000	3.7											
9.5	3010	147.32	26900	0.90	YYK87	4	120	4kW							
11	2600	126.91	27400	1.05	YYKF87	4	130	1.7	20300	835	190000	2.5	YYK187R107	4	1830
12	2370	115.82	27700	1.15	YYKA87	4	105	2.7	12600	520	190000	4.0	YYKA187R107	4	1830
14	2100	102.71	28000	1.30	YYKAF87	4	120	0.56	61900	2519	168800	0.80	YYK187R97	4	1790
16	1770	86.34	28300	1.55	YYKAZ87			0.63	55600	2268	180200	0.90			
18	1620	79.34	28400	1.65				0.69	50300	2054	189400	1.00	YYKA187R97	4	1790
20	1440	70.46	28500	1.85				0.78	44500	1821	190000	1.10			
22	1290	63.00	28600	2.1				0.88	39300	1605	190000	1.25			
25	1160	56.64	28700	2.3				1.0	34000	1395	190000	1.45			
28	1010	49.16	28800	2.7				1.2	29200	1196	190000	1.70			
32	900	44.02	28800	2.9				1.4	25600	1046	190000	1.95			
38	745	36.52	28400	3.3				1.5	23100	945	190000	2.2			

输出转速 output speed na r/min	输出转矩 output torque Ma N.m	传动比 Ratio i	径向载荷 Permissible overhung load outputside Fa N	使用系数 service factor fb	机型号 Type	极数 Pole	重量 weight kg	输出转速 output speed na r/min	输出转矩 output torque Ma N.m	传动比 Ratio i	径向载荷 Permissible overhung load outputside Fa N	使用系数 service factor fb	机型号 Type	极数 Pole	重量 weight kg
4kW								4kW							
1.0	34600	1408	150000	0.90	YK167R97	4	1210	12	3120	115.82	26700	0.85	YK87	4	125
1.1	31900	1296	150000	1.00				14	2760	102.71	27200	1.00	YKF87	4	135
1.3	26900	1101	150000	1.20	YK167R97	4	1210	16	2320	86.34	27700	1.15	YKA87	4	110
1.5	23100	944	150000	1.40				18	2130	79.34	27900	1.25	YKAF87	4	125
1.7	20500	843	150000	1.55				20	1900	70.46	28200	1.40	YKAZ87		
1.9	18500	757	150000	1.75				23	1690	63.00	28300	1.60			
2.2	15400	632	150000	2.1				25	1520	56.64	28500	1.75			
1.7	20900	854	110600	0.85	YK157R97	4	810	29	1320	49.16	28600	2.0			
1.9	18400	756	112000	1.00	YKF157R97	4	890	32	1180	44.02	28300	2.2			
2.5	13800	567	114000	1.30	YKA157R97	4	780	39	980	36.52	27300	2.5			
2.8	12300	504	114600	1.45	YKAF157R97	4	830								
3.3	10600	434	115100	1.70	YKAZ157R97			22	1740	64.75	13900	0.90	YK77	4	88
2.7	13100	536	79100	1.00	YK127R87	4	520	24	1570	58.34	15200	1.00	YKF77	4	96
3.0	11600	473	79900	1.10	YKF127R87	4	560	28	1380	51.18	16500	1.15	YKA77	4	81
3.4	10300	418	80600	1.25	YKA127R87	4	490	31	1210	45.16	17400	1.30	YKAF77	4	88
3.9	9040	367	81100	1.45	YKAF127R87	4	530	35	1080	40.04	18000	1.45	YKAZ77		
4.3	8120	330	81400	1.60	YKAZ127R87			37	1030	38.39	18200	1.45			
5.0	7010	287	81800	1.85				40	950	35.20	18500	1.65			
5.6	6200	253	82000	2.1				46	830	30.89	18900	1.85			
2.3	15100	610	75800	0.85	YK127R77	4	495	49	785	29.27	19000	1.95			
2.6	13600	549	78800	0.95	YKF127R77	4	540	55	690	25.62	19300	2.2			
3.0	11800	477	79800	1.10	YKA127R77	4	470	62	620	23.08	19500	2.5			
3.4	10300	418	80500	1.25	YKAF127R77	4	510	70	545	20.25	19600	2.8			
3.9	8990	364	650000	0.90	YK107R77	4	335	47	810	30.22	10400	1.00	YK67	4	64
4.5	7860	318	650000	1.00	YKF107R77	4	350	52	735	27.28	11000	1.10	YKF67	4	70
5.0	7080	286	650000	1.15	YKA107R77	4	310	59	645	24.00	11600	1.25	YKA67	4	62
5.7	6200	251	650000	1.30	YKAF107R77	4	335	63	610	22.66	11800	1.30	YKAF67	4	67
6.4	5470	222	650000	1.45	YKAZ107R77			74	520	19.30	12300	1.45	YKAZ67		
7.2	4840	196	650000	1.65				81	470	17.54	12500	1.55			
8.2	4290	174	650000	1.70				94	410	15.19	12800	1.70			
9.2	3800	154	650000	1.90				107	355	13.22	13000	1.90			
10	3440	140	650000	2.1				114	335	12.48	13000	1.60			
7.1	4930	199	40000	0.85	YK97R57	4	210	134	285	10.63	13000	1.75			
					YKF97R57	4	230	147	260	9.66	12900	1.85			
					YKA97R57	4	190	170	225	8.37	12500	1.95			
					YKAF97R57	4	215	195	196	7.28	12100	2.1			
					YKAZ97R57	4									
5.3	7220	136.14	81700	1.80	YK127	8	490	59	645	24.05	6120	0.95	YK57	4	58
5.9	6500	122.48	81900	2.0	YKF127	8	530	63	610	22.71	6160	1.00	YKF57	4	63
6.5	5850	110.18	82100	2.2	YKA127	8	460	73	520	19.34	6220	1.10	YKA57	4	56
					YKAF127	8	490	81	475	17.57	6230	1.15	YKAF57	4	62
					YKAZ127	8	500	93	410	15.22	6210	1.30	YKAZ57		
6.6	5810	146.07	82100	2.2	YK127	6	480	107	355	13.25	6150	1.45			
7.1	5420	136.14	82200	2.4	YKF127	6	520	119	320	11.92	5810	1.30			
7.8	4870	122.48	82300	2.7	YKA127	6	450	126	305	11.26	5790	1.35			
8.7	4380	110.18	82400	3.0	YKAF127	6	490	148	260	9.59	5700	1.55			
					YKAZ127	6		163	235	8.71	5640	1.65			
6.4	5960	112.41	65000	1.35	YK107	8	335	188	205	7.55	5530	1.80			
7.2	5340	100.75	65000	1.50	YKF107	8	345	216	177	6.57	5400	1.95			
7.9	4830	90.96	65000	1.65	YKA107	8	305								
8.7	4380	82.61	65000	1.85	YKAF107	8	330								
					YKAZ107	8									
6.7	5710	143.47	65000	1.40	YK107	6	325								
7.9	4830	121.46	65000	1.65	YKF107	6	335								
8.5	4470	112.41	65000	1.80	YKA107	6	295	0.79	61100	1821	170200	0.80	YK187R97	4	1790
9.5	4010	100.75	65000	2.0	YKAF107	6	320	0.89	53900	1605	183200	0.95			
11	3620	90.96	65000	2.2	YKAZ107			1.0	46700	1395	190000	1.05	YKA187R97	4	1790
9.9	3860	143.47	65000	2.1	YK107	4	300	1.2	40100	1196	190000	1.25			
12	3270	121.46	65000	2.5	YKF107	4	310	1.4	35100	1046	190000	1.45			
13	3020	112.41	65000	2.7	YKA107	4	270	1.5	31700	945	190000	1.60			
14	2710	100.75	65000	3.0	YKAF107	4	295	1.9	24800	738	190000	2.0			
16	2450	90.96	65000	3.3	YKAZ107			2.3	20800	621	190000	2.4			
17	2220	82.61	65000	3.6											
19	1970	73.30	65000	4.1				1.3	36900	1101	150000	0.85	YK167R97	4	1210
9.3	4120	153.21	40000	1.05	YK97	4	185	1.5	31700	944	150000	1.00			
10	3770	140.28	40000	1.15	YKF97	4	205	1.7	28200	843	150000	1.15	YKA167R97	4	1210
11	3330	123.93	40000	1.30	YKA97	4	165	1.9	25400	757	150000	1.25			
14	2830	105.13	40000	1.50	YKAF97	4	190	2.3	21200	632	150000	1.50			
15	2600	96.80	40000	1.65	YKAZ97			2.5	18700	561	150000	1.70			
16	2330	86.52	40000	1.85				3.0	16100	481	150000	2.0			
18	2100	77.89	40000	2.0				3.4	14100	423	150000	2.3			
20	1900	70.54	40000	2.3											

YYK系列 | 选型参数表
Selection table

输出转速 output speed na r/min	输出转矩 output torque Ma N.m	传动比 Ratio i	径向载荷 Permissible overhung load outside Fa N	使用系数 service factor fb	机型号 Type	极数 Pole	重量 weight kg	输出转速 output speed na r/min	输出转矩 output torque Ma N.m	传动比 Ratio i	径向载荷 Permissible overhung load outside Fa N	使用系数 service factor fb	机型号 Type	极数 Pole	重量 weight kg
5.5kW								5.5kW							
2.2	22100	661	109900	0.80	YK157R97	4	820	32	1660	45.16	14600	0.95	YK77	4	95
2.5	19000	567	111700	0.95	YKF157R97	4	900	36	1470	40.04	15900	1.05	YKF77	4	105
2.8	16900	504	112700	1.05	YKA157R97	4	780	46	1130	30.89	17800	1.35	YKA77	4	88
3.3	14500	434	113800	1.25	YKAF157R97	4	840	49	1070	29.27	18000	1.45	YKAF77	4	95
3.8	12700	379	114500	1.40	YKAZ157R97			56	940	25.62	18500	1.65	YKAZ77		
4.3	11100	333	115000	1.60				62	850	23.08	18800	1.85			
3.4	14100	418	77800	0.90	YK127R87	4	520	71	745	20.25	19100	2.0			
3.9	12400	367	79500	1.05	YKF127R87	4	570	80	655	17.87	19400	2.2			
4.3	11100	330	80200	1.15	YKA127R87	4	490	90	580	15.84	19200	2.4			
5.0	9620	287	80800	1.35	YKAF127R87	4	530	106	495	13.52	18600	2.7			
5.6	8510	253	81300	1.55	YKAZ127R87			116	455	12.36	17900	2.2			
6.7	7150	213	81700	1.80				132	400	10.84	17400	2.5			
7.1	6740	200	81900	1.80											
8.6	5580	166	82200	2.2				60	880	24.00	9720	0.90	YK67	4	69
9.8	4920	147	82300	2.4				63	830	22.66	10200	0.95	YKF67	4	75
6.4	7490	222	65000	1.05	YK107R77	4	345	74	710	19.30	11200	1.05	YKA67	4	67
7.3	6640	196	65000	1.20	YKF107R77	4	355	82	645	17.54	11600	1.15	YKAF67	4	72
8.2	5870	174	65000	1.25	YKA107R77	4	315	94	560	15.19	12100	1.25	YKAZ67		
9.3	5200	154	65000	1.40	YKAF107R77	4	340	108	485	13.22	12500	1.40			
10	4720	140	65000	1.55	YKAZ107R77			115	460	12.48	12600	1.15			
4.7	11100	150.41	115000	1.60	YK157	8	730	135	390	10.63	12400	1.30			
5.8	9050	122.39	115500	2.0	YKF157	8	810	148	355	9.66	12200	1.35			
7.1	7410	100.22	115900	2.4	YKA157	8	700	171	305	8.37	11900	1.45			
7.8	6780	91.65	116000	2.7	YKAF157	8	760	196	265	7.28	11600	1.55			
5.2	10100	136.14	80700	1.30	YK127	8	495	81	645	17.57	5080	0.85	YK57	4	63
5.8	9060	122.48	81100	1.45	YKF127	8	540	94	560	15.22	5210	0.95	YKF57	4	68
6.4	8150	110.18	81400	1.60	YKA127	8	465	108	485	13.25	5280	0.95	YKA57	4	61
7.9	6650	89.89	81900	1.95	YKAF127	8	500	120	440	11.92	4920	1.00	YKAF57	4	67
7.1	7450	136.14	81600	1.75	YK127	6	490	127	415	11.26	4950	1.05	YKAZ57		
7.8	6700	122.48	81900	1.95	YKF127	6	530	149	350	9.59	4990	1.15			
8.7	6030	110.18	82100	2.2	YKA127	6	460	164	320	8.71	4990	1.20			
11	4920	89.89	82300	2.6	YKAF127	6	500	190	275	7.55	4960	1.30			
8.5	6150	112.41	65000	1.30	YK107	6	335	218	240	6.57	4910	1.45			
9.5	5510	100.75	65000	1.45	YKF107	6	345								
10	5270	143.47	65000	1.50	YKA107	6	305	1.7	38200	835	190000	1.30	YK187R107	4	1860
11	4980	90.96	65000	1.60	YKAF107	6	330	2.0	33300	729	190000	1.50			
12	4520	82.61	65000	1.75	YKAZ107			2.3	28400	622	190000	1.75	YKA187R107	4	1860
13	4130	112.41	65000	1.95	YK107	4	305	1.2	55000	1196	181400	0.90	YK187R97	4	1810
14	3700	100.75	65000	2.2	YKF107	4	315	1.4	48000	1064	190000	1.05			
16	3340	90.96	65000	2.4	YKA107	4	375	1.5	43400	945	190000	1.15	YKA187R97	4	1810
17	3030	82.61	65000	2.6	YKAF107	4	300	1.9	33900	738	190000	1.45			
12	4550	123.93	40000	0.95	YK97	4	190	2.3	28500	621	190000	1.75			
14	3860	105.13	40000	1.10	YKF97	4	210	2.7	24100	527	190000	2.1			
15	3560	96.80	40000	1.20	YKA97	4	170								
17	3180	86.52	40000	1.35	YKAF97	4	195	1.7	38700	843	150000	0.85	YK167R97	4	1230
18	2860	77.89	40000	1.50	YKAZ97			1.9	34700	757	150000	0.90			
20	2590	70.54	40000	1.65				2.3	29000	632	150000	1.10	YKA167R97	4	1230
23	2300	62.55	40000	1.85				2.5	25700	651	150000	1.25			
25	2080	56.55	39700	2.1				3.0	22100	481	150000	1.45			
30	1760	47.93	38600	2.4				3.4	19400	423	150000	1.65			
17	3170	86.34	26600	0.85	YK87	4	130	3.9	16900	369	150000	1.90			
18	2910	79.34	27000	0.95	YKF87	4	140								
20	2590	70.46	27400	1.05	YKA87	4	115	3.3	19900	434	111200	0.90	YK157R97	4	840
23	2310	63.00	27500	1.15	YKAF87	4	130	3.8	17400	379	112500	1.05	YKF157R97	4	920
25	2080	56.64	27300	1.30	YKAZ87			4.3	15300	333	113500	1.20	YKA157R97	4	800
29	1810	49.16	26900	1.50				4.9	13300	291	114200	1.35	YKAF157R97	4	860
32	1620	44.02	26500	1.60											
39	1340	36.52	25800	1.85				4.3	15200	330	75500	0.85	YK127R77	4	550
46	1150	31.39	25200	2.3				5.0	13200	287	79100	1.00	YKF127R77	4	590
51	1020	27.88	24700	2.5				5.6	11600	253	79900	1.10	YKA127R77	4	520
								6.7	9790	213	80800	1.35	YKAF127R77	4	550
								7.1	9220	200	81000	1.30	YKAZ127R77		
								8.6	7640	166	81600	1.55			
								9.8	6740	147	81900	1.80			

输出转速 output speed na r/min	输出转矩 output torque Ma N.m	传动比 Ratio i	径向载荷 Permissible overhung load outputside Fa N	使用系数 service factor fb	机型号 Type	极数 Pole	重量 weight kg	输出转速 output speed na r/min	输出转矩 output torque Ma N.m	传动比 Ratio i	径向载荷 Permissible overhung load outputside Fa N	使用系数 service factor fb	机型号 Type	极数 Pole	重量 weight kg
7.5kW								7.5kW							
4.4	16400	164.50	150000	1.95	YYK167	8	1160	25	2830	56.55	37100	1.50	YYK97	4	210
5.3	13400	134.99	150000	2.4	YYKAF167	8	1160	30	2400	47.93	36400	1.80	YYKF97	4	230
								34	2100	41.87	35600	2.0	YYKA97	4	190
								37	1920	39.30	35100	2.2	YYKAF97	4	215
								42	1710	34.23	34400	2.5	YYKAZ97		
5.8	12300	164.50	150000	2.6	YYK167	6	1130	23	3160	63.00	24100	0.85	YYK87	4	150
7.1	10100	134.99	150000	3.2	YYKAF167	6	1130	25	2840	56.64	24200	0.95	YYKF87	4	160
								29	2460	49.16	24200	1.10	YYKA87	4	140
6.4	11200	150.41	114900	1.60	YYK157	6	730	32	2200	44.02	24200	1.20	YYKAF87	4	155
7.8	9130	122.39	115500	1.95	YYKF157	6	810	39	1830	36.52	23900	1.35	YYKAZ87		
9.6	7480	100.22	115900	2.4	YYKA157	6	700	46	1570	31.39	23500	1.70			
10	6840	91.65	116000	2.6	YYKAF157	6	760	51	1400	27.88	23200	1.85			
12	5950	79.75	116200	3.0	YYKAZ157			57	1250	24.92	22800	2.0			
								64	1120	22.41	22500	2.0			
7.1	10200	136.14	80600	1.30	YYK127	6	495	74	970	19.45	21900	2.4			
7.8	9140	122.48	81000	1.40	YYKF127	6	540	82	870	17.42	21500	2.5			
8.7	8220	110.18	81400	1.60	YYKA127	6	465	89	800	16.00	20600	2.2			
11	6710	89.89	81900	1.95	YYKAF127	6	500	99	725	14.45	20700	2.9			
								46	1550	30.89	15400	1.00	YYK77	4	115
9.8	7320	146.07	81700	1.80	YYK127	4	480	49	1470	29.27	16000	1.05	YYKF77	4	125
11	6820	136.14	81800	1.90	YYKF127	4	520	56	1280	25.62	17000	1.20	YYKA77	4	110
12	6130	122.48	82000	2.1	YYKA127	4	450	62	1160	23.08	17700	1.35	YYKAF77	4	115
13	5520	110.18	82200	2.4	YYKAF127	4	490	71	1010	20.25	18300	1.50	YYKAZ77		
16	4500	89.89	82400	2.9	YYKAZ127			80	890	17.87	18600	1.60			
17	4110	81.98	82500	3.2				90	795	15.84	18200	1.60			
20	3550	70.95	82600	3.7				106	675	13.52	17800	1.75			
								116	620	12.36	17000	1.80			
								132	545	10.84	16700	1.90			
10	7190	143.47	65000	1.10	YYK107	4	325	150	480	9.56	16300	2.0			
12	6080	121.46	65000	1.30	YYKF107	4	335	169	425	8.48	15900	2.1			
13	5630	112.41	65000	1.40	YYKA107	4	295	198	365	7.24	15400	2.3			
14	5050	100.75	65000	1.60	YYKAF107	4	320								
16	4560	90.96	64200	1.75	YYKAZ107			1.7	55900	835	179700	0.90	YYK187R107	4	1870
17	4140	82.61	63200	1.95				2.0	48800	729	190000	1.05			
20	3670	73.30	61900	2.2				2.3	41600	622	190000	1.20	YYKA187R107	4	1870
22	3330	66.52	60900	2.4				2.8	34800	520	190000	1.45			
25	2860	57.17	59100	2.8				3.2	30400	454	190000	1.65			
29	2500	49.90	57500	3.1				4.1	23800	335	190000	2.1			
34	2120	42.33	55500	3.5				2.0	49600	738	190000	1.00	YYK187R97	4	1830
39	1850	37.00	53800	3.9				2.3	41700	621	190000	1.20			
								2.7	35300	527	190000	1.40	YYKA187R97	4	1830
15	4850	96.80	38300	0.90	YYK97	4	210	4.5	21300	318	150000	1.50	YYK167R107	4	1290
17	4330	86.52	38300	1.00	YYKF97	4	230	5.2	18600	278	150000	1.70			
18	3900	77.89	38100	1.10	YYKA97	4	190	5.9	16300	244	150000	1.95	YYKA167R107	4	1290
20	3530	70.54	37900	1.20	YYKAF97	4	215	6.8	14200	213	150000	2.2			
23	3130	62.55	37500	1.35	YYKAZ97			7.0	13700	206	150000	2.3			

YYK系列 | 选型参数表
Selection table

115

输出转速 output speed na r/min	输出转矩 output torque Ma N.m	传动比 Ratio i	径向载荷 Permissible overhung load outside Fa N	使用系数 service factor fb	机型号 Type	极数 Pole	重量 weight kg	输出转速 output speed na r/min	输出转矩 output torque Ma N.m	传动比 Ratio i	径向载荷 Permissible overhung load outside Fa N	使用系数 service factor fb	机型号 Type	极数 Pole	重量 weight kg
11kW								11kW							
2.6	37500	561	150000	0.85	YK167R97	4	1250	33	3210	44.02	20000	0.80	YK87	4	165
3.0	32300	481	150000	1.00				39	2660	36.52	20400	0.95	YKF87	4	175
3.4	28300	423	150000	1.15	YKA167R97	4	1250	46	2290	31.39	20600	1.20	YKA87	4	150
3.9	24700	369	150000	1.30				52	2030	27.88	20600	1.30	YKAF87	4	165
								58	1820	24.92	20500	1.40	YKAZ87		
4.3	22300	333	109700	0.80	YK157R97	4	850	64	1630	22.41	20300	1.40			
4.9	19500	291	111400	0.90	YKF157R97	4	930	74	1420	19.45	20100	1.60			
					YKA157R97	4	820	83	1270	17.42	19800	1.75			
					YKAF157R97	4	870	90	1170	16.00	18800	1.55			
					YKAZ157R97	4	560	100	1050	14.45	19400	2.0			
6.8	14300	213	77400	0.90	YK127R87	4	600	115	920	12.56	18900	2.2			
7.2	13500	200	78900	0.90	YKF127R87	4	600	129	810	11.17	18000	1.85			
8.7	11200	166	80100	1.10	YKA127R87	4	530	144	730	10.00	17700	2.1			
9.8	9850	147	80700	1.20	YKAF127R87	4	570	174	605	8.29	17100	2.3			
					YKAZ127R87	4	1230	200	525	7.21	16700	2.5			
5.3	19700	134.99	150000	1.60	YK167	8	1230	62	1680	23.08	14400	0.90	YK77	4	130
6.6	16000	109.99	150000	2.0	YKAF167	8	1230	71	1680	20.25	15900	1.00	YKF77	4	135
								81	1300	17.87	16600	1.10	YKA77	4	120
5.8	18000	164.50	150000	1.80	YK167	6	1160	91	1160	15.84	16500	1.20	YKAF77	4	130
7.1	14800	134.99	150000	2.2	YKAF167	6	1160	107	990	13.52	16300	1.35	YKAZ77		
								117	900	12.36	15500	1.10			
8.8	12000	164.50	150000	2.7	YK167	4	1130	133	790	10.84	15300	1.25			
11	9850	134.99	150000	2.2	YKAF167	4	1130	151	700	9.56	15100	1.35			
								170	620	8.48	14800	1.45			
								199	530	7.24	14500	1.55			
5.9	17900	122.39	112300	1.00	YK157	8	830	15kW							
7.2	14600	100.22	113700	1.25	YKF157	8	910	2.3	56100	622	179400	0.90	YK187R107	4	1920
7.9	13400	91.65	114200	1.35	YKA157	8	800	2.8	47000	520	190000	1.05			
9.0	11600	79.75	114800	1.55	YKAF157	8	850	3.2	41000	454	190000	1.20	YKA187R107	4	1920
					YKAZ157	8	770	4.1	32100	355	190000	1.55			
6.4	16500	150.41	112900	1.10	YK157	6	770	5.6	23600	261	190000	2.1			
7.8	13400	122.39	114200	1.35	YKF157	6	850	4.6	28700	318	150000	1.10	YK167R107	4	1330
9.6	11000	100.22	115000	1.65	YKA157	6	730	5.3	25000	278	150000	1.30			
10	10000	91.65	115300	1.80	YKAF157	6	790	6.0	22000	244	150000	1.45	YKA167R107	4	1300
12	8730	79.75	115600	2.1	YKAZ157			6.8	19200	213	150000	1.65			
9.6	11000	150.41	115000	1.65	YK157	4	730	7.1	18500	206	150000	1.75			
12	8930	122.39	115600	2.0	YKF157	4	810	8.1	16200	180	150000	1.95			
14	7310	100.22	115900	2.5	YKA157	4	700	9.1	14400	160	150000	2.2			
16	6690	91.65	116000	2.7	YKAF157	4	760								
					YKAZ157	4	760	6.3	20700	230	110700	0.85	YK157R107	4	940
11	9930	136.41	80700	1.30	YK127	4	495	6.9	19200	213	111600	0.95	YKF157R107	4	1020
12	9830	122.48	81100	1.45	YKF127	4	540	7.8	16800	187	112800	1.05	YKA157R107	4	900
13	8040	110.18	81400	1.60	YKA127	4	465	9.3	14200	157	113900	1.25	YKAF157R107	4	960
16	6560	89.89	81900	2.0	YKAF127	4	500	12	11000	122	115000	1.65	YKAZ157R107		
18	5980	81.98	82100	2.2	YKAZ127			14	9630	107	115400	1.85			
20	5180	70.95	82300	2.5											
13	8200	112.41	58400	1.00	YK107	4	340	5.4	26600	179.86	190000	1.90	YK187	6	1810
14	7350	100.75	58300	1.10	YKF107	4	350	5.9	24400	165.21	190000	2.0	YKA187	6	1810
16	6630	90.96	58000	1.20	YKA107	4	310								
17	6030	82.61	57500	1.35	YKAF107	4	335	7.2	19900	134.99	150000	1.60	YK167	6	1230
20	5350	73.30	56900	1.50	YKAZ107			8.8	16200	109.83	150000	1.95	YKA167	6	1230
22	4850	66.52	56200	1.65											
25	4170	57.17	55100	1.90											
29	3640	49.90	54000	2.2				8.9	16100	164.50	150000	2.0	YK167	4	1160
34	3090	42.33	52500	2.4				11	13200	134.99	150000	2.4	YKA167	4	1160
39	2700	37.00	51200	2.7											
20	5150	70.54	32200	0.85	YK97	4	225	7.9	18100	122.39	112200	1.00	YK157	6	830
23	4560	62.55	32500	0.95	YKF97	4	245	9.7	14800	100.22	113700	1.20	YKF157	6	910
25	4130	56.55	32500	1.05	YKA97	4	205	11	13500	91.65	114100	1.35	YKA157	6	800
30	3500	47.93	32500	1.25	YKAF97	4	230	12	11800	79.75	114800	1.55	YKAF157	6	850
34	3050	41.87	32200	1.40	YKAZ97			14	10400	70.38	115200	1.75	YKAZ157		
38	2790	38.30	32000	1.55											
42	2500	34.23	31600	1.70				9.7	14800	150.41	113700	1.20	YK157	4	770
47	2250	30.82	31300	1.90				12	12000	122.39	114800	1.50	YKF157	4	850
52	2040	27.91	30800	2.1				15	9830	100.22	114200	1.85	YKA157	4	730
58	1800	24.75	30300	2.4				16	8990	91.65	112500	2.0	YKAF157	4	790
64	1630	22.37	29800	2.6				18	7820	79.75	109600	2.3	YKAZ157		

输出转速 output speed na r/min	输出转矩 output torque Ma N.m	传动比 Ratio i	径向载荷 Permissible overhung load outputside Fa N	使用系数 service factor fb	机型号 Type	极数 Pole	重量 weight kg	输出转速 output speed na r/min	输出转矩 output torque Ma N.m	传动比 Ratio i	径向载荷 Permissible overhung load outputside Fa N	使用系数 service factor fb	机型号 Type	极数 Pole	重量 weight kg
15kW								18.5kW							
11	13400	136.14	79000	0.95	YYK127	4	530	8.1	21700	179.86	190000	2.3	YYK187	4	1970
12	12000	122.48	79700	1.10	YYKF127	4	570	8.9	19900	165.21	190000	2.5			
13	10800	110.18	80300	1.20	YYKA127	4	500	10	17400	144.59	190000	2.9	YYKA187	4	1970
16	8820	89.89	81200	1.45	YYKAF127	4	540	11	15600	129.69	190000	3.2			
18	8040	81.98	81400	1.60	YYKAZ127										
21	6960	70.95	81600	1.85				11	16300	134.99	150000	1.95	YYK167	4	1210
23	6140	62.60	80000	2.1				13	13200	109.83	150000	2.4			
27	5300	54.07	78000	2.5				17	10600	87.86	150000	3.0	YYKA167	4	1210
31	4690	47.82	76200	2.8											
16	8920	90.96	50900	0.90	YYK107	4	380	9.7	18300	100.22	112100	1.00	YYK157	6	870
18	8110	82.16	51100	1.00	YYKF107	4	390	11	16700	91.65	112800	1.10	YYK157	6	950
20	7190	73.30	51200	1.10	YYKA107	4	350	12	14500	79.75	111500	1.25	YYKAF157	6	830
22	6530	66.52	51000	1.25	YYKAF107	4	375	14	12800	70.38	109900	1.40	YYKAZ157	6	890
26	5610	57.17	50600	1.45	YYKAZ107										
29	4900	49.90	50000	1.60				12	14800	122.39	111600	1.20	YYK157	4	820
34	4150	42.33	49100	1.75				15	12100	100.22	109100	1.50	YYKF157	4	900
39	3630	37.00	48200	2.0				16	11100	91.65	107800	1.65	YYKA157	4	780
45	3210	32.69	47300	2.2				18	9620	79.75	105600	1.85	YYKAF157	4	840
47	3070	31.27	47000	2.2				21	8490	70.38	103400	2.1	YYKAZ157		
50	2840	29.00	46400	2.5				24	7360	61.02	100700	2.5			
30	4700	47.93	28100	0.90	YYK97	4	265	27	6550	54.29	98500	2.8			
35	4110	41.87	28400	1.05	YYKF97	4	285	31	5640	46.79	95500	3.2			
38	3760	38.30	28500	1.15	YYKA97	4	245	39	4580	38.02	91300	3.9			
43	3360	34.23	28500	1.30	YYKAF97	4	270								
47	3020	30.82	28400	1.40	YYKAZ97			13	13300	110.18	79000	1.00	YYK127	4	580
52	2740	27.91	28300	1.55				16	10800	89.89	79000	1.20	YYKF127	4	620
59	2460	24.75	28000	1.75				18	9800	81.98	78500	1.30	YYKA127	4	550
65	2190	22.37	27700	1.95				21	8560	70.95	77500	1.50	YYKAF127	4	590
77	1860	18.96	27200	2.3				23	7550	62.60	76400	1.70	YYKAZ127		
88	1620	16.56	26600	2.7				27	6520	54.07	74800	2.0			
47	3080	31.39	17300	0.90	YYK87	4	205	31	5770	47.82	73400	2.2			
52	2730	27.88	17600	0.95	YYKF87	4	215	36	4850	40.19	69900	2.7			
59	2440	24.92	17800	1.00	YYKA87	4	190	40	4370	36.25	68000	3.0			
65	2200	22.41	18000	1.05	YYKAF87	4	205	47	3780	31.37	68000	3.4			
75	1910	19.45	18000	1.20	YYKAZ87			53	3340	27.68	66200	3.9			
84	1710	17.42	18000	1.30											
91	1570	16.00	17800	1.55				20	8840	73.30	46300	0.90	YYK107	4	430
101	1420	14.45	17800	1.50				22	8020	66.52	46600	1.00	YYKF107	4	440
116	1230	12.56	17600	1.60				26	6890	57.19	46800	1.15	YYKA107	4	400
131	1100	11.17	16600	1.35				29	6020	49.90	46700	1.30	YYKAF107	4	425
146	980	10.00	16400	1.55				35	5100	42.33	46300	1.45	YYKAZ107		
176	810	8.29	16000	1.70				40	4460	37.00	45700	1.60			
202	705	7.21	15700	1.85				45	3940	32.69	45100	1.80			
18.5kW								47	3770	31.28	44900	1.85			
2.8	57800	520	176300	0.85				51	3500	29.00	44400	2.1			
3.2	50400	454	189200	1.00	YYK187R107	4	1970	56	3170	26.32	43800	2.3			
4.1	39500	355	190000	1.25				65	2730	22.62	42700	2.6			
5.6	29000	261	190000	1.70	YYKA187R107	4	1970	74	2380	19.74	41700	3.0			
6.6	24600	221	190000	2.0				88	2020	16.75	40400	3.5			
4.6	35300	318	150000	0.90											
5.3	30800	278	150000	1.05	YYK167R107	4	1380	35	5050	41.87	25100	0.85	YYK97	4	315
6.0	27100	244	150000	1.20				48	3720	30.82	26000	1.15	YYKF97	4	335
6.9	23600	213	150000	1.35	YYKA167R107	4	1380	53	3360	27.91	26000	1.30	YYKA97	4	395
7.1	22800	206	150000	1.40				59	2980	24.75	26000	1.45	YYKAF97	4	320
8.1	20000	180	150000	1.60				65	2700	22.37	25900	1.60	YYKAZ97		
9.2	17700	160	150000	1.80				77	2290	18.96	25700	1.90			
11	15000	135	150000	2.1				88	2000	16.56	25300	2.2			
12	13100	118	150000	2.4				106	1670	13.85	24800	2.6			
								122	1450	11.99	24300	2.7			
7.8	20700	187	110700	0.85	YYK157R107	4	990								
9.3	17400	157	112500	1.05	YYKF157R107	4	1070	59	3000	24.92	15600	0.85	YYK87	4	255
12	13600	122	114100	1.35	YYKA157R107	4	950	65	2700	22.41	15900	0.82	YYKF87	4	265
14	11900	107	112300	1.50	YYKAF157R107	4	1010	75	2340	19.45	16200	1.00	YYKA87	4	240
								84	2100	17.42	16400	1.05	YYKAF87	4	255
5.4	32800	179.86	190000	1.55	YYK187	6	1850	101	1740	14.45	16500	1.20	YYKAZ87		
5.9	30100	165.21	190000	1.65				117	1510	12.56	16400	1.30			
6.7	26300	144.59	190000	1.90	YYKA187	6	1850	131	1350	11.17	15400	1.10			
7.5	23600	129.69	190000	2.1				147	1210	10.00	15300	1.25			
								177	1000	8.29	15100	1.40			
								203	870	7.21	14900	1.50			

YYK系列 | 选型参数表

Selection table

117

输出转速 output speed na r/min	输出转矩 output torque Ma N.m	传动比 Ratio i	径向载荷 Permissible overhung load outside Fa N	使用系数 service factor fb	机型号 Type	极数 Pole	重量 weight kg	输出转速 output speed na r/min	输出转矩 output torque Ma N.m	传动比 Ratio i	径向载荷 Permissible overhung load outside Fa N	使用系数 service factor fb	机型号 Type	极数 Pole	重量 weight kg	
22kW								22kW								
3.2	60000	454	172300	0.85	YK187R107	4	1980	40	5310	37.00	43200	1.35	YK107	4	445	
4.1	47000	355	190000	1.05				45	4690	32.69	42900	1.55	YKF107	4	455	
5.6	34500	261	190000	1.45	YKA187R107	4	1980	47	4490	31.28	42800	1.50	YKA107	4	415	
6.6	29300	221	190000	1.70				51	4160	29.00	42500	1.75	YKAF107	4	440	
7.6	25600	193	190000	1.95				56	3770	26.32	42000	1.90	YKAZ107			
8.9	21600	163	190000	2.3				65	3240	22.62	41200	2.2				
								74	2830	19.74	40400	2.2				
5.3	36700	278	150000	0.85	YK167R107	4	1400	88	2400	16.75	39300	2.5				
6.0	32200	244	150000	1.00				100	2100	14.64	38400	2.6				
6.9	28200	213	150000	1.15	YKA167R107	4	1400	109	1930	13.43	36800	2.9				
7.1	27200	206	150000	1.20				125	1680	11.73	35900	2.9				
8.1	23800	180	150000	1.35				147	1430	9.94	34800	3.3				
9.2	21100	160	150000	1.50												
11	17900	135	150000	1.80				48	4420	30.82	23500	0.95	YK97	4	330	
12	15600	118	150000	2.0				53	4000	27.91	23800	1.05	YKF97	4	350	
								59	3550	24.75	24100	1.20	YKA97	4	310	
93	20800	157	109800	0.85	YK157R107	4	1000	65	3210	22.37	24200	1.35	YKAF97	4	335	
12	16200	122	108600	1.10	YKF157R107	4	1080	77	2720	18.96	24100	1.60	YKAZ97			
14	14100	107	107300	1.25	YKA157R107	4	970	88	2370	16.56	24000	1.80				
								106	1990	13.85	23700	1.90				
5.4	39000	179.86	190000	1.30	YK187	6	1860	122	1720	11.99	23300	2.1				
5.9	35800	165.21	190000	1.40				141	1490	10.41	21800	2.2				
6.7	31300	144.59	190000	1.60	YKA187	6	1860	168	1250	8.71	21300	2.3				
7.5	28100	129.69	190000	1.80												
8.6	24400	112.60	190000	2.0				75	2790	19.45	14400	0.80	YK87	4	270	
								84	2500	17.42	14800	0.90	YKF87	4	280	
8.1	25800	179.86	190000	1.95	YK187	4	1810	101	2070	14.4	15100	0.95	YKA87	4	255	
8.9	23700	165.21	190000	2.1				117	1800	12.56	15300	1.00	YKAF87	4	270	
10	20700	144.59	190000	2.4	YKA187	4	1810	131	1600	11.17	14200	1.05	YKAF87			
11	18600	129.69	190000	2.7				147	1430	10.00	14200	1.10				
								177	1190	8.29	14300	1.20				
11	19400	134.99	150000	1.65	YK167	4	1230	203	1030	7.21	14200	1.25				
13	15700	109.83	150000	2.0												
17	12600	87.86	150000	2.5	YKA167	4	1230									
19	11200	78.14	150000	2.9												
9.7	21700	100.22	105900	0.85	YK157	6	880									
11	19900	91.65	105900	0.90	YKF157	6	960	5.6	47000	261	190000	1.05	YK187R107	4	2030	
12	17300	79.75	105500	1.05	YKA157	6	850	6.6	39800	221	190000	1.25				
14	15200	70.38	104600	1.20	YKAF157	6	910	7.6	34800	193	190000	1.45	YKA187R107	4	2030	
16	13200	61.20	103300	1.35	YKAZ157			9.0	29400	163	190000	1.70				
12	17600	122.39	105500	1.05	YK157	4	830	6.9	38300	213	150000	0.85	YK167R107	4	1450	
15	14400	100.22	104100	1.25	YKF157	4	910	7.1	37000	206	150000	0.85				
16	13100	91.65	103200	1.35	YKA157	4	800	8.1	32400	180	150000	1.00	YKA167R107	4	1450	
18	11400	79.75	101600	1.55	YKAF157	4	850	9.2	28700	160	150000	1.10				
21	10100	70.38	99800	1.80	YKAZ157			11	24400	135	150000	1.30				
24	8750	61.02	97700	2.1				12	21300	118	150000	1.50				
27	7790	54.29	95800	2.3												
31	6710	46.79	93200	2.7				8.2	35100	179.86	190000	1.45	YK187	4	1860	
39	5450	38.02	89400	3.3				8.9	32200	165.21	190000	1.55				
								10	28200	144.59	190000	1.75	YKA187	4	1860	
16	12900	89.89	73900	1.00	YK127	4	600	11	25300	129.69	190000	2.0				
18	11800	81.98	73800	1.10	YKF127	4	640	13	21900	112.60	190000	2.3				
21	10200	70.95	73400	1.30	YKA127	4	570	14	19900	102.16	190000	2.5				
23	8980	62.60	72800	1.45	YKAF127	4	600	17	17200	88.00	190000	2.9				
27	7750	54.07	71700	1.70	YKAZ127											
31	6860	47.82	70700	1.90				13	21400	109.83	150000	1.50	YK167	4	1280	
36	5760	40.19	69000	2.3				17	17100	87.86	150000	1.85				
40	5200	36.25	67800	2.5				19	15200	78.14	150000	2.1	YKA167	4	1280	
47	4500	31.37	66200	2.9				22	13300	68.0	150000	2.4				
53	3970	27.68	64600	3.3				24	11800	60.74	150000	2.7				
61	3430	23.91	62800	3.8												
69	3030	21.15	61200	4.3				15	19500	100.22	92700	0.90	YK157	4	880	
								16	17900	91.65	92800	1.00	YKF157	4	960	
26	8200	57.17	43000	1.00	YK107	4	445	18	15500	79.7	92400	1.15	YKA157	4	850	
29	7160	49.90	43300	1.10	YKF107	4	455	21	13700	70.38	91800	1.30	YKAF157	4	910	
35	6070	42.33	43400	1.20	YKA107	4	415	24	11900	61.02	90700	1.50	YKAZ157			
								27	10600	54.29	89500	1.70				
								31	9120	46.79	87800	1.95				
								39	7410	38.02	85100	2.4				
								47	6100	31.30	82200	3.0				

YYK系列 | 选型参数表
Selection table

119

输出转速 output speed na r/min	输出转矩 output torque Ma N.m	传动比 Ratio i	径向载荷 Permissible overhung load outsidside Fa N	使用系数 service factor fb	机型号 Type	极数 Pole	重量 weight kg	输出转速 output speed na r/min	输出转矩 output torque Ma N.m	传动比 Ratio i	径向载荷 Permissible overhung load outsidside Fa N	使用系数 service factor fb	机型号 Type	极数 Pole	重量 weight kg
45kW								75kW							
51	8480	29.00	25600	0.85	YK107	4	570	39	18400	38.02	60800	1.00	YK157	4	1220
56	7690	26.32	28300	0.95	YKF107	4	590	47	15100	31.30	62200	1.20	YKF157	4	1300
65	6610	22.62	31000	1.10	YKA107	4	550	54	13400	27.62	62600	1.35	YKA157	4	1190
74	5770	19.74	31700	1.25	YKAF107	4	570	62	11600	23.95	62600	1.55	YKAF157	4	1250
88	4890	16.75	31900	1.45	YKAZ107			69	10300	21.31	62400	1.75	YKAZ157		
100	4280	14.64	31900	1.60				81	8890	18.37	61800	2.0			
109	3930	13.43	29900	1.10				99	7220	14.92	60500	2.5			
125	3430	11.73	29900	1.25				117	6120	12.65	59300	2.8			
148	2910	9.94	29600	1.45				47	15200	31.37	39200	0.85	YK127	4	990
169	2540	8.69	29300	1.60				53	13400	27.68	40800	0.95	YKF127	4	1030
55kW								90kW							
10	51500	144.59	187400	0.95	YK187	4	2070	62	11600	23.91	42200	1.10	YKA127	4	960
11	46200	129.69	190000	1.10				70	10200	21.15	42900	1.25	YKAF127	4	1000
13	40100	112.60	188500	1.25	YKA187	4	2070	83	8600	17.77	43500	1.50	YKAZ127		
14	36400	102.16	187100	1.35				103	6940	14.35	43700	1.75			
17	31300	88.00	184200	1.60				116	6190	12.79	41100	1.40			
20	26300	73.96	180200	1.90				138	5200	10.74	41000	1.55			
23	22800	64.04	176300	2.2				171	4200	8.68	40400	1.70			
17	31300	87.86	145300	1.00	YK167	4	1490	14	59300	102.16	151300	0.85	YK187	4	2280
19	27800	78.14	144600	1.15				17	51100	88.00	153400	1.00			
22	24200	68.07	143300	1.30	YKA167	4	1490	20	42900	73.96	154200	1.15	YKA187	4	2280
24	21600	60.74	141700	1.50				23	37200	64.04	153800	1.35			
28	18400	51.77	139100	1.75				28	31000	53.36	152200	1.60			
34	15300	42.89	135400	2.1				33	26400	45.50	149900	1.90			
40	13000	36.61	131900	2.5				35	24700	42.51	148700	2.0			
24	21700	61.02	69000	0.85	YK157	4	1090	38	22400	38.57	146900	2.2			
27	19300	54.29	70200	0.95	YKF157	4	1170	22	39500	68.07	115100	0.80	YK167	4	1690
32	16700	46.79	71200	1.10	YKA157	4	1050	24	35300	60.74	116600	0.90			
39	13500	38.02	71500	1.35	YKAF157	4	1110	29	30100	51.77	117600	1.05	YKA167	4	1690
47	11100	31.30	71000	1.60				35	24900	42.89	117600	1.30			
53	9840	27.62	70400	1.85				40	21300	36.61	116700	1.50			
62	8530	23.95	69400	2.1				46	18700	32.25	115500	1.70			
69	7590	21.31	68400	2.4				51	16700	28.77	114200	1.90			
80	6540	18.37	67000	2.8				60	14200	24.52	111900	2.2			
99	5310	14.92	64800	3.4				73	11800	20.32	108800	2.7			
117	4510	12.65	62900	3.8				85	10100	17.34	106000	3.2			
37	14300	40.19	47400	0.90	YK127	4	850	39	22100	38.02	52700	0.80	YK157	4	1300
47	11200	31.37	49300	1.15	YKF127	4	890	47	18200	31.30	55500	1.00	YKF157	4	1380
53	9850	27.68	49700	1.30	YKA127	4	820	54	16000	27.62	56700	1.10	YKA157	4	1260
62	8510	23.91	49900	1.55	YKAF127	4	860	62	13900	23.95	57500	1.30	YKAF157	4	1320
70	7530	21.15	49800	1.75	YKAZ127	4	860	69	12400	21.31	57900	1.45	YKAZ157		
83	6330	17.77	49300	2.0				81	10700	18.37	57900	1.70			
103	5110	14.35	48300	2.4				99	8670	14.92	57400	2.1			
115	4550	12.79	45900	1.85				117	7350	12.65	56600	2.3			
137	3830	10.74	45000	2.1				62	13900	23.91	36400	0.95	YK127	4	1070
170	3090	8.68	43600	2.3				70	12300	21.15	37800	1.05	YKF127	4	1110
75kW								110kW							
11	62800	129.69	164100	0.80	YK187	4	2200	17	62300	88.00	136000	0.80	YK187	4	2460
13	54500	112.60	166100	0.90				20	52300	73.96	139500	0.95			
14	49400	102.16	166600	1.00	YKA187	4	2200	23	45300	64.04	141000	1.10	YKA187	4	2460
17	42600	88.00	166600	1.15				28	37700	53.36	141500	1.30			
20	35800	73.96	165300	1.40				33	32200	45.50	140800	1.55			
23	31000	64.04	163400	1.60				35	30100	42.51	140200	1.65			
28	25800	53.36	160100	1.95				39	27300	38.57	139100	1.85			
33	22000	45.50	156700	2.3				45	23500	33.23	137000	2.1			
19	37800	78.14	126100	0.85	YK167	4	1620	53	19800	27.92	134000	2.5			
22	32900	68.07	127100	0.95				29	36600	51.77	105500	0.85	YK167	4	1880
24	29400	60.74	127300	1.10	YKA167	4	1620	35	30300	42.89	107500	1.05			
29	25100	51.77	126800	1.30				41	25900	36.61	108100	1.25	YKA167	4	1880
35	20800	42.89	125200	1.55				46	22800	32.25	107900	1.40			
40	17700	36.61	123200	1.80				52	20400	28.77	107400	1.55			
46	15600	32.25	121300	2.0				61	17300	24.52	106100	1.85			
51	13900	28.77	119300	2.3				73	14400	20.32	104000	2.2			
60	11900	24.52	116300	2.7				86	12300	17.34	101800	2.6			

输出转速 output speed na r/min	输出转矩 output torque Ma N.m	传动比 Ratio i	径向载荷 Permissible overhung load outputside Fu N	使用系数 service factor fb	机型号 Type	极数 Pole	重量 weight kg	输出转矩 output torque Ma N.m	输出转速 output speed na r/min	传动比 Ratio i	径向载荷 Permissible overhung load outputside Fu N	机型号 Type	功率 Power kw/tp	重量 weight kg
110kW														
62	16900	23.95	50800	1.05	YYK157	4	1490	200	0.20	6832	5640	YYK37R17	0.12	19
70	15100	21.31	51900	1.20	YYKF157	4	1560		0.23	5922	5640	YYKF37R17	0.12	22
81	13000	18.37	52700	1.40	YYKA157	4	1450		0.25	5491	5640	YYKA37R17	0.12	19
100	10600	14.92	53100	1.70	YYKAF157	4	1510		0.29	4759	5640	YYKAF37R17	0.12	21
117	8950	12.65	53000	1.90	YYKAZ157				0.33	4160	5640	YYKAZ37R17		
132kW														
20	62800	73.96	123300	0.80	YYK187	4	2560		0.38	3645	5640			
23	54400	64.04	127000	0.90					0.43	3205	5640			
28	45300	53.36	129800	1.10	YYKA187	4	2560		0.49	2801	5640			
33	38600	45.50	130800	1.30					0.56	2454	5640			
35	36100	42.51	130900	1.40					0.64	2166	5640			
39	32700	38.57	130700	1.55					0.73	1891	5640			
45	28200	33.23	129800	1.75					0.83	1660	5640			
53	23700	27.92	127900	2.1					0.94	1466	5640			
61	20500	24.18	125900	2.3					1.1	1288	5640			
74	17100	20.15	122800	2.6					1.2	1136	5640			
86	14600	17.18	119700	2.8					1.4	996	5640			
									1.6	876	5640			
									1.8	761	5640			
									2.1	671	5640			
35	36400	42.89	96400	0.90	YYK167	4	1980		2.4	585	5640			
41	31100	36.61	98600	1.05					2.7	512	5640			
46	27400	32.25	99600	1.15	YYKA167	4	1980		3.1	451	5640			
52	24400	28.77	99900	1.30					3.5	396	5640			
61	20800	24.52	99800	1.55					4.0	346	5640			
73	17200	20.32	98700	1.85										
86	14700	17.34	97300	2.2					4.3	304	5640	YYK37R17	0.18	19
									4.9	267	5640	YYKF37R17	0.18	21
62	20300	23.95	43400	0.90	YYK157	4	1590		5.7	234	5640	YYKA37R17	0.18	19
70	18100	21.31	45300	1.00	YYKF157	4	1660		6.4	205	5640	YYKAF37R17	0.18	19
81	15600	18.37	47000	1.15	YYKA157	4	1550					YYKAZ37R17	0.18	20
100	12700	14.92	48500	1.40	YYKAF157	4	1610		7.2	181	5640	YYK37R17	0.25	20
117	10700	12.65	49100	1.60	YYKAZ157				8.1	160	5640	YYKF37R17	0.25	22
160kW														
28	54900	53.36	114900	0.90	YYK187	4	2560		9.5	136	5640	YYKA37R17	0.25	19
33	46800	45.50	118100	1.05					10	127	5640	YYKAF37R17	0.25	21
45	34200	33.23	120500	1.45	YYKA187	4	2560					YYKAZ37R17		
53	28700	27.92	120100	1.75					12	110	5640	YYK37R17	0.37	21
61	24900	24.18	119100	1.90					14	96	5640	YYKF37R17	0.37	23
74	20700	20.15	117200	2.1								YYKA37R17	0.37	20
86	17700	17.18	114900	2.3								YYKAF37R17	0.37	22
								400	0.14	10138	5920	YYKAZ37R17	0.37	20
									0.16	8534	5920	YYK47R37	0.12	34
									0.18	7662	5920	YYKF47R37	0.12	37
41	37700	36.61	86500	0.85	YYK167	4	1980		0.20	6826	5920	YYKA47R37	0.12	33
61	25200	24.52	91700	1.25					0.23	5983	5920	YYKAF47R37	0.12	36
73	20900	20.32	92000	1.55	YYKA167	4	1980		0.27	5159	5920	YYKAZ47R37		
86	17800	17.34	91600	1.80					0.30	4601	5920			
									0.35	3940	5920			
81	18900	18.37	39800	0.95	YYK157	4	1590		0.40	3477	5920			
100	15400	14.92	42600	1.15	YYKF157	4	1660		0.45	3043	5920			
117	13000	12.65	44100	1.30	YYKA157	4	1550		0.51	2733	5920			
200kW														
33	58500	45.50	100000	0.85	YYK187	4	2560		0.59	2354	5920			
45	42700	33.23	107300	1.15					0.67	2063	5920			
53	35900	27.92	109000	1.40	YYKA187	4	2560		0.76	1819	5920			
61	31100	24.18	109500	1.55					0.87	1586	5920			
74	25900	20.15	109100	1.70					0.99	1388	5920			
86	22100	17.18	108100	1.85					1.1	1222	5920			
									1.3	1097	5920			
									1.5	945	5920			
61	31500	24.52	80100	1.00	YYK167	4	1980		1.7	831	5920			
73	26100	20.32	82400	1.20					1.9	718	5920			
86	22300	17.34	83400	1.45	YYKA167	4	1980		2.2	639	5920			
100	19200	14.92	34200	0.95	YYK157	4	1590		2.4	552	5920	YYK47R37	0.18	33
117	16300	12.65	36900	1.05	YYKF157	4	1660		2.7	495	5920	YYKF47R37	0.18	36
					YYKA157	4	1550		3.1	426	5920	YYKA47R37	0.18	32
					YYKAF157	4	1550					YYKAF47R37	0.18	35
					YYKAZ157	4	1610					YYKAZ47R37	0.18	35
									3.5	375	5920	YYK47R37	0.25	34
									4.0	327	5920	YYKF47R37	0.25	37
									4.5	289	5920	YYKA47R37	0.25	37
												YYKAF47R37	0.25	33
												YYKAZ47R37	0.25	36

输出转矩 output torque Ma N.m	输出转速 output speed na r/min	传动比 Ratio i	径向载荷 Permissible overhung load outputside Fa N	机型号 Type	功率 Power kw/tp	重量 weight kg	输出转矩 output torque Ma N.m	输出转速 output speed na r/min	传动比 Ratio i	径向载荷 Permissible overhung load outputside Fa N	机型号 Type	功率 Power kw/tp	重量 weight kg	
1550	4.3	328	15400	YK77R57	1.1	79	4300	0.36	3583	40000	YK97R57	0.25	180	
	4.8	290	15400	YK77R57	1.1	87		0.42	3108	40000	YK97R57	0.25	200	
	5.6	252	15400	YK77R57	1.1	72					YK97R57	0.25	160	
				YK77R57	1.1	79					YK97R57	0.25	185	
	0.09	14829	27300	YK87R57	0.12	120		0.50	2757	40000	YK97R57	0.37	180	
	0.10	13168	27300	YK87R57	0.12	130		0.57	2419	40000	YK97R57	0.37	200	
	0.12	11737	27300	YK87R57	0.12	105		0.32	2123	40000	YK97R57	0.37	165	
	0.14	10217	27300	YK87R57	0.12	120					YK97R57	0.37	190	
	0.15	9073	27300					0.73	1856	40000	YK97R57	0.55	180	
	0.18	7854	27300					0.84	1625	40000	YK97R57	0.55	205	
	0.20	6832	27300					0.95	1430	40000	YK97R57	0.55	165	
	0.23	5930	27300					1.1	1261	40000	YK97R57	0.55	190	
	0.26	5240	27300											
	0.30	4562	27300					1.2	1102	40000	YK97R57	0.75	185	
								1.4	957	40000	YK97R57	0.75	205	
	0.33	4037	27300	YK87R57	0.18	120					YK97R57	0.75	165	
	0.37	3609	27300	YK87R57	0.18	130					YK97R57	0.75	190	
	0.42	3107	27300	YK87R57	0.18	105		1.6	855	40000	YK97R57	1.1	190	
	0.48	2728	27300	YK87R57	0.18	120		1.9	743	40000	YK97R57	1.1	210	
								2.2	652	40000	YK97R57	1.1	170	
	0.55	2371	27300	YK87R57	0.25	120					YK97R57	1.1	195	
	0.62	2088	27300	YK87R57	0.25	130		2.5	573	40000	YK97R57	1.5	190	
	0.70	1854	27300	YK87R57	0.25	105		2.8	504	40000	YK97R57	1.5	210	
				YK87R57	0.25	120					YK97R57	1.5	170	
	0.83	1657	27300	YK87R57	0.37	120					YK97R57	1.5	195	
	0.97	1415	27300	YK87R57	0.37	130		3.2	437	40000	YK97R57	2.2	195	
	1.1	1229	27300	YK87R57	0.37	110		3.7	382	40000	YK97R57	2.2	220	
				YK87R57	0.37	120		4.1	342	40000	YK97R57	2.2	180	
	1.3	1078	27300	YK87R57	0.55	120					YK97R57	2.2	205	
	1.4	951	27300	YK87R57	0.55	130		4.6	305	40000	YK97R57	3	200	
	1.6	837	27300	YK87R57	0.55	110		5.4	258	40000	YK97R57	3	220	
				YK87R57	0.55	125		6.0	232	40000	YK97R57	3	185	
	1.9	726	27300	YK87R57	0.75	125					YK97R57	3	210	
	2.2	638	27300	YK87R57	0.75	130		7.1	199	40000	YK97R57	4	210	
				YK87R57	0.75	110					YK97R57	4	230	
				YK87R57	0.75	125					YK97R57	4	190	
	2.5	562	27300	YK87R57	1.1	130					YK97R57	4	215	
	3.0	474	27300	YK87R57	1.1	135					YK97R57	4	210	
	3.3	426	27300	YK87R57	1.1	115					YK97R57	4	230	
				YK87R57	1.1	130					YK97R57	4	190	
	3.8	373	27300	YK87R57	1.5	130					YK97R57	4	215	
	4.3	330	27300	YK87R57	1.5	140		0.12	10677	65000	YK107R77	0.12	310	
				YK87R57	1.5	120		0.14	9524	65000	YK107R77	0.12	320	
				YK87R57	1.5	130		0.16	8328	65000	YK107R77	0.12	285	
4.8	294	27300	YK87R57	2.2	135				YK107R77	0.12	305			
5.6	250	27300	YK87R57	2.2	145	0.18	7270	65000	YK107R77	0.18	310			
6.0	236	27300	YK87R57	2.2	125	0.21	6184	65000	YK107R77	0.18	325			
7.0	201	27300	YK87R57	2.2	140	0.23	5662	65000	YK107R77	0.18	280			
									YK107R77	0.18	305			
4300	0.08	18091	40000	YK97R57	0.12	180	0.27	5138	65000	YK107R77	0.25	285		
	0.08	16666	40000	YK97R57	0.12	200	0.32	4359	65000	YK107R77	0.25	310		
	0.09	14897	40000	YK97R57	0.12	160	0.36	3810	65000	YK107R77	0.25	285		
	0.10	13182	40000	YK97R57	0.12	185				YK107R77	0.25	305		
	0.12	11677	40000	YK97R57			0.41	3358	65000	YK107R77	0.37	315		
	0.13	10317	40000				0.46	2977	65000	YK107R77	0.37	325		
	0.15	9083	40000				0.52	2599	65000	YK107R77	0.37	285		
	0.17	8054	40000						YK107R77	0.37	310			
	0.20	6970	40000				0.60	2286	65000	YK107R77	0.37	315		
							0.71	1939	65000	YK107R77	0.37	325		
	0.22	6027	40000	YK97R57	0.18	180				YK107R77	0.37	285		
	0.24	5391	40000	YK97R57	0.18	200				YK107R77	0.37	310		
	0.28	4669	40000	YK97R57	0.18	160				YK107R77	0.37	285		
	0.32	4082	40000	YK97R57	0.18	185				YK107R77	0.37	310		

输出转矩 output torque Ma N.m	输出转速 output speed na r/min	传动比 Ratio i	径向载荷 Permissible overhung load outsidside Fa N	机型号 Type	功率 Power kw/Ip	重量 weight kg	输出转矩 output torque Ma N.m	输出转速 output speed na r/min	传动比 Ratio i	径向载荷 Permissible overhung load outsidside Fa N	机型号 Type	功率 Power kw/Ip	重量 weight kg						
8000	0.82	1713	65000	YYK107R77	1.1	320	13000	0.08	17550	79200	YYK127R77	0.18	470						
	0.90	1554	65000	YKF107K77	1.1	330		0.08	16006	79200	YKF127K77	0.18	510						
	1.0	1336	65000	YKA107K77	1.1	290		0.09	14975	79200	YKA127K77	0.18	440	0.11	12440	79200	YKAF127R77	0.18	480
				YKAF107R77	1.1	315		0.12	10915	79200	YKAF127R77	0.25	470						
	1.2	1166	65000	YKA2107R77	1.5	320		0.13	9819	79200	YKA2127R77	0.25	480	0.16	8443	79200	YK127R77	0.37	470
				YK107R77	1.5	330		0.16	7482	79200	YK127K77	0.37	510						
	1.4	1030	65000	YKF107K77	1.5	290		0.18	6565	79200	YKF127K77	0.37	445	0.21	6565	79200	YKA127K77	0.37	480
				YKAF107R77	1.5	315		0.23	5804	79200	YKAF127R77	0.55	475						
	1.6	904	65000	YKA2107R77	2.2	325		0.27	5027	79200	YKA2127R77	0.55	520	0.31	4423	79200	YK127K77	0.55	445
				YK107R77	2.2	340		0.35	3889	79200	YK127R77	0.55	480						
	1.8	793	65000	YKF107K77	2.2	300		0.42	3311	79200	YKAF127R77	0.75	475	0.46	3009	79200	YK127R77	0.75	475
				YKAF107R77	2.2	325					0.75	445	0.75				485		
	2.0	696	65000	YKA107K77	2.2	340		0.54	2607	79200	YKA2127R77	1.1	480	0.62	2268	79200	YK127R77	1.1	520
				YKAF107R77	2.2	330					1.1	450	1.1				490		
	2.3	615	65000	YKA2107R77	2.2	325		0.54	1926	79200	YK127R77	1.5	480	0.73	1926	79200	YKAF127R77	1.5	490
				YK107R77	2.2	325					1.5	480	1.5				480		
	2.7	522	65000	YKF107K77	3	330		0.80	1757	79200	YKAF127R77	1.5	520	0.80	1757	79200	YK127R77	1.5	490
				YKAF107R77	3	340					1.5	450	1.5				490		
	3.0	461	65000	YKA107K77	3	305		0.91	1541	79200	YKA2127R77	2.2	485	1.0	1342	79200	YK127R77	2.2	485
				YKAF107R77	3	325					2.2	485	2.2				485		
3.5	408	65000	YKA2107R77	3	325	1.0	899	79200	YK127R77	2.2	485	1.2	1177	79200	YKAF127R77	2.2	530		
			YK107R77	3	335				2.2	460	2.2				495				
3.9	364	65000	YKF107K77	4	350	1.2	790	79200	YKA127K77	3	530	1.4	1025	79200	YKAF127R77	3	490		
			YKAF107R77	4	310				3	465	3				490				
4.5	318	65000	YKA2107R77	4	335	1.6	899	79200	YKA2127R77	3	490	1.6	899	79200	YK127R77	3	490		
			YK107R77	4	335				3	465	3				530				
5.0	286	65000	YKF107K77	5.5	345	1.8	790	79200	YKAF127R77	3	465	1.8	790	79200	YK127K77	3	530		
			YKAF107R77	5.5	340				3	465	3				465				
5.7	251	65000	YKA107K77	5.5	315	2.0	704	79200	YKA2127R77	3	500	2.0	704	79200	YKAF127R77	3	465		
			YKAF107R77	5.5	340				3	500	3				465				
13000	0.08	17550	79200	YYK127R77	0.18	470	0.08	17550	79200	YYK127R77	0.18	470	0.08	17550	79200	YYK127R77	0.18	470	
	0.08	16006	79200	YKF127K77	0.18	510	0.08	16006	79200	YKF127K77	0.18	510	0.08	16006	79200	YKF127K77	0.18	510	
	0.09	14975	79200	YKA127K77	0.18	440	0.09	14975	79200	YKA127K77	0.18	440	0.09	14975	79200	YKA127K77	0.18	440	
	0.11	12440	79200	YKAF127R77	0.18	480	0.11	12440	79200	YKAF127R77	0.18	480	0.11	12440	79200	YKAF127R77	0.18	480	
	0.12	10915	79200	YK127R77	0.25	470	0.12	10915	79200	YK127R77	0.25	470	0.12	10915	79200	YK127R77	0.25	470	
	0.13	9819	79200	YKF127K77	0.25	510	0.13	9819	79200	YKF127K77	0.25	510	0.13	9819	79200	YKF127K77	0.25	510	
	0.16	8443	79200	YKA127K77	0.25	440	0.16	8443	79200	YKA127K77	0.25	440	0.16	8443	79200	YKAF127R77	0.25	480	
				YKAF127R77	0.25	480				0.25	480	0.25				480			
	0.18	7482	79200	YK127R77	0.37	470	0.18	7482	79200	YK127K77	0.37	510	0.18	7482	79200	YK127R77	0.37	470	
				YK127K77	0.37	510				0.37	445	0.37				480			
	0.21	6565	79200	YKA127K77	0.37	445	0.21	6565	79200	YKA127K77	0.37	445	0.21	6565	79200	YKAF127R77	0.37	480	
				YKAF127R77	0.37	480				0.37	480	0.37				480			
	0.23	5804	79200	YKA2127R77	0.55	475	0.23	5804	79200	YKA2127R77	0.55	475	0.23	5804	79200	YK127R77	0.55	475	
				YK127R77	0.55	475				0.55	520	0.55				520			
	0.27	5027	79200	YKF127K77	0.55	520	0.27	5027	79200	YKF127K77	0.55	520	0.27	5027	79200	YKAF127R77	0.55	445	
				YKAF127R77	0.55	445				0.55	445	0.55				445			
	0.31	4423	79200	YKA127K77	0.55	445	0.31	4423	79200	YKA127K77	0.55	445	0.31	4423	79200	YKAF127R77	0.55	480	
				YKAF127R77	0.55	480				0.55	480	0.55				480			
	0.35	3889	79200	YKA2127R77	0.55	480	0.35	3889	79200	YKA2127R77	0.55	480	0.35	3889	79200	YK127R77	0.55	480	
				YK127R77	0.55	480				0.55	480	0.55				480			
0.42	3311	79200	YK127R77	0.75	475	0.42	3311	79200	YK127R77	0.75	475	0.42	3311	79200	YK127R77	0.75	475		
			YK127K77	0.75	520				0.75	520	0.75				520				
0.46	3009	79200	YKA127K77	0.75	445	0.46	3009	79200	YKA127K77	0.75	445	0.46	3009	79200	YKAF127R77	0.75	485		
			YKAF127R77	0.75	485				0.75	485	0.75				485				
0.54	2607	79200	YKA2127R77	1.1	480	0.54	2607	79200	YKA2127R77	1.1	480	0.54	2607	79200	YK127R77	1.1	480		
			YK127R77	1.1	480				1.1	480	1.1				480				
0.62	2268	79200	YK127R77	1.1	520	0.62	2268	79200	YK127K77	1.1	520	0.62	2268	79200	YKAF127R77	1.1	450		
			YKAF127R77	1.1	450				1.1	490	1.1				490				
0.73	1926	79200	YKA127K77	1.1	450	0.73	1926	79200	YKA127K77	1.1	450	0.73	1926	79200	YKAF127R77	1.1	490		
			YKAF127R77	1.1	490				1.1	490	1.1				490				
0.80	1757	79200	YK127R77	1.5	480	0.80	1757	79200	YK127R77	1.5	480	0.80	1757	79200	YK127R77	1.5	480		
			YK127K77	1.5	520				1.5	520	1.5				520				
0.91	1541	79200	YKAF127R77	1.5	450	0.91	1541	79200	YKAF127R77	1.5	450	0.91	1541	79200	YKAF127R77	1.5	490		
			YKAF127R77	1.5	490				1.5	490	1.5				490				
1.0	1342	79200	YK127R77	2.2	485	1.0	1342	79200	YK127R77	2.2	485	1.0	1342	79200	YK127R77	2.2	485		
			YK127K77	2.2	530				2.2	530	2.2				530				
1.2	1177	79200	YKAF127R77	2.2	460	1.2	1177	79200	YKAF127R77	2.2	460	1.2	1177	79200	YK127R77	2.2	460		
			YK127R77	2.2	495				2.2	495	2.2				495				
1.4	1025	79200	YK127R77	3	490	1.4	1025	79200	YK127R77	3	490	1.4	1025	79200	YK127R77	3	490		
			YK127K77	3	530				3	530	3				530				
1.6	899	79200	YKF127K77	3	490	1.6	899	79200	YKF127K77	3	490	1.6	899	79200	YKAF127R77	3	490		
			YKAF127R77	3	490				3	490	3				490				
1.8	790	79200	YKA127K77	3	530	1.8	790	79200	YKA127K77	3	530	1.8	790	79200	YK127R77	3	530		
			YK127R77	3	465				3	465	3				465				
2.0	704	79200	YKAF127R77	3	465	2.0	704	79200	YKAF127R77	3	465	2.0	704	79200	YKAF127R77	3	465		
			YKAF127R77	3	500				3	500	3				500				
2.3	610	79200	YYK127R77	4	495	2.3	610	79200	YYK127R77	4	495	2.3	610	79200	YYK127R77	4	495		
			YKF12																

输出转矩 output torque Ma N.m	输出转速 output speed na r/min	传动比 Ratio i	径向载荷 Permissible overhung load outputside Fa N	机型号 Type	功率 Power kw/hp	重量 weight kg	输出转矩 output torque Ma N.m	输出转速 output speed na r/min	传动比 Ratio i	径向载荷 Permissible overhung load outputside Fa N	机型号 Type	功率 Power kw/hp	重量 weight kg			
18000	2.8	504	112200	YK157R97	7.5	840	32000	6.9	213	150000	YK167R107	30	1450			
	3.3	434	112200	YK157R97	7.5	920		7.1	206	150000						
	3.8	379	112200	YK157R97	7.5	800		8.1	180	150000	YK167R107	30	1450			
	4.3	333	112200	YK2157R97	7.5	860										
									9.2	160	150000	YK187R97	37	1500		
	4.9	291	112200	YK157R97	11	850							YK187R97	37	1500	
					YK157R97	11		930								
					YK157R97	11		820	11	135	150000	YK187R97	45	1530		
					YK2157R97	11		870	12	118	150000					
	4.8	299	112200	YK157R97	11	900		50000					YK187R97	45	1530	
					YK157R97	11			980	0.04	32625	189900	YK187R97	0.55	1760	
					YK157R97	11			860	0.05	27165	189900				
				YK2157R97	11	920	0.06		24353	189900	YK187R97	0.55	1760			
5.8	253	112200	YK157R97	15	940		0.07		19144	189900						
6.3	230	112200	YK157R97	15	1020		0.08		16978	189900						
6.9	213	112200	YK157R97	15	900											
				YK2157R97	15	960	0.10		14272	189900	YK187R97	0.75	1770			
32000	0.07	19723	150000	YK167R97	0.55	1180	0.11		13116	189900						
	0.08	17406	150000				0.12		11647	189900	YK187R97	0.75	1770			
	0.09	15000	150000	YK167R97	0.55	1180										
	0.10	13238	150000				0.13		10413	189900	YK187R97	1.1	1770			
	0.12	11573	150000				0.15	9363	189900							
	0.13	10264	150000				0.17	8126	189900	YK187R97	1.1	1770				
	0.16	8628	150000	YK167R97	0.75	1180	0.19	7343	189900	YK187R97	1.5	1770				
								0.21	6747	189900						
					YK167R97	0.75	1180	0.24	5991	189900	YK187R97	1.5	1770			
	0.21	8562	150000	YK167R97	1.1	1190	0.26	5358	189900	YK187R97	2.2	1780				
	0.26	5355	150000				0.29	4817	189900							
					YK167R97	1.1	1190	0.32	4370	189900	YK187R97	2.2	1780			
	0.29	4788	150000	YK167R97	1.5	1190	0.39	3609	189900	YK187R97	3	1780				
	0.35	4079	150000				0.46	3062	189900							
					YK167R97	1.5	1190				YK187R97	3	1780			
								0.56	2519	189900	YK187R97	4	1790			
					YK167R97	1.5	1190	0.63	2268	189900						
								0.69	2054	189900	YK187R97	4	1790			
	0.42	3376	150000	YK167R97	2.2	1200										
	0.51	2755	150000					0.79	1821	189900	YK187R97	5.5	1790			
					YK167R97	2.2	1200	0.87	1605	189900						
											YK187R97	5.5	1790			
	0.62	2263	150000	YK167R97	3	1200		1.0	1395	189900	YK187R97	7.5	1810			
	0.64	2182	150000					1.2	1196	189900						
					YK167R97	3	1200				YK187R97	7.5	1810			
	0.83	1704	150000	YK167R97	4	1210		2.0	738	189900	YK187R97	15	1870			
	1.0	1408	150000					2.3	621	189900						
					YK167R97	4	1210				YK187R97	15	1870			
	1.1	1296	150000	YK167R97	5.5	1210		2.8	527	189900	YK187R97	18.5	1920			
	1.3	1101	150000								YK187R97	18.5	1920			
					YK167R97	5.5	1210									
							1.7	835	189900	YK187R97	11	1870				
1.5	944	150000	YK167R97	7.5	1230											
1.7	843	150000								YK187R97	11	1870				
1.9	757	150000	YK167R97	7.5	1230											
							2.0	729	189900	YK187R97	15	1920				
2.6	561	150000	YK167R97	11	1250		2.3	622	189900							
3.0	481	150000								YK187R97	15	1920				
				YK167R97	11	1250										
							2.8	520	189900	YK187R97	18.5	1970				
							3.2	454	189900							
3.5	423	150000	YK167R97	15	1290					YK187R97	18.5	1970				
4.0	369	150000														
				YK167R97	15	1290				YK187R97	30	2030				
							4.1	355	189900							
4.6	318	150000	YK167R107	18.5	1380					YK187R97	30	2030				
				YK167R107	18.5	1380				YK187R97	37	2080				
							5.6	261	189900	YK187R97	37	2080				
5.3	278	150000	YK167R107	22	1400					YK187R97	45	2110				
6.0	244	150000					6.6	221	189900							
				YK167R107	22	1400	7.6	193	189900	YK187R97	45	2110				
							9.0	163	189900	YK187R97	45	2110				

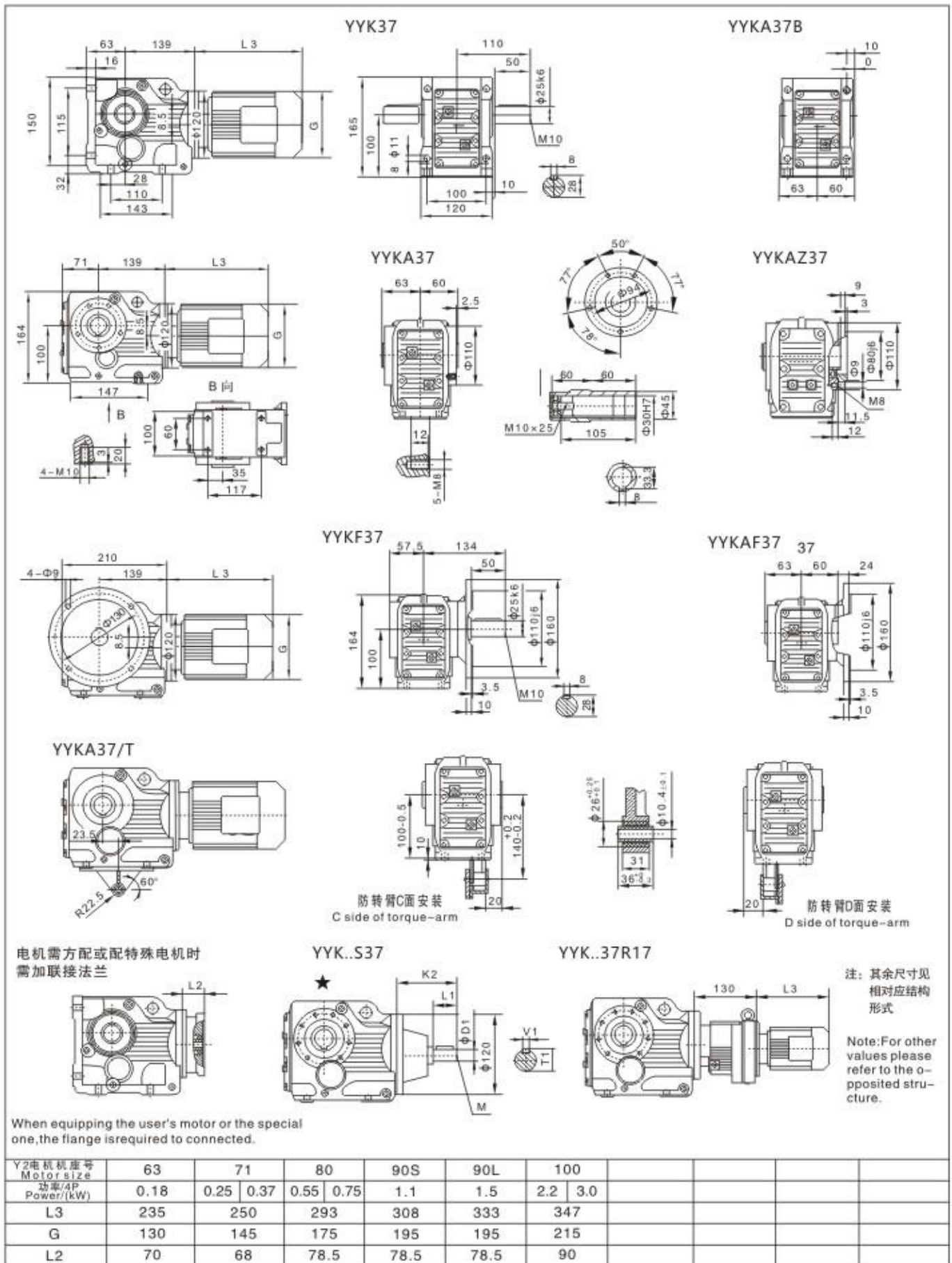

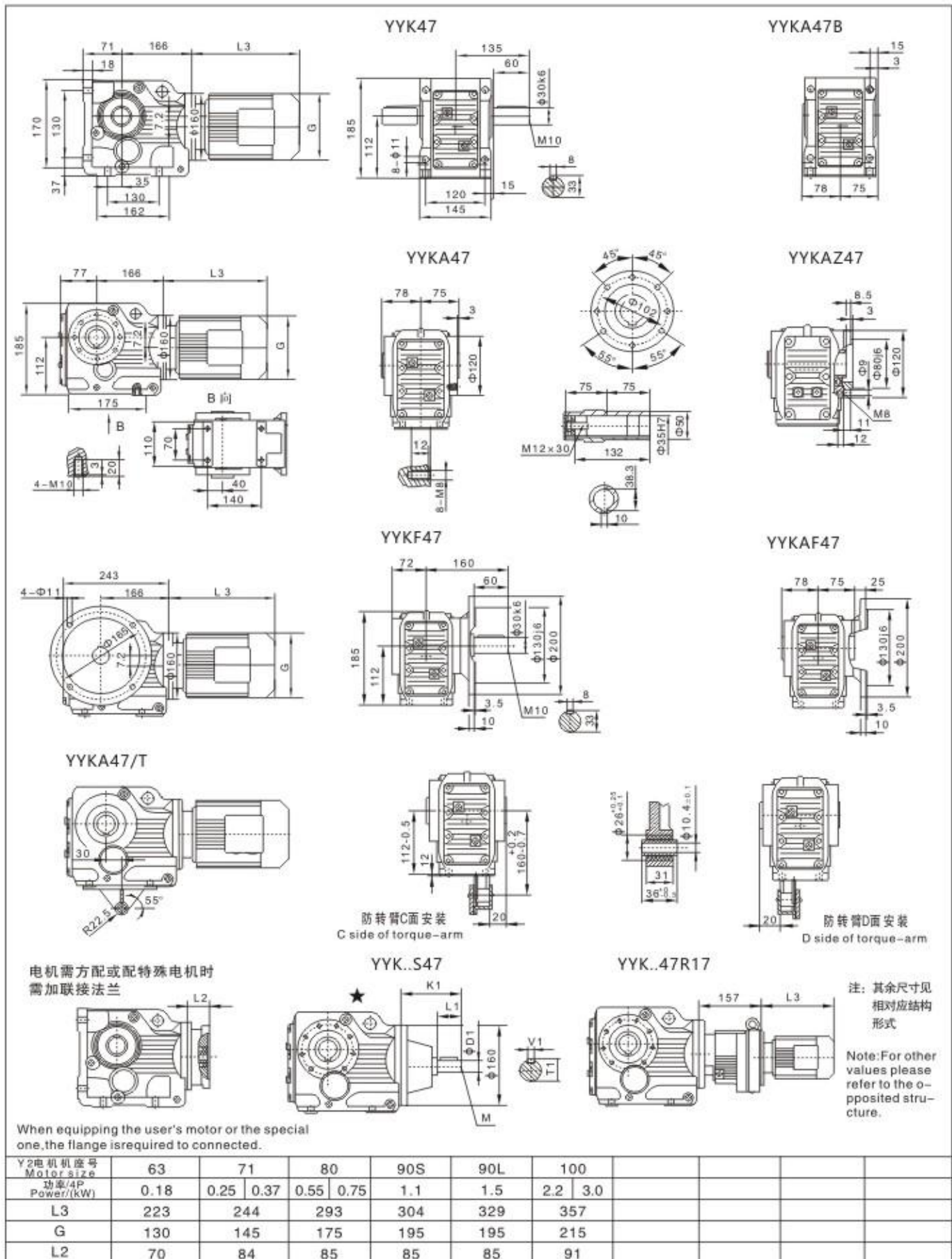

注: 1. YYKA, YYKF, YYKAF, YYKAZ壳体为通用件, 安装尺寸均可相互参照。 2. "YYK.."表示 YYK, YYKA, YYKF, YYKAF, YYKAZ, YYKAB。
Note: 1. The housings of YYKA, YYKF, YYKAF, YYKAZ are common parts. The mounting dimensions may consult each other.
2. "YYK.." mean YYK, YYKA, YYKF, YYKAF, YYKAZ, YYKAB.

★查表: 15 Seetable: 15 查表15: i=9-132查AD2 i=5.8-9查AD3

YYK57

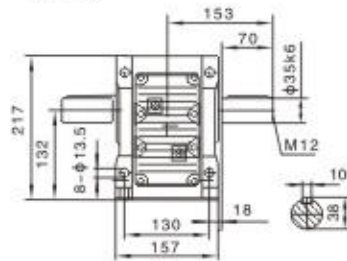
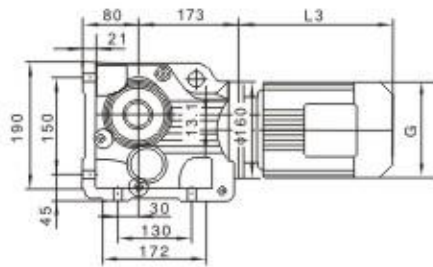

YYKA57B

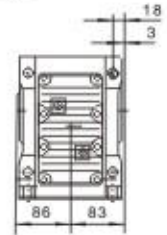

YYKA57

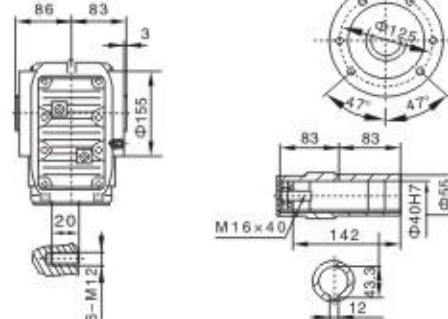
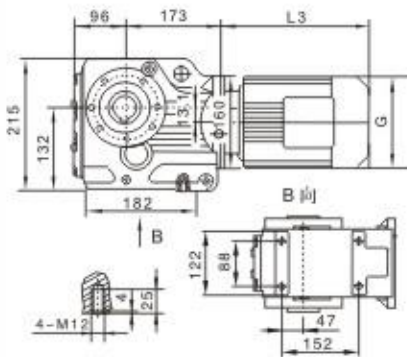

YYKAZ57

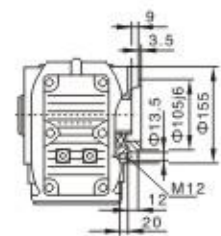

YYKF57

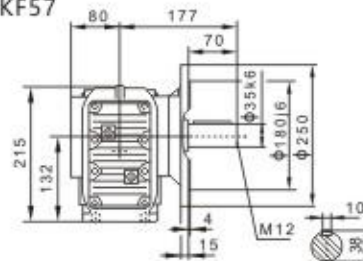
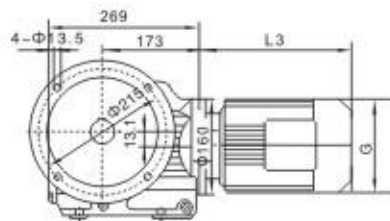

YYKAF57

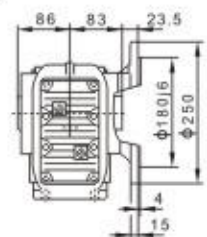

YYKA57/T

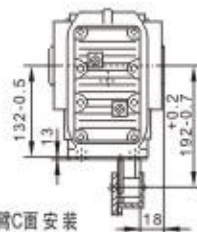
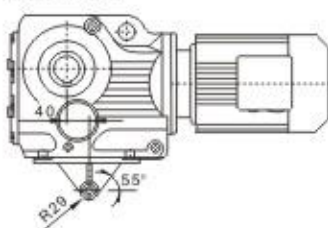

防转臂C面安装
C side of torque-arm

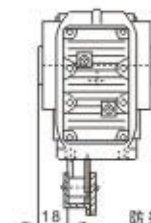
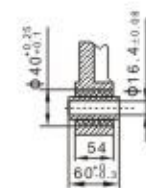

防转臂D面安装
D side of torque-arm

电机需方配或配特殊电机时需加联接法兰

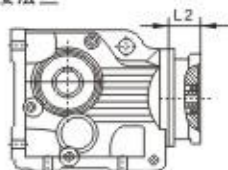

YYK..S57

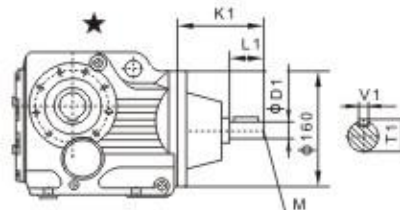

YYK..57R37

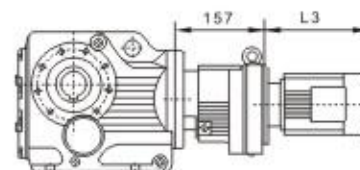

注: 其余尺寸见相对应结构形式

Note: For other values please refer to the opposed structure.

When equipping the user's motor or the special one, the flange is required to be connected.

Y2电机型号 Motor size	63	71	80	90S	90L	100	112M	132S		
功率/4P Power/(kW)	0.18	0.25 0.37	0.55 0.75	1.1	1.5	2.2 3.0	4.0	5.5		
L3	223	244	293	304	329	357	383	428		
G	130	145	175	195	195	215	240	275		
L2	70	84	85	85	85	91	91	112		

注: 1. YYKA, YYKF, YYKAF, YYKAZ壳体为通用件安装尺寸均可相互参照。 2. "YYK.."表示YYK, YYKA, YYKF, YYKAF, YYKAZ, YYKAB。
Note: 1. The housings of YYKA, YYKF, YYKAF, YYKAZ are common parts. The mounting dimensions may consult each other.
2. "YYK.." mean YYK, YYKA, YYKF, YYKAF, YYKAZ, YYKAB.

★查表: 15 Seetable: 15 查表15: i=16-145.2套AD2 i=6.5-16套AD3

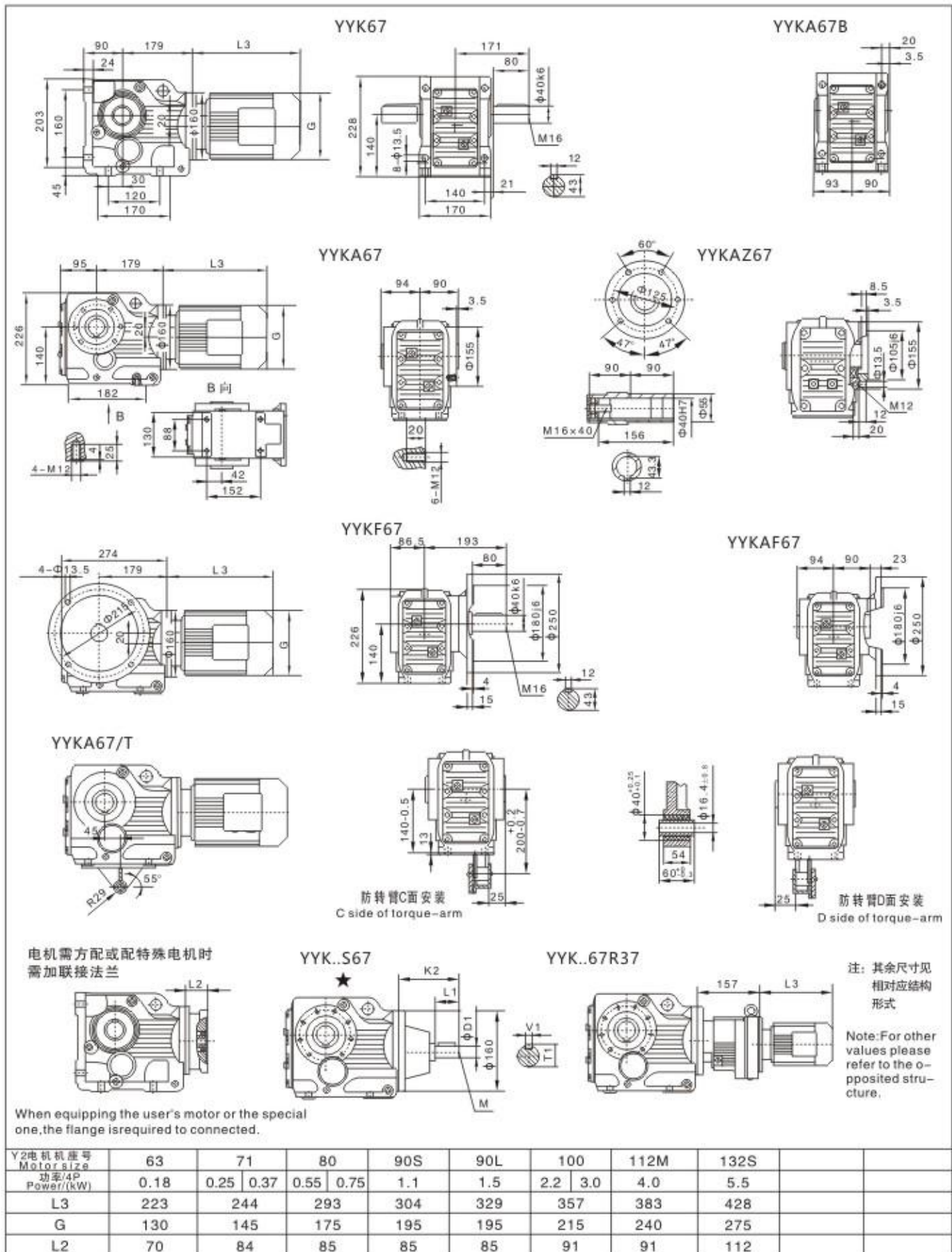

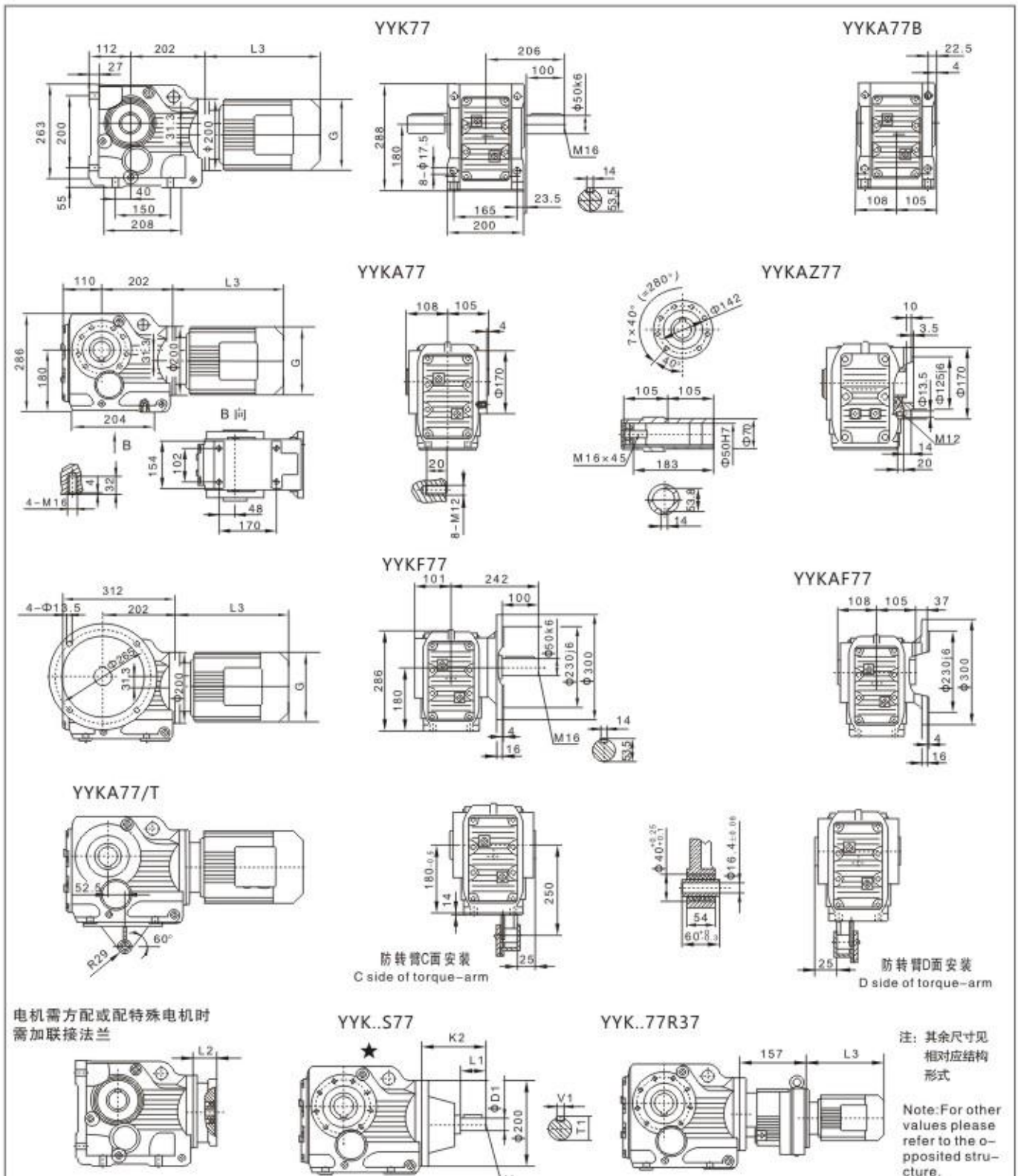

When equipping the user's motor or the special one, the flange is required to be connected.

Y2电机机座号 Motor size	71	80	90S	90L	100	112M	132S	132M	160M
功率/4P Power/(kW)	0.37	0.55 0.75	1.1	1.5	2.2 3.0	4.0	5.5	7.5	11
L3	237	292	297	322	354	391	430	463	555
G	145	175	195	195	215	240	275	275	330
L2	84	95	95	95	95	95	117	117	155

注: 1. YYKA, YYKF, YYKAF, YYKAZ壳体为通用件安装尺寸均可相互参照。 2. *YYK..*表示YYK, YYKA, YYKF, YYKAF, YYKAZ, YYKAB。
Note: 1. The housings of YYKA, YYKF, YYKAF, YYKAZ are common parts. The mounting dimensions may consult each other.
2. *YYK..* mean YYK, YYKA, YYKF, YYKAF, YYKAZ, YYKAB.

*查表: 15 Seetable: 15 查表15: l=43-192 查AD2 l=30-43 查AD3 l=7.2-30 查AD3

YYK87

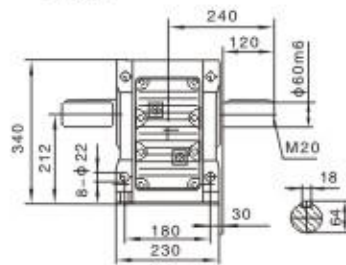
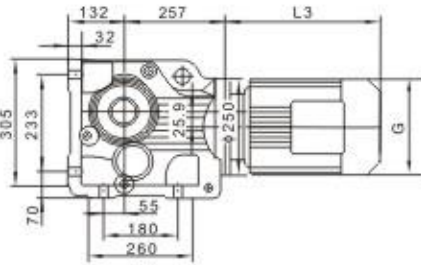

YYKA87B

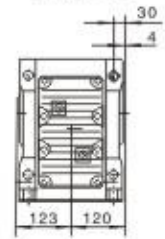

YYKA87

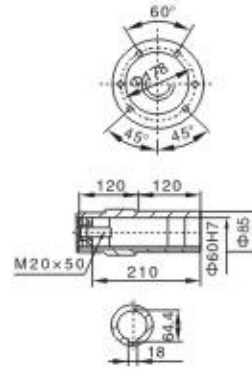
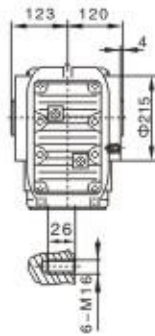
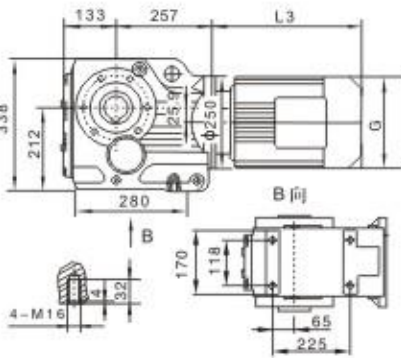

YYKAZ87

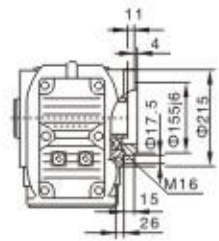

YYKF87

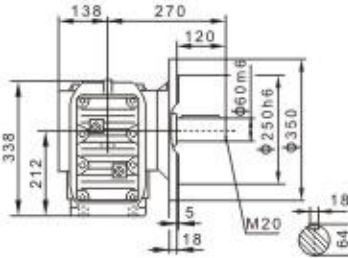
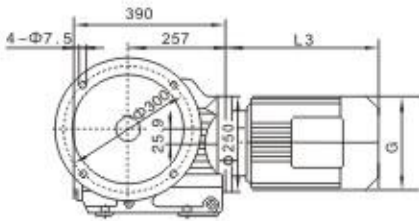

YYKAF87

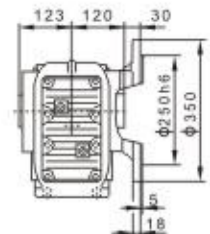

YYKA87/T

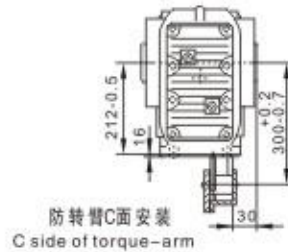
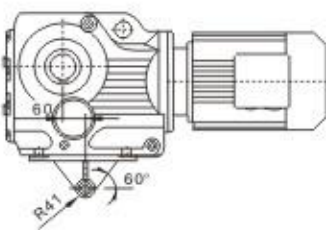

防转臂C面安装
C side of torque-arm

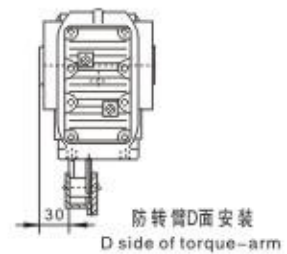

防转臂D面安装
D side of torque-arm

电机需分配或配特殊电机时需加联接法兰

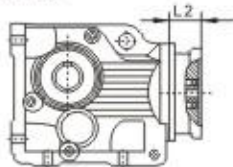

YYK..S87

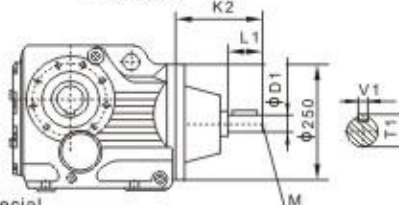

YYK..87R37

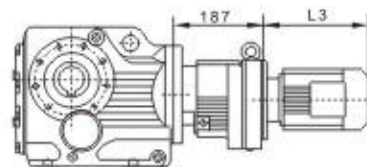

注: 其余尺寸见
相对应结构
形式

Note: For other values please refer to the opposite structure.

When equipping the user's motor or the special one, the flange is required to be connected.

Y2电机机座号 Motor size	80	90S	90L	100	112M	132S	132M	160M	160L	180M	180L
功率/4P Power/(kW)	0.75	1.1	1.5	2.2 3.0	4.0	5.5	7.5	11	15	18.5	22
L3	261	284	309	351	371	417	450	538	583	612	652
G	175	195	195	215	240	275	275	330	330	380	380
L2	95	95	95	95	95	117	117	155	155	155	155

注: 1. YYKA, YYKF, YYKAF, YYKAZ壳体为通用件, 安装尺寸均可相互参照。 2. *YYK..*表示YYK, YYKA, YYKF, YYKAF, YYKAZ, YYKAB。
Note: 1. The housings of YYKA, YYKF, YYKAF, YYKAZ are common parts. The mounting dimensions may consult each other.
2. *YYK..* mean YYK, YYKA, YYKF, YYKAF, YYKAZ, YYKAB.

*查表: 15 查表15 i=84-197.4 查AD2 i=33-84 查AD3 i=11-33 查AD4 i=7.2-11 查AD5

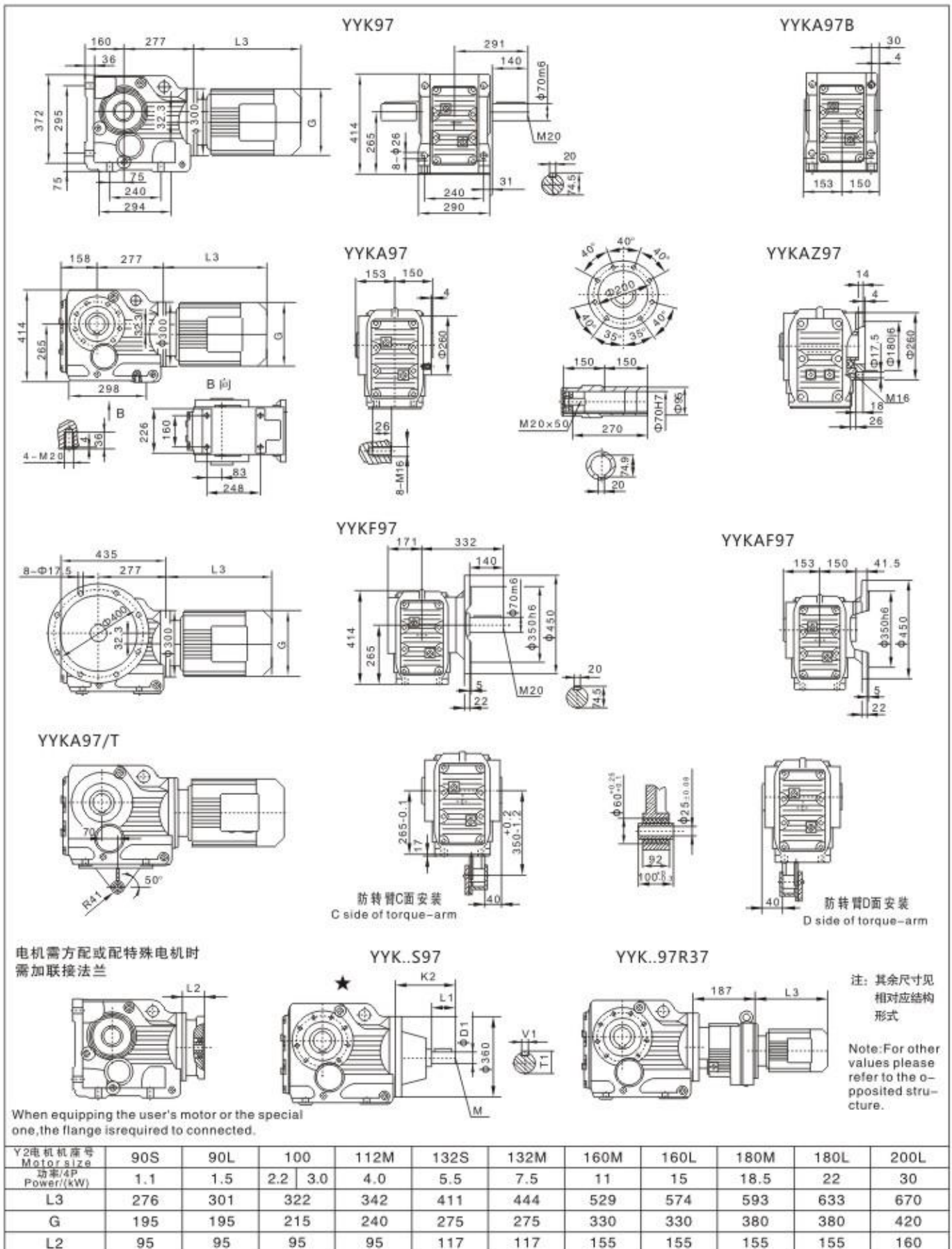

注: 其余尺寸见
相对应结构
形式
Note: For other
values please
refer to the o-
pposited stru-
cture.

YYK107

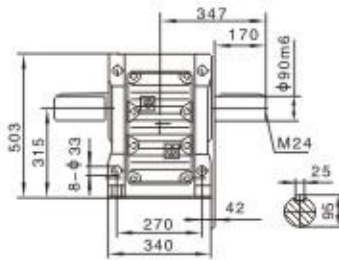
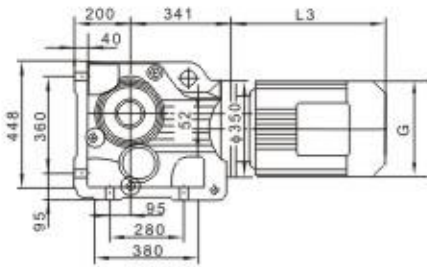

YYKA107B

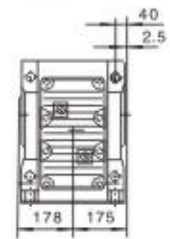

YYKA107

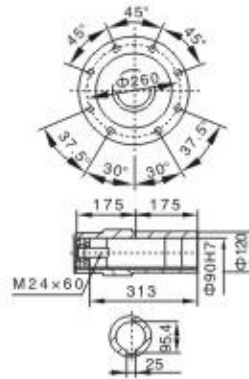
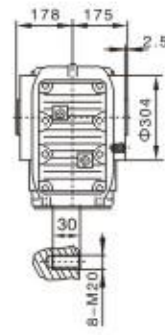
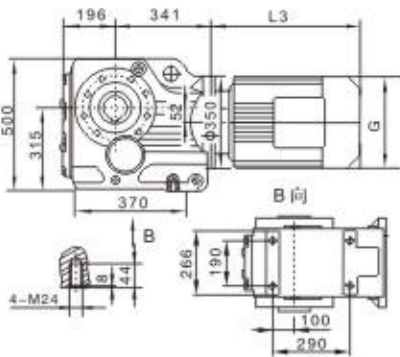

YYKAZ107

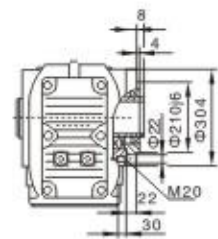

YYKF107

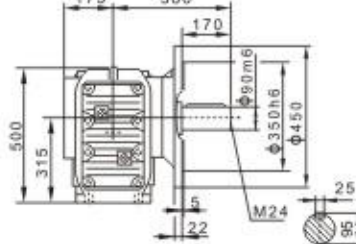
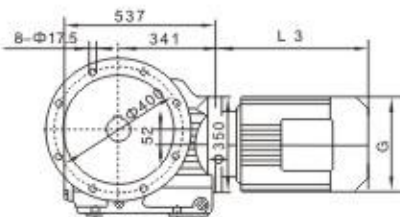

YYKAF107

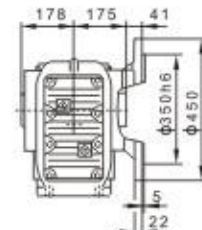

YYKA107/T

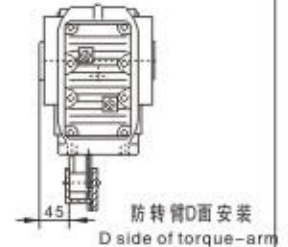
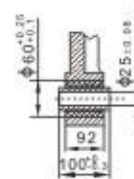
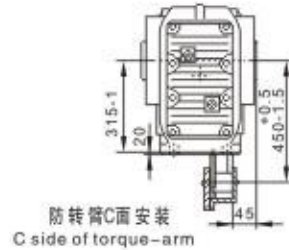
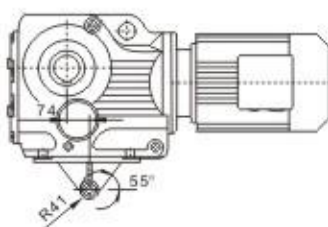

电机需方配或配特殊电机时需加联接法兰

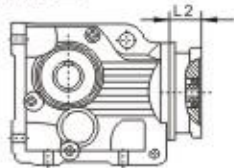

YYK..S107

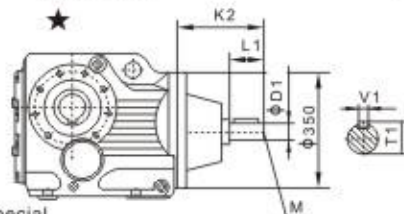

YYK..107R37

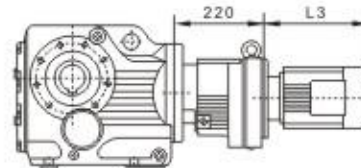

注: 其余尺寸见
相对应结构
形式

Note: For other values please refer to the opposite structure.

When equipping the user's motor or the special one, the flange is required to be connected.

Y2电机机座号 Motor size	100	112M	132S	132M	160M	160L	180M	180L	200L	225S	225M
功率/4P Power/(kW)	3.0	4.0	5.5	7.5	11	15	18.5	22	30	37	45
L3	325	342	397	430	518	563	593	632	670	684	709
G	215	240	275	275	330	330	380	380	420	470	470
L2	95	95	117	117	155	155	155	155	160	190	190

注: 1. YYKA、YYKF、YYKAF、YYKAZ壳体为通用件安装尺寸均可相互参照。 2. *YYK..*表示YYK、YYKA、YYKF、YYKAF、YYKAZ、YYKAB。
Note: 1. The housings of YYKA, YYKF, YYKAF, YYKAZ are common parts. The mounting dimensions may consult each other.
2. *YYK..* mean YYK, YYKA, YYKF, YYKAF, YYKAZ, YYKAB.

*查表: 15 Seetable: 15 查表15: i=47~143.5查AD4 i=30~47查AD5 i=8.6~30查AD6

YYK127
YYKA127

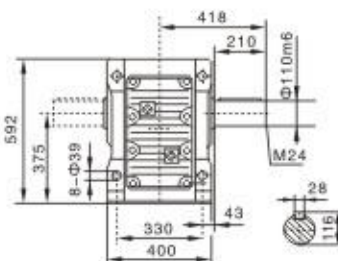
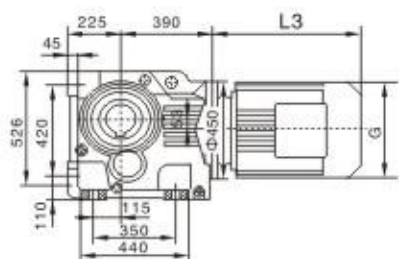

YYKA127B
YYKA127

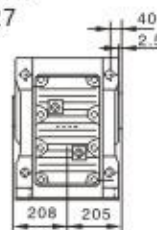

YYKAZ127

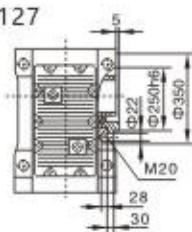

YYKA127B/YYKAZ127/YYKAF127/YYKAZ127
空心轴/Hollow shaft

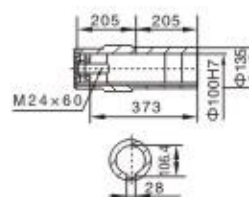
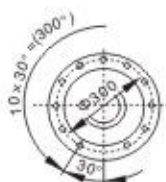

YYKF127

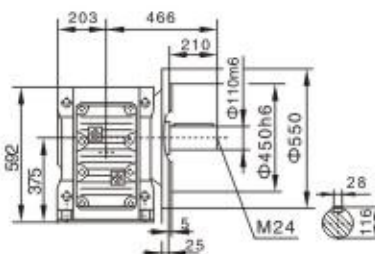
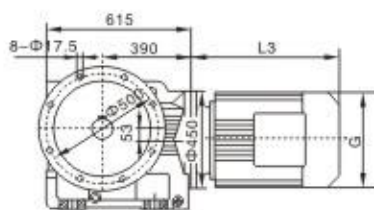

YYKAF127

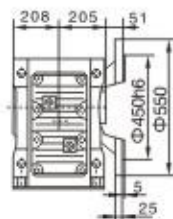

YYKA127/T

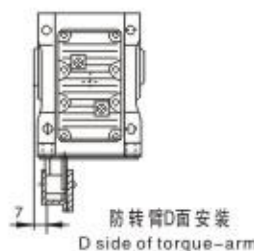
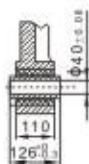
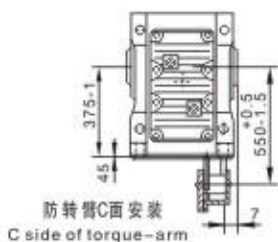
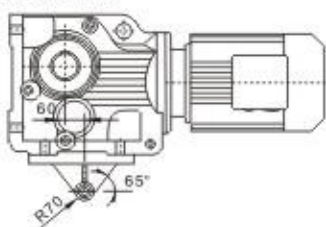

电机需方配或配特殊电机时
需加联接法兰

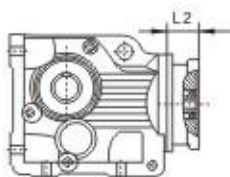

YYK..S127

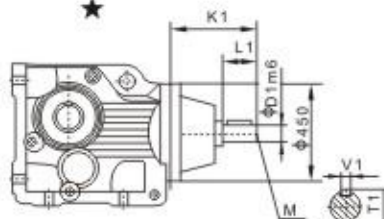

YYK..127R77(R87)

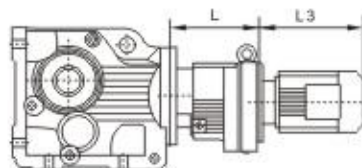

注: 其余尺寸见
相对应结构
形式

Note: For other
values please
refer to the o-
pposited struc-
ture.

When equipping the user's motor or the special one, the flange is required to be connected.

Y2电机机座号 Motor size	功率/4P Power/(kW)	L3	G	L2	YYK..127R77						YYK..127R87	
					132M	160M	160L	180M	180L	200L	L	L3
	7.5	429	275	55	225S	225M	250M	280S	280M	220	272	
	11	490	330	93	37	45	55	75	90			
	15	583	330	93	678	703	784	847	847			
	18.5	693	380	93	470	470	510	580	580			
	22	633	380	93	115	115	120	120	120			
	30	658	420	93								

注: 1. YYKA, YYKF, YYKAF, YYKAZ壳体为通用件, 安装尺寸均可相互参照。 2. *YYK..*表示 YYK, YYKA, YYKF, YYKAF, YYKAZ, YYKAB。
Note: 1. The housings of YYKA, YYKF, YYKAF, YYKAZ are common parts. The mounting dimensions may consult each other.
2. *YYK..* mean YYK, YYKA, YYKF, YYKAF, YYKAZ, YYKAB.

★查表: 15 Seetable: 15 查表15: i=105-146. 1查AD4 i=47-105查AD5 i=38-47查AD6 i=23-38查AD7 i=8.6-23查AD8

YYK167

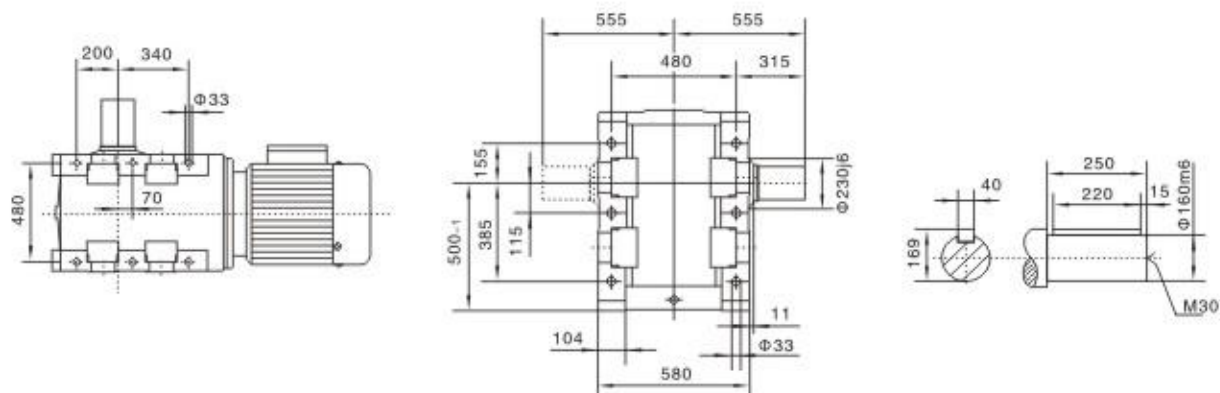

YYKA167

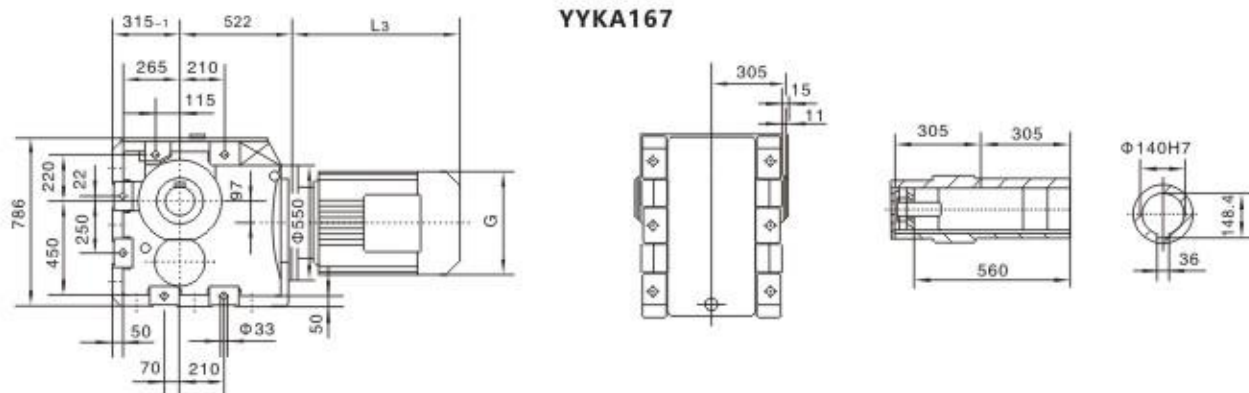

电机需方配或配特殊电机时需加联接法兰

YYK..S167

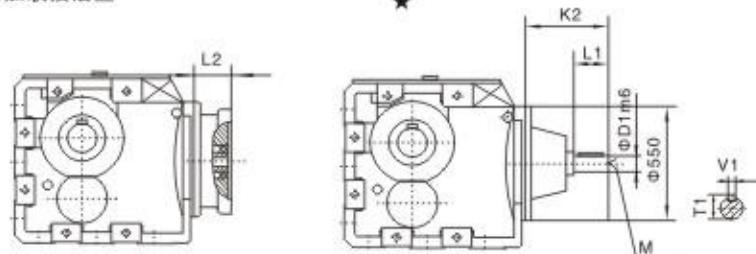

YYK..167R97(R107)

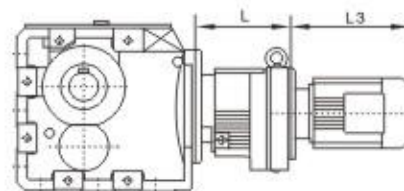

When equipping the user's motor or the special one, the flange is required to be connected.

注:其余尺寸见相对应结构形式

Note: For other values please refer to the opposited structure.

Y2电机机座号 Motor size											TK..167R97		TK..167R107	
	160M	160L	180M	180L	200L	225S	225M	250M	280S	280M	315S	315M	315L	
功率/4P Power/(kW)	11	15	18.5	22	30	37	45	55	75	90	110	132	160 200	
L_3	492	537	593	633	646	673	698	779	847	847	1100	1180	1270	
G	330	330	380	380	420	470	470	510	580	580	645	645	645	
L_2	155	155	155	155	160	190	190	190	190	190	190	190	190	

注:1. YYKA, YYKF, YYKAF, YYKAZ壳体为通用件安装尺寸均可相互参照。 2. YYK..*表示YYK, YYKA, YYKF, YYKAF, YYKAZ, YYKAB。
Note:1. The housings of YYKA, YYKF, YYKAF, YYKAZ are common parts. The mounting dimensions may consult each other.
2. YYK..* mean YYK, YYKA, YYKF, YYKAF, YYKAZ, YYKAB.

★ 查表: 15 Seetable:15 查表15: i=135-164.5查AD5 i=102-135查AD6 i=57-102查AD7 i=17.3-57查AD8

YYK187

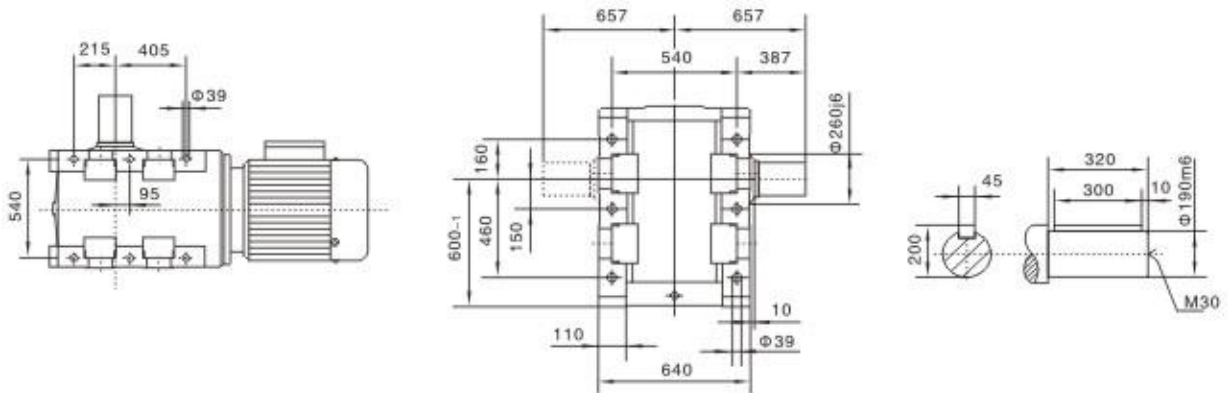

YYKA187

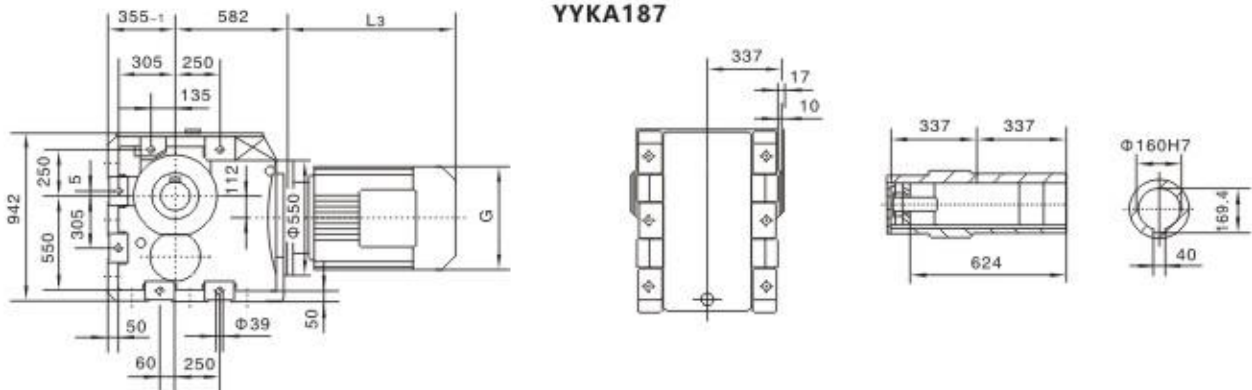

电机需方配或配特殊电机时
需加联接法兰

YYK..S187

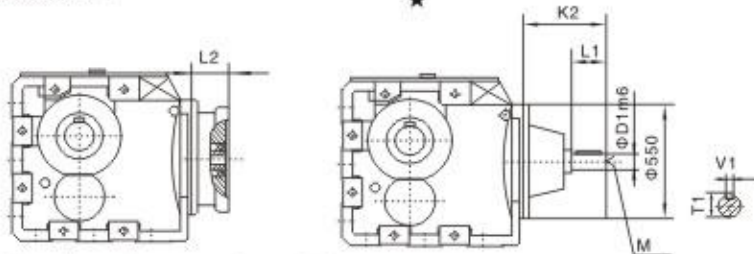

YYK..187R97(R107)

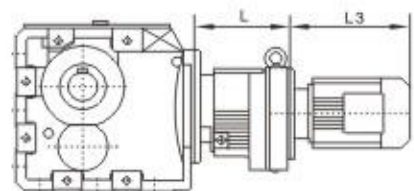

When equipping the user's motor or the special one, the flange is required to be connected.

注:其余尺寸见相对应结构形式

Note: For other values please refer to the opposited structure.

Y2电机机座号 Motor size	功率/4P Power/(kW)	L3	G	L2	TK..187TR97		TK..187TR107	
					L	320	355	
160M	11	492	330	155	280M	90	280S	75
160L	15	537	330	155	315S	110	315M	132
180M	18.5	593	380	155	315L	132	315M	132
180L	22	633	380	155	315L	160	315L	160
200L	30	646	420	160	280M	90	280S	75
225S	37	673	470	190	315S	110	315M	132
225M	45	698	470	190	315L	132	315M	132
250M	55	779	510	190	315L	160	315L	160
280S	75	847	580	190	280M	90	280S	75
280M	90	847	580	190	315S	110	315M	132
315S	110	1100	645	190	315L	132	315M	132
315M	132	1180	645	190	315L	160	315L	160
315L	160	1270	645	190	280M	90	280S	75

注:1. YYKA, YYKF, YYKAF, YYKAZ壳体为通用件安装尺寸均可相互参照。 2. 'YYK..'表示 YYK, YYKA, YYKF, YYKAF, YYKAZ, YYKAB。
Note: 1. The housings of YYKA, YYKF, YYKAF, YYKAZ are common parts. The mounting dimensions may consult each other.
2. 'YYK..' mean YYK, YYKA, YYKF, YYKAF, YYKAZ, YYKAB.

★查表: 15 Seetable: 15 查表15: i=141~179.9查AD6 i=98~141查AD7 i=17.1~98查AD8